

5" Diameter Double Shaft Fan/Blower Motors Resilient Base

Fan Coils - Dual Wheel Blower

Features

- Auto Protector
- CCWLE Rotation
- Continuous Air Over
- 3-1/2" Shaft Height
- Min. 38" leads
- Open Construction
- Resilient Base
- 60 HZ only
- Sleeve Bearing
- 1/2" Dia.- Flatted Shafts
- 40° C Ambient
- 42 Frame (5.0" Dia.)



HP	RPM/ Speeds	Volts	Amps	Stock Number	Dim. Ref.	Conn. Dia.	Notes
SHADED POLE							
1/10-1/15-1/20	1550/3	115	3.5	DBL4404	1	1	
1/10-1/15-1/20	1550/3	208-230	1.8	DB4405	2	1	
1/10-1/15-1/20-1/25	1050/4	115	3.4	DBL6406	2	2	
1/10-1/15-1/20-1/25	1050/4	208-230	1.6	DB6407	1	2	
1/10-1/15-1/20-1/25	1050/4	277	1.3	7DB6408	1	2	
1/10-1/15-1/20-1/25-1/30	1050/5	115	3.5	DBL6409	3	44	
PERMANENT SPLIT CAPACITOR - 5 MFD, 370 VAC							
1/10-1/12-1/15	1625/3	115	1.5	DBL4500	1	7	2
1/10-1/12-1/15-1/20	1075/4	115	1.7	DBL6501	2	11	2
1/10-1/15-1/20-1/25	1075/4	208-230	.8	DB6502	1	11	2
1/10-1/12-1/15-1/20-1/25	1075/5	115	1.7	DBL6539	4	43	2
1/8-1/10-1/12	1075/3	277	.8	7DB6503	1	7	2
1/6-1/8-1/10	1075/3	277	.9	7DB6504	1	7	2
1/5-1/10-1/20	1500/3	208-230	1.5	DB4505	1	7	2
1/4-1/6-1/10	1075/3	115	5.6	DBL6524	5	7	3
1/4-1/6-1/10	1075/3	208-230	2.0	DB6525	5	7	3
1/3	1625/1	208-230	2.3	OWW4517	6	89	1

Notes:

1. Requires 6MFD, 370VAC Capacitor, not included, 3.0" Shaft Height
2. Requires 5 MFD, 370VAC Capacitor, not included
3. Requires 7.5 MFD, 370VAC Capacitor, not included

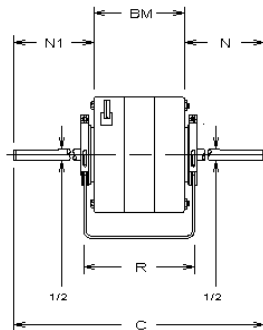

Approximate Dimensions

Ref.	BM	R	C	N1/N
1	3-3/8	4-1/8	22	9-5/16
2	3-3/8	4-1/8	24	10-5/16
3	3-3/8	4-1/16	24	10-5/16
4	3-9/16	4-5/16	24	10-3/16
5	4-1/16	4-7/8	24	10
6	4-1/16	4-13/16	18-7/16	7-3/16