

48 Frame Fan Canopy Commercial Condenser Fan

Permanent Split Capacitor & Three Phase Features:

- Double Sealed Ball Bearings
- Removable Conduit Box
- Dual Voltage
- Reversible
- Class B Insulation; 60°C Ambient
- Suitable for use with some Solid State Speed Controls
- Weather-resistant fan canopy with UV protection to prevent degrading due to sunlight
- Keeps water and dirt out while internal louvers cool motor for longer life
- High Thrust Capacity

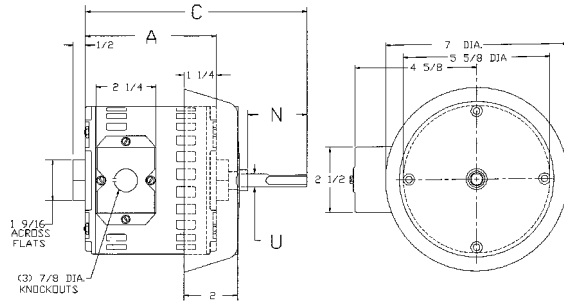

OPEN • PERMANENT SPLIT CAPACITOR • 6 POLE • BALL BEARING • REVERSIBLE • AUTOMATIC PROTECTOR

| Stock No. | Hp | RPM | Volts | Amps | Capacitor Required | Dimensions | | | | Cross Reference | Connection Dia. No.* | Notes |
|-----------|----|------|-------------|---------|--------------------|------------|-------|---|--------------------|-----------------|----------------------|-------|
| | | | | | | C | A | N | U | | | |
| 760 | .4 | 1075 | 200-230/460 | 3.0/1.5 | 5 MFD-440V | 10-1/4 | 5-3/4 | 5 | 1/2" Flatted | FC1046 | 87u | 1,2 |
| 761 | .6 | 1075 | 200-230/460 | 3.4/1.8 | 7.5 MFD-440V | 12-3/4 | 6-1/4 | 5 | 1/2" Flatted | FC1066 | 87u | 1,2 |
| 762 | .6 | 1075 | 200-230/460 | 3.4/1.8 | 7.5 MFD-440V | 12-3/4 | 6-1/4 | 5 | 5/8" Flatted & Key | FC1066A | 87u | 1 |
| 763 | .8 | 1075 | 200-230/460 | 4.8/2.4 | 20 MFD-370V | 14-1/4 | 7-3/4 | 5 | 1/2" Flatted | FC1086 | 87u | 1,2 |
| 764 | .8 | 1075 | 200-230/460 | 4.8/2.4 | 20 MFD-370V | 14-1/4 | 7-3/4 | 5 | 5/8" Flatted & Key | FC1086A | 87u | 1 |

OPEN • THREE PHASE • 6 POLE • BALL BEARING • REVERSIBLE • AUTOMATIC PROTECTOR

| Stock No. | Hp | RPM | Volts | Amps | Capacitor Required | Dimensions | | | | Cross Reference | Connection Dia. No.* | Notes |
|-----------|-----|------|-------------|---------|--------------------|------------|------|---|--------------------|-----------------|----------------------|-------|
| | | | | | | C | A | N | U | | | |
| 765 | 1/2 | 1140 | 200-230/460 | 2.3/1.2 | None | 123/4 | 61/4 | 5 | 1/2" Flatted | FC3056 | 85u | 1,2 |
| 766 | 3/4 | 1140 | 200-230/460 | 4.2/2.1 | None | 143/4 | 71/4 | 6 | 5/8" Flatted & Key | FC3076 | 85u | 1 |

Notes

1. Ball Bearings
 2. Includes split bushing and key for 5/8" shaft
- *See Pages 160-163 for Connection Diagram

48 Frame 575V Condenser Fan

Three Phase Features:

- Reversible
- Double Sealed Ball Bearings
- Water Slinger and Rain Shield Included
- Thermally Protected



| Stock No. | Hp | Volts | RPM** | Amps | Speeds | Construction | "A" | Shaft Diameter & Length | Iron Stack | Connection Diagram No.* | Notes |
|-----------|----|-------|-------|------|--------|--------------|-----|-------------------------|------------|-------------------------|-------|
| | | | | | | | | | | | |

Notes:

1. Ball Bearings
- *See Pages 160-163 for Connection Diagram