

A/B-C-D • CAST IRON SHEAVES



LEESON offers a comprehensive line of A/B-C-D pulleys for "Quick Detachable" (QD) taper bushings.

Also referred to as classical V-Belt sheaves each item is made under ISO quality assurance systems.

Features:

GG25 high performance cast iron

Precision CNC machining

Precision balancing to 06.3

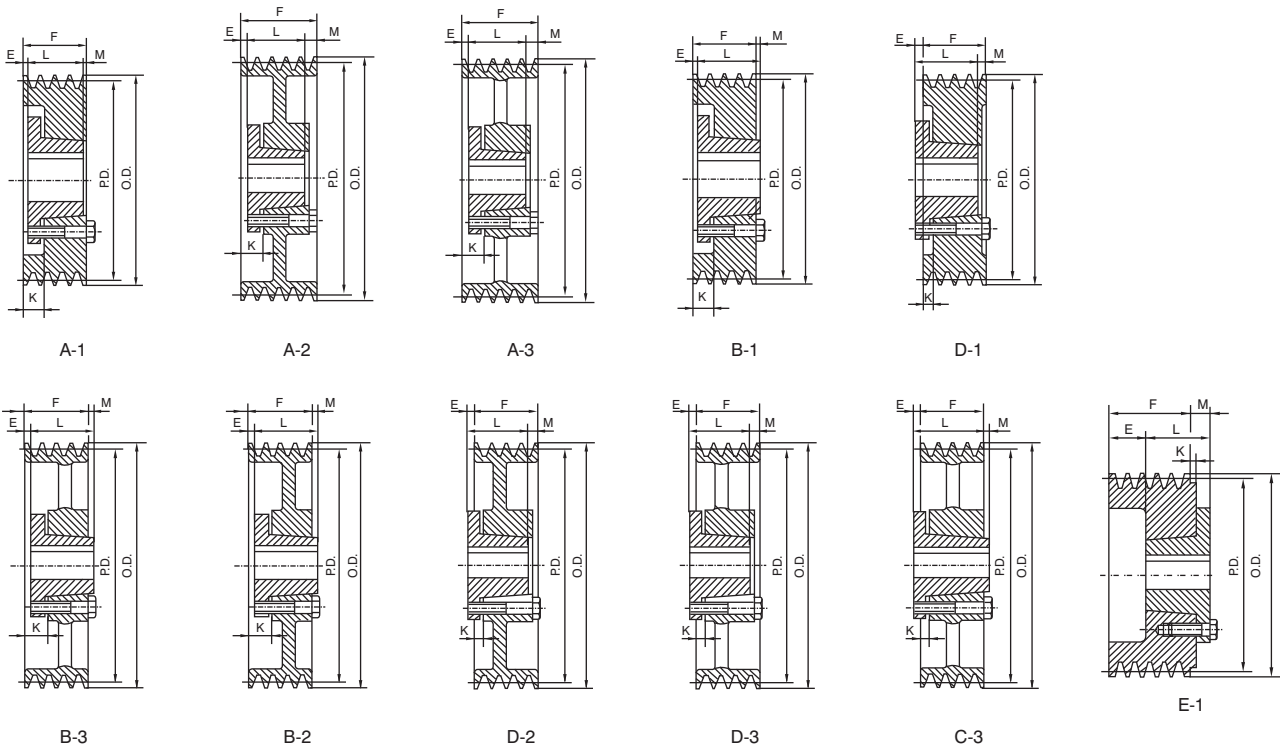

NOMENCLATURE FOR TAPER-LOCK SHEAVES FOR STANDARD NARROW V BELT

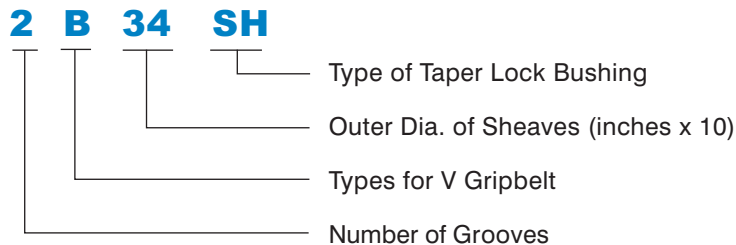

A/B-C-D

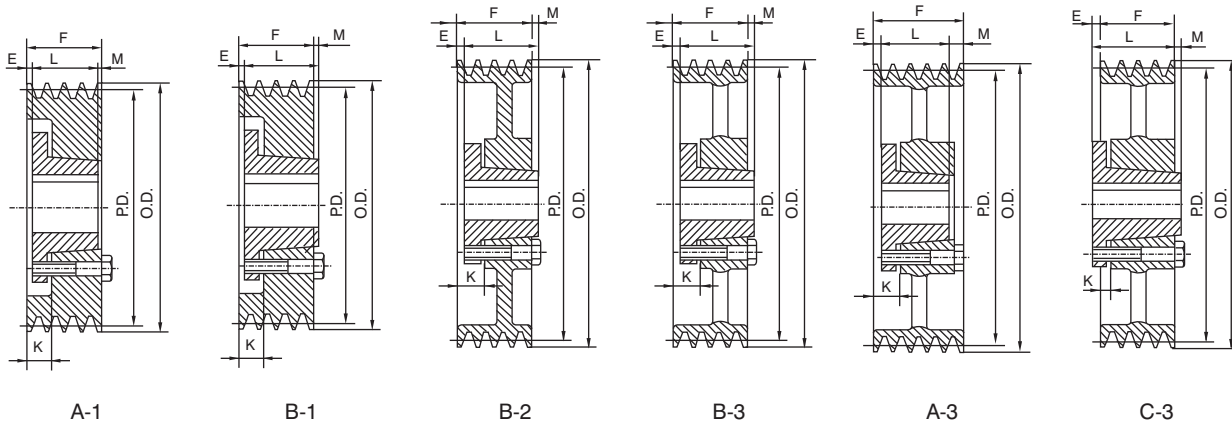

C-3

F = 3 3/8" (85.73mm)

Part No.	O.D.	PD.	Bush Max Bore	Bush	Type	Db	E	K	L	M	Wgt. Less Bush
3 C 50 SD	5.40	5.00	2	SD	A1	—	5/8	1 1/4	1 13/16	15/16	8.0
3 C 54 SD	5.80	5.40	2	SD	A1	—	11/16	1 5/16	1 13/16	7/8	9.0
3 C 55 SD	5.90	5.50	2	SD	A1	—	11/16	1 5/16	1 13/16	7/8	10
3 C 56 SD	6.00	5.60	2	SD	A1	—	11/16	1 5/16	1 13/16	7/8	11
3 C 60 SK	6.40	6.00	2 5/8	SK	A1	—	3/16	7/8	1 15/16	1 1/8	12
3 C 70 SF	7.40	7.00	2 15/16	SF	A1	—	5/8	1 5/16	2 1/16	1 11/16	14
3 C 75 SF	7.90	7.50	2 15/16	SF	A1	—	5/8	1 5/16	2 1/16	1 11/16	17
3 C 80 E	8.40	8.00	3 1/2	E	B1	—	7/8	1 3/4	2 5/8	1/8	19
3 C 85 E	8.90	8.50	3 1/2	E	B1	—	7/8	1 3/4	2 5/8	1/8	22
3 C 90 E	9.40	9.00	3 1/2	E	B1	—	7/8	1 3/4	2 5/8	1/8	26
3 C 95 E	9.90	9.50	3 1/2	E	B1	—	7/8	1 3/4	2 5/8	1/8	29
3 C 100 E	10.40	10.00	3 1/2	E	B2	6 1/4	7/8	1 3/4	2 5/8	1/8	31
3 C 105 E	10.90	10.50	3 1/2	E	B2	6 1/4	7/8	1 3/4	2 5/8	1/8	35
3 C 110 E	11.40	11.00	3 1/2	E	B2	6 1/4	7/8	1 3/4	2 5/8	1/8	38
3 C 120 E	12.40	12.00	3 1/2	E	B3	6 1/4	7/8	1 3/4	2 5/8	1/8	40
3 C 130 E	13.40	13.00	3 1/2	E	B3	6 1/4	7/8	1 3/4	2 5/8	1/8	43
3 C 140 E	14.40	14.00	3 1/2	E	B3	6 1/4	7/8	1 3/4	2 5/8	1/8	46
3 C 150 E	15.40	15.00	3 1/2	E	B3	6 1/4	7/8	1 3/4	2 5/8	1/8	52
3 C 160 E	16.40	16.00	3 1/2	E	B3	6 1/4	7/8	1 3/4	2 5/8	1/8	58
3 C 180 E	18.40	18.00	3 1/2	E	B3	6 1/4	7/8	1 3/4	2 5/8	1/8	67
3 C 200 E	20.40	20.00	3 1/2	E	A3	6 1/4	7/8	1	2 5/8	5/8	70
3 C 240 E	24.40	24.00	3 1/2	E	A3	6 1/4	7/8	1	2 5/8	5/8	90
3 C 270 F	27.40	27.00	3 15/16	F	C3	7	3/16	13/16	3 5/8	1/16	124
3 C 300 F	30.40	30.00	3 15/16	F	C3	7	3/16	13/16	3 5/8	1/16	130
3 C 360 F	36.40	36.00	3 15/16	F	C3	7	3/16	13/16	3 5/8	1/16	166
3 C 440 F	44.40	44.00	3 15/16	F	C3	7	3/16	13/16	3 5/8	1/16	208
3 C 500 F	50.40	50.00	3 15/16	F	C3	7	3/16	13/16	3 5/8	1/16	250

A/B-C-D