

A/B-C-D • CAST IRON SHEAVES



LEESON offers a comprehensive line of A/B-C-D pulleys for "Quick Detachable" (QD) taper bushings.

Also referred to as classical V-Belt sheaves each item is made under ISO quality assurance systems.

Features:

GG25 high performance cast iron

Precision CNC machining

Precision balancing to 06.3

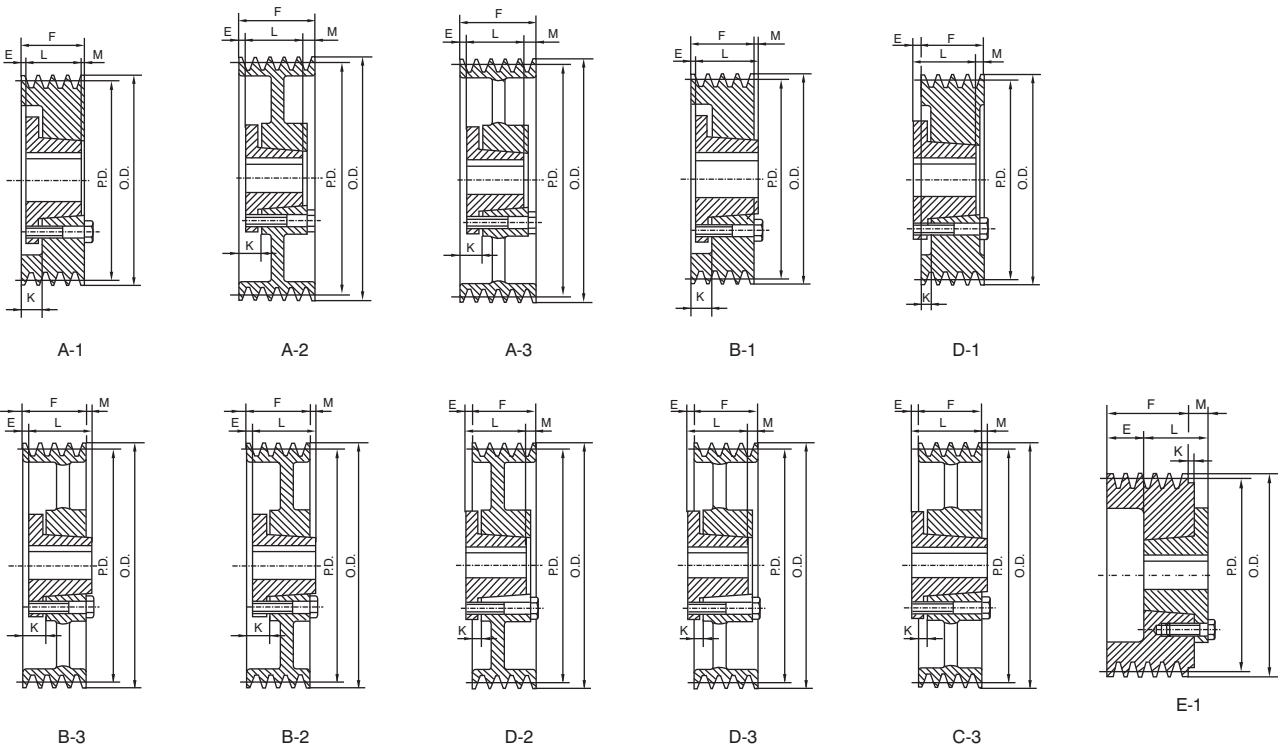

NOMENCLATURE FOR TAPER-LOCK SHEAVES FOR STANDARD NARROW V BELT

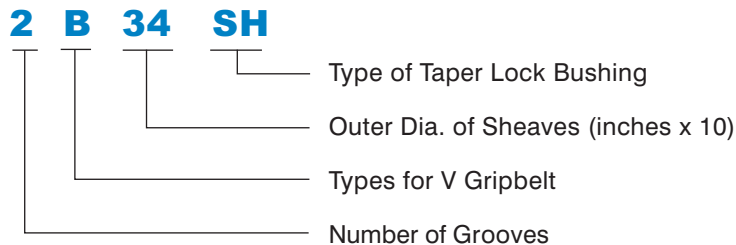

A/B-C-D

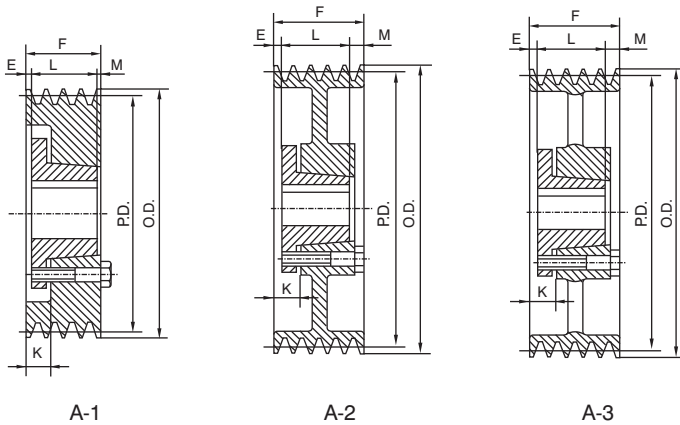

BORE RANGE FOR QTL BUSHING

Bush. Sym.	Min. Bore	Max. Bore with:		
		Full Keyway	Shallow Keyway	No Keyway
SF	1/2	2 1/4	2 7/8	2-15/16
E	7/8	2-7/8	3-1/2	—
F	1	3-1/4	3-15/16	4
J	1-1/2	3 13/16	4-1/2	—
M	2	4 11/16	5 1/2	—
N	2-7/16	5 1/16	5-7/8	—
P	2-15/16	5 13/16	7	—

D-12

F = 17 9/16" (446.09mm)

Part No.	O.D.	P.D.	Bush Max Bore	Bush	Type	Db	E	K	L	M	Wgt. Less Bush
12 D 120 M	12.60	12.00	5 1/2	M	A1	—	3 1/2	4 15/16	6 3/4	7 5/16	158
12 D 130 M	13.60	13.00	5 1/2	M	A1	—	3 1/2	4 15/16	6 3/4	7 5/16	176
12 D 135 M	14.10	13.50	5 1/2	M	A1	—	3 1/2	4 15/16	6 3/4	7 5/16	219
12 D 140 M	14.60	14.00	5 1/2	M	A1	—	3 1/2	4 15/16	6 3/4	7 5/16	242
12 D 145 M	15.10	14.50	5 1/2	M	A1	—	3 1/2	4 15/16	6 3/4	7 5/16	256
12 D 150 M	15.60	15.00	5 1/2	M	A1	—	3 1/2	4 15/16	6 3/4	7 5/16	266
12 D 155 M	16.10	15.50	5 1/2	M	A1	—	3 1/2	4 15/16	6 3/4	7 5/16	287
12 D 160 M	16.60	16.00	5 1/2	M	A1	—	3 1/2	4 15/16	6 3/4	7 5/16	308
12 D 170 M	17.60	17.00	5 1/2	M	A1	—	3 1/2	4 15/16	6 3/4	7 5/16	325
12 D 180 M	18.60	18.00	5 1/2	M	A1	—	3 1/2	4 15/16	6 3/4	7 5/16	330
12 D 200 M	20.60	20.00	5 1/2	M	A2	9 1/2	3 1/2	4 15/16	6 3/4	7 5/16	340
12 D 220 M	22.60	22.00	5 1/2	M	A2	9 1/2	2 1/2	3 15/16	6 3/4	8 5/16	355
12 D 270 N	27.60	27.00	5 1/2	N	A3	10 1/2	2 1/2	4 1/4	6 3/4	6 15/16	392
12 D 330 N	33.60	33.00	6	N	A3	10 1/2	2 1/2	4 1/4	6 3/4	6 15/16	505
12 D 400 P	40.60	40.00	6 3/4	P	A3	13	5/8	2 5/8	8 1/8	7 9/16	946
12 D 440 P	44.60	44.00	6 3/4	P	A3	13	5/8	2 5/8	8 1/8	7 9/16	1065
12 D 480 P	48.60	48.00	6 3/4	P	A3	13	5/8	2 5/8	8 1/8	7 9/16	1155
12 D 580 P	58.60	58.00	6 3/4	P	A3	13	5/8	2 5/8	8 1/8	7 9/16	1576

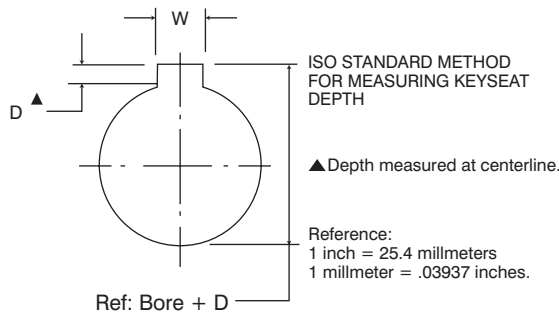

STANDARD KEYWAY & KEY DIMENSION

Bores	Key Seat	Key
1 13/16-2 1/4	1 1/2 x 1/4	1 1/2 x 1/2
2 5/16-2 3/4	5/8 x 5/16	5/8 x 5/8
2 13/16-3 1/4	3/4 x 3/8	3/4 x 3/4
3 5/16-3 3/4	7/8 x 7/16	7/8 x 7/8
3 13/16-4 1/2	1 x 1/2	1 x 1
4 9/16-5 1/2	1 1/4 x 5/8	1 1/4 x 1 1/4
5 9/16-6 1/2	1 1/2 x 3/4	1 1/2 x 1 1/2
6 9/16-7 1/2	1 3/4 x 7/8	1 3/4 x 1 3/4

Dimensions: inch