

3V-5V-8V • CAST IRON SHEAVES

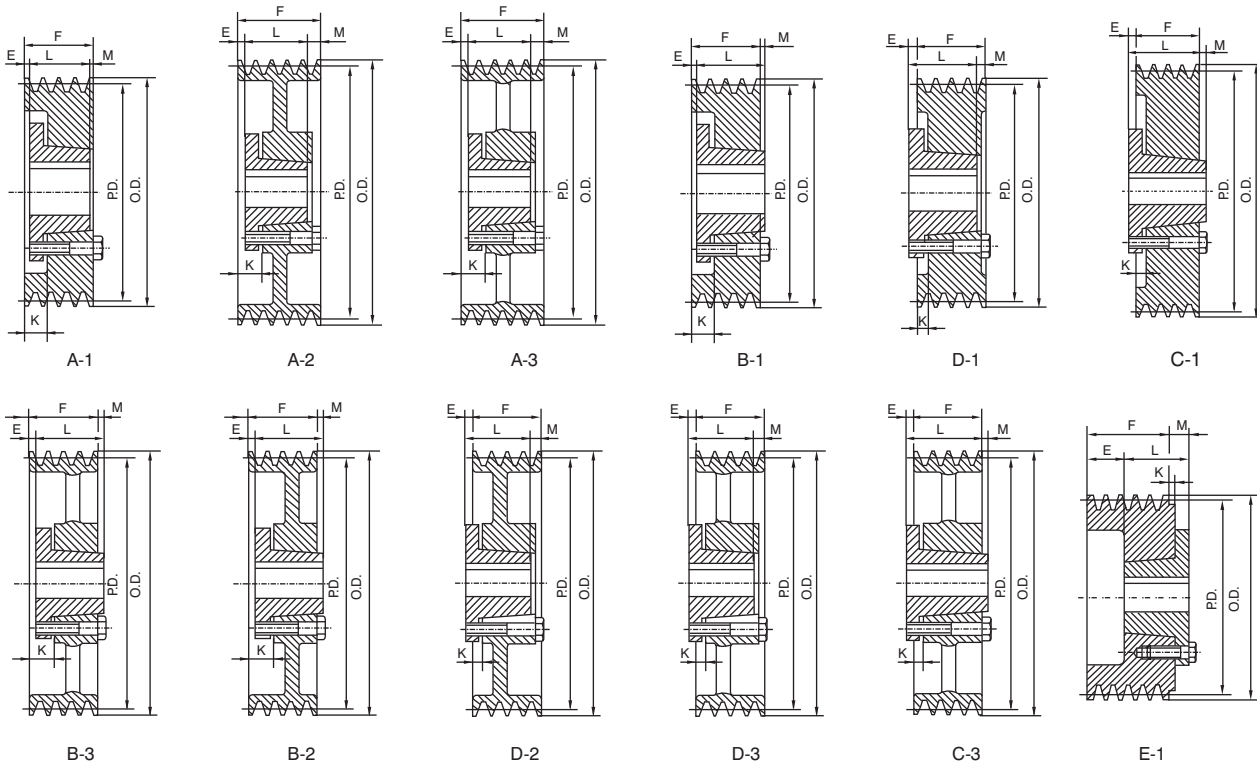

LEESON's series of taper bore V-pulleys are made of high-grade GG25 cast iron. They are matched with QTL "Quick Detachable" (QD) bushings for easy on-and-off use. These Narrow V-Belt sheaves offer higher horsepower than classical models and are suited to most power transmission installations.



**NOMENCLATURE FOR TAPER-LOCK SHEAVES
FOR STANDARD NARROW V BELT**

2 - 3V 220 - JA

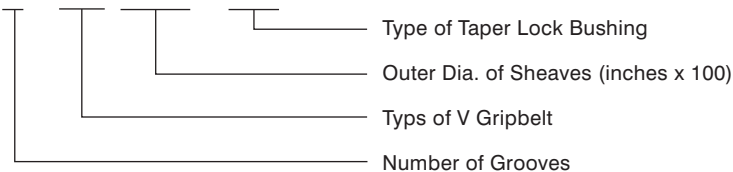

FOR QTL TAPER BUSHING - SEE PAGE 10

3V-5V-8V

3V-5V-8V V-PULLEYS FOR QTL TAPER BUSHING

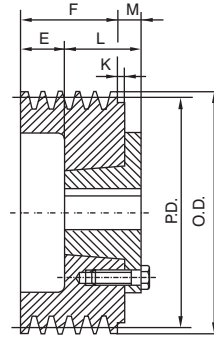

E-1

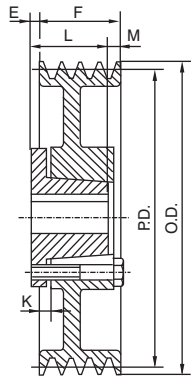

D-2

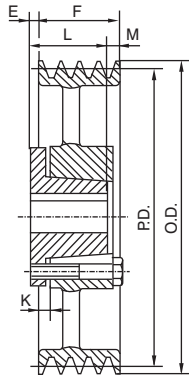

D-3

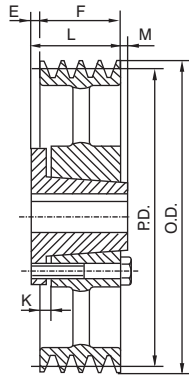

C-3

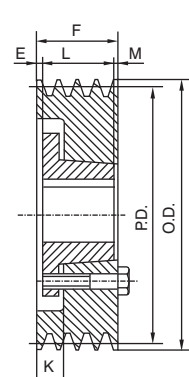

A-1

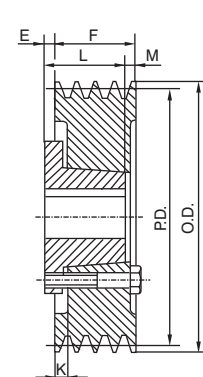

D-1

3V-4

F = 1 29/32" (48.42mm)

Part No.	O.D.	P.D.	Bush Max Bore	Bush	Type	Db	E	K	L	M	Wgt. Less Bush
4-3V265-JA	2.65	2.60	1 1/4	JA	D1	—	3/8	1/8	1 1/16	1 7/32	1.3
4-3V280-JA	2.80	2.75	1 1/4	JA	D1	—	3/8	1/8	1 1/16	1 7/32	1.6
4-3V300-SH	3.00	2.95	1 11/16	SH	E1	—	1 15/32	5/16	1 5/16	7/8	1.9
4-3V315-SH	3.15	3.10	1 11/16	SH	E1	3	1 15/32	5/16	1 5/16	7/8	2.2
4-3V335-SH	3.35	3.30	1 11/16	SH	D1	—	7/16	1/8	1 5/16	1 1/32	2.5
4-3V365-SH	3.65	3.60	1 11/16	SH	D1	—	7/16	1/8	1 5/16	1 1/32	2.8
4-3V412-SH	4.12	4.07	1 11/16	SH	A1	—	1/4	13/16	1 5/16	1 11/32	3.2
4-3V450-SDS	4.50	4.45	2	SDS	A1	—	3/16	13/16	1 3/8	1 11/32	3.5
4-3V475-SDS	4.75	4.70	2	SDS	A1	—	3/16	13/16	1 3/8	1 11/32	4.0
4-3V500-SDS	5.00	4.95	2	SDS	A1	—	3/16	13/16	1 3/8	1 11/32	4.5
4-3V530-SDS	5.30	5.25	2	SDS	A1	—	3/16	13/16	1 3/8	1 11/32	5.0
4-3V560-SDS	5.60	5.55	2	SDS	A1	—	3/16	13/16	1 3/8	1 11/32	5.7
4-3V600-SK	6.00	5.95	2 5/8	SK	D1	—	1/16	5/8	1 15/16	1/32	7.5
4-3V650-SK	6.50	6.45	2 5/8	SK	D2	—	1/16	5/8	1 15/16	1/32	8.0
4-3V690-SK	6.90	6.85	2 5/8	SK	D2	—	1/16	5/8	1 15/16	1/32	10
4-3V800-SK	8.00	7.95	2 5/8	SK	D2	4 3/8	1/16	5/8	1 15/16	1/32	12
4-3V1060-SK	10.60	10.55	2 5/8	SK	D3	4 3/8	1/16	5/8	1 15/16	1/32	16
4-3V1400-SK	14.00	13.95	2 5/8	SK	D3	4 3/8	1/16	5/8	1 15/16	1/32	22
4-3V1900-SF	19.00	18.95	2 15/16	SF	C3	5	1/16	5/8	2 1/16	3/32	37
4-3V2500-SF	25.00	24.95	2 15/16	SF	C3	5	1/16	5/8	2 1/16	3/32	53
4-3V-3350-E	33.50	33.45	3 1/2	E	C3	6 1/4	3/8	1/2	2 5/8	1 11/32	80

FOR QTL TAPER BUSHING - SEE PAGE 10