

3.3" DIAMETER



General Purpose Motors



Fig. A D200, D201



Fig. B D202, D203, D206, D210, D216, D229, D230



Fig. C D211, D213



Fig. D D402, D403



Fig. E D207



Fig. F D205



Fig. G D228

- 115 and 230 VAC models
- Thermally protected
- UL recognized
- CSA certified

SKELETON MOTORS • AIR-OVER • 3.25" DIA.									
H.P.	Volts	Amps	RPM	Rot.	Model	Fig.	"A" Dim.	Shaft Dim.	
1/85	115	.6	3000	C.W.	D200	A	2	2 ³ / ₈ x 1 ¹ / ₄ x 3 ³ / ₄	
1/85	115	.6	3000	C.C.W.	D201	A	2 ¹ / ₄	1 ¹ / ₄ x 1 ³ / ₈	

SHADED POLE • OPEN VENTILATION • AIR-OVER									
H.P.	Volts	Amps	RPM	Rot.	Model	Fig.	"A" Dim.	Shaft Dim.	
1/100	115	.55	3000	C.C.W.	D229	B	2 ¹ / ₂	1 ¹ / ₄ x 3 ¹ / ₂	
1/100	115	.55	3000	C.W.	D230	B	2 ¹ / ₂	1 ¹ / ₄ x 3 ¹ / ₂	
1/85	115	.6	3000	C.W.	D202	B	2 ³ / ₈	1 ¹ / ₄ x 2 ¹ / ₄	
1/80	115	.8	3000	C.W.	D228	G	2 ¹ / ₂	1 ¹ / ₄ x 2	
1/40	115	1.0	3000	C.C.W.	D203	B	2 ³ / ₄	1 ¹ / ₄ x 2 ¹ / ₄	
1/30	115	1.2	3000	C.W.	D206	B	2 ³ / ₄	1 ¹ / ₄ x 2 ¹ / ₄	
1/30	230	.6	3000	D.S.	D207	E	2 ³ / ₄	2 ¹ / ₄ x 1 ¹ / ₄ x 2 ¹ / ₄	
1/25	115	1.3	3000	C.W.	D210	B	3 ¹ / ₄	1 ¹ / ₄ x 2 ¹ / ₄	
1/25	230	.65	3000	C.W.	D216	B	3 ¹ / ₄	1 ¹ / ₄ x 2 ¹ / ₄	
1/15	230	1.1	3000	D.S.	D211	C	3 ⁷ / ₈	2 ¹ / ₂ x 1 ¹ / ₄ x 2 ¹ / ₂	
1/15	115	2.1	3000	D.S.	D213	C	3 ⁷ / ₈	2 ³ / ₄ x 1 ¹ / ₄ x 2 ³ / ₄	

SHADED POLE • TOTALLY ENCLOSED • AIR-OVER									
H.P.	Volts	Amps	RPM	Rot.	Model	Fig.	"A" Dim.	Shaft Dim.	
1/60	115	.75	3000	C.W.	D402	D	2 ³ / ₈	1 ¹ / ₄ x 1 ³ / ₄	
1/60	115	.75	3000	C.C.W.	D403	D	2 ³ / ₈	1 ¹ / ₄ x 2 ¹ / ₄	
1/40-1/70	115	1.0-.5	3000	D.S.	D205	F	2 ⁷ / ₈	3 x 1 ¹ / ₄ x 3	

NOTE: Rotation is determined by looking at shaft end. Shaft length is measured from motor face.

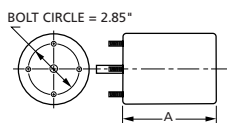

Products on this page are NOT SUITABLE for unattended equipment unless indicated by symbol. See inside back cover for additional information.

See pages 48 through 71 for OEM direct replacement models.