



**Fig. A D208, D608**



**Fig. B D209**



**Fig. C D214, D215, D220**



**Fig. D D218, D219**



**Fig. E D404, D405**

- 115, 230 and 115/230 VAC models
- UL recognized
- Self-cooled for mechanical duty
- Thermally protected
- CSA certified

SHADED POLE • OPEN VENTILATION • SELF-COOLED									
H.P.	Volts	Amps	RPM	Rot.	Model	Fig.	Dia.	"A" Dim.	Shaft Dim.
1/50	230	.6	3000	C.W.	D608	A	3.33	3 <sup>3</sup> / <sub>4</sub>	1/4 x 1 <sup>5</sup> / <sub>16</sub>
1/30	115	1.1	3000	D.S.	D209	B	3.33	3 <sup>5</sup> / <sub>8</sub>	3/4 x 1/4 x 3 1/4
1/30	115	1.1	3000	C.W.	D208	A	3.33	3 <sup>5</sup> / <sub>8</sub>	1/4 x 3

SHADED POLE • TOTALLY ENCLOSED • SELF-COOLED									
H.P.	Volts	Amps	RPM	Rot.	Model	Fig.	Dia.	"A" Dim.	Shaft Dim.
1/20	115/230	1.7/1.8	3000	C.W.	D214★	C	3.91	4 <sup>5</sup> / <sub>8</sub>	5/16 x 6 1/2
1/20	115/230	1.7/1.8	3000	C.C.W.	D215•	C	3.91	4 <sup>5</sup> / <sub>8</sub>	5/16 x 6 1/2
1/20	115/230	1.7/1.8	3000	C.W.	D220•	C	3.91	4 <sup>5</sup> / <sub>8</sub>	5/16 x 6 1/2

- ★ Popular ice machine pump motor
- Ball bearing motor

**NOTE:** Rotation is determined by looking at shaft end. Shaft length is measured from motor face.

PSC • TOTALLY ENCLOSED • SELF-COOLED									
H.P.	Volts	Amps	RPM	Rot.	Model	Fig.	Dia.	"A" Dim.	Shaft Dim.
1/25	115	.8	3000	Rev.	D218•#	D	3.91	4 <sup>3</sup> / <sub>8</sub>	5/16 x 2 1/4
1/8	115	1.8	3000	Rev.	D219•#	D	3.91	5 1/8	5/16 x 2 1/4

- Ball bearing motor
- #4M 370V capacitor included

PSC • OPEN VENTILATION • AIR-OVER									
H.P.	Volts	Amps	RPM	Rot.	Model	Fig.	Dia.	"A" Dim.	Shaft Dim.
1/10	208-230	.8	3200	Rev.	D404•#	E	3.33	4 1/4	5/16 x 3 1/4
1/10	115	1.4	3200	Rev.	D405•#	E	3.33	4 1/4	5/16 x 3 1/4

- Ball bearing motor
- #4M 370V capacitor included

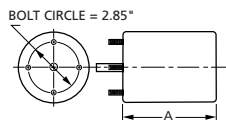

Products on this page are NOT SUITABLE for unattended equipment unless indicated by ► symbol. See inside back cover for additional information.

See pages 48 through 71 for OEM direct replacement models.

PSC motors use 5M 370V capacitors unless otherwise indicated.