

# 3.3" DIAMETER



## General Purpose Motors

- 115, 230, 240 and 208-240 VAC models
- Thermally protected
- UL recognized
- CSA certified



Fig. A D128, D129, D136



Fig. B D365



Fig. C D120, D121, D126, D127, D181, D190, D532, D603, D609



Fig. D D332



Fig. E D364



Fig. F D514, D515



Fig. G D184



Fig. I D105, D106



Fig. K D111



Fig. H D1134



Fig. J D107



Fig. L D1119

### SHADED POLE • OPEN VENTILATION • AIR-OVER

H.P.	Volts	Amps	RPM	Rot.	Model	Fig.	"A" Dim.	Shaft Dim.
1/160	208-240	.5	600	C.C.W.	D107	J	2 <sup>5</sup> / <sub>8</sub>	<sup>5</sup> / <sub>16</sub> x 1
1/125-1/200	115	.4-.3	1500	D.S.	D129*	A	2 <sup>1</sup> / <sub>8</sub>	3 <sup>1</sup> / <sub>4</sub> x <sup>1</sup> / <sub>4</sub> x 3 <sup>1</sup> / <sub>4</sub>
1/90	240	.34	1500	C.C.W.	D1119	L	2 <sup>1</sup> / <sub>4</sub>	<sup>1</sup> / <sub>4</sub> x 1 <sup>1</sup> / <sub>2</sub>
1/70	115	.7	1500	C.W.	D120	C	2 <sup>1</sup> / <sub>8</sub>	<sup>1</sup> / <sub>4</sub> x 2 <sup>1</sup> / <sub>4</sub>
1/70	115	.7	1500	C.C.W.	D121	C	2 <sup>1</sup> / <sub>8</sub>	<sup>1</sup> / <sub>4</sub> x 2 <sup>1</sup> / <sub>4</sub>
1/50-1/65-1/80	115	1.1-8-6	1300	C.W.	D1134	H	2 <sup>1</sup> / <sub>4</sub>	<sup>1</sup> / <sub>4</sub> x 1 <sup>3</sup> / <sub>4</sub>
1/50	115	.9	1500	C.C.W.	D609	C	2 <sup>3</sup> / <sub>16</sub>	<sup>1</sup> / <sub>4</sub> x 2 <sup>3</sup> / <sub>8</sub>
1/50	115	.9	1500	C.W.	D603	C	2 <sup>3</sup> / <sub>16</sub>	<sup>1</sup> / <sub>4</sub> x 2 <sup>3</sup> / <sub>8</sub>
1/40	115	1.1	1500	C.W.	D126	C	2 <sup>1</sup> / <sub>2</sub>	<sup>5</sup> / <sub>16</sub> x 2 <sup>1</sup> / <sub>4</sub>
1/40	115	1.0	1500	C.C.W.	D127	C	2 <sup>1</sup> / <sub>2</sub>	<sup>5</sup> / <sub>16</sub> x 2 <sup>1</sup> / <sub>4</sub>
1/40-1/50-1/80	115	1.3-9-.6	1500	D.S.	D128	A	2 <sup>1</sup> / <sub>2</sub>	4 x <sup>5</sup> / <sub>16</sub> x 4
1/40	230	.60	1500	C.W.	D190	C	2 <sup>1</sup> / <sub>2</sub>	<sup>1</sup> / <sub>4</sub> x 2 <sup>1</sup> / <sub>4</sub>
1/40	115	.9	1550	C.C.W.	D106	I	2 <sup>1</sup> / <sub>8</sub>	<sup>1</sup> / <sub>4</sub> x 1 <sup>3</sup> / <sub>4</sub>
1/37	115	.94	1550	C.C.W.	D105	I	2 <sup>1</sup> / <sub>8</sub>	<sup>1</sup> / <sub>4</sub> x 1 <sup>1</sup> / <sub>2</sub>
1/30-1/300	115	1.1-5	1550/800	C.C.W.	D111	K	2 <sup>3</sup> / <sub>4</sub>	<sup>5</sup> / <sub>16</sub> x 3 discontinued
1/30	115	1.3	1500	D.S.	D136	A	3 <sup>1</sup> / <sub>4</sub>	2 x <sup>5</sup> / <sub>16</sub> x 2
1/30	115	1.3	1500	C.W.	D514	F	2 <sup>3</sup> / <sub>4</sub>	<sup>5</sup> / <sub>16</sub> x 2 <sup>1</sup> / <sub>4</sub>
1/30	115	1.3	1500	C.C.W.	D515	F	2 <sup>5</sup> / <sub>8</sub>	<sup>5</sup> / <sub>16</sub> x 2 <sup>1</sup> / <sub>4</sub>
1/30-1/80	115	1.4-.8	1500	C.W.	D532	C	2 <sup>3</sup> / <sub>4</sub>	<sup>5</sup> / <sub>16</sub> x 1 <sup>1</sup> / <sub>2</sub>
1/30-1/40	115	1.3-1.0	1500	C.C.W.	D181	C	2 <sup>5</sup> / <sub>8</sub>	<sup>5</sup> / <sub>16</sub> x 2 <sup>1</sup> / <sub>4</sub>
1/25-1/65	115	1.5-.8	1500	C.W.	D332	D	3 <sup>1</sup> / <sub>4</sub>	<sup>5</sup> / <sub>16</sub> x 2
1/25	115	1.8	1500	D.S.	D364	E	2 <sup>7</sup> / <sub>8</sub>	1 <sup>7</sup> / <sub>8</sub> x <sup>5</sup> / <sub>16</sub> x 1 <sup>7</sup> / <sub>8</sub>
1/25	115	1.8	1500	D.S.	D365†	B	2 <sup>7</sup> / <sub>8</sub>	1 <sup>7</sup> / <sub>8</sub> x <sup>5</sup> / <sub>16</sub> x 1 <sup>7</sup> / <sub>8</sub>
1/25	115	1.2	1500	C.W.	D184*	G	3	<sup>5</sup> / <sub>16</sub> x 1 <sup>7</sup> / <sub>8</sub>

\* Closed construction    □ Impedance protected    † Has hubs for end rings

NOTE: Rotation is determined by looking at shaft end. Shaft length is measured from motor face.

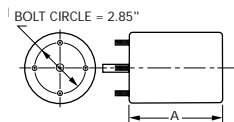

Products on this page are NOT SUITABLE for unattended equipment unless indicated by ► symbol. See inside back cover for additional information.

See pages 48 through 71 for OEM direct replacement models.