

3.3" DIAMETER



Refrigeration Fan Motors



Fig. A D429, D437

UNIT BEARING REPLACEMENT

- Mounting bracket designed to match the original motor (four 8-36 drilled and tapped holes).
- Mounting hardware included with all models.
- All motor lengths were designed to match replacing unit.
- All motors have 22" leads with 1/64" thick insulation
- Rotation is as viewing motor shaft end.
- Three studs all opposite shaft end are 8-32 on a standard 2.84" bolt circle, 120° apart.

SHADED POLE • 1550 RPM • HUBLESS FAN TYPE							
Watts	Volts	Amps	Rot.	Model	Fig.	"C" Dim.	Cross Reference
9	115	.6	C.C.W.	D429	A	3	GE 5411
16	115	1.1	C.C.W.	D437	A	3 7/32	GE 5811

IMPORTANT NOTE: These motors often replace unit bearing motors whose rotation is described *opposite* shaft end. This is different from Fasco standard, which is determined by looking at shaft end.



Fig. B D470, D471, D472, D473, D477

- 115, 208-230 and 460 VAC models
- Thermally protected
- 3.9" Diameter
- Extended hubs with rubber rings for base mount
- UL recognized
- Interchangeable with G.E. 11 Frame refrigeration motors
- 1/2" studs for mounting

SHADED POLE • OPEN VENTILATION • SELF COOLED									
H.P.	Volts	Amps	RPM	Rot.	Model	Fig.	"A" Dim.	Shaft Dim.	Cross Reference
1/35	208-230	.75	1550	CCW.	D477	B	4 1/4	5/16 x 1 5/8	GE 1432
1/20	208/230	1.1	1550	CCW.	D471	B	4 1/4	5/16 x 2 1/2	GE 1332
1/20	208/230	.94	1550	C.W.	D470	B	4 1/4	5/16 x 2 5/8	GE 1342
1/20	115	1.9	1550	C.W.	D472	B	4 1/4	5/16 x 2 5/8	GE 1341
1/20	115	2.0	1550	CCW.	D473	B	4 1/4	5/16 x 2 5/8	GE 1331
1/15	460	.6	1550	C.C.W.	D475*†	C	4 1/2	5/16 x 2 1/2	*
1/15	460	.5	1550	C.W.	D498†	C	4 1/2	5/16 x 2 1/2	—
1/12	208/230	1.3	1550	C.C.W.	D469	D	4 1/3	5/16 x 2 1/8	GE 1232

* See Tecumseh OEM section (page 68) for cross references

† Do not have extended hubs or rubber rings for base mount

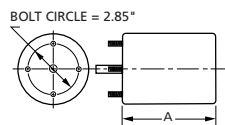
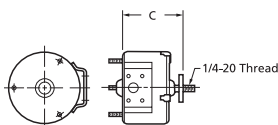

Fig. C D475, D498



Fig. D D469

NOTE: Rotation is determined by looking at shaft end. Shaft length is measured from motor face.



Products on this page are NOT SUITABLE for unattended equipment unless indicated by ► symbol. See inside back cover for additional information.

See pages 48 through 71 for OEM direct replacement models.