



Fig. A D1125



Fig. B D1124, D1126



Fig. C D1101, D1103, D1152, D1154



Fig. D D1142



Fig. E D1144



Fig. F D1164



Fig. G D1120, D1121



Fig. H D1243, D1245

NEW
NEW

NEW

BOHN*							
EVAPORATOR COIL AND REFRIGERATOR FAN MOTORS							
H.P.	Volts	Amps	RPM	Model	Fig.	"A" Dim.	Shaft Dim.
1/20	115	2.1	1550	D1124*#	B	3	5/16 X 3
1/15	230	1.1	1550	D1126*#	B	3 1/2	5/16 X 3
1/15	208-230	.4	1550	D1125▲†	A	3 3/4	5/16 X 2 5/8
KEEPRITE							
C.C.W. ROT. • EVAPORATOR COIL AND REFRIGERATOR FAN MOTORS SHADED POLE							
1/20	115	2.1	1550	D1120	G	3 1/2	5/16 X 2 1/2
1/20	208-230	1.0	1550	D1121	G	3 1/2	5/16 X 2 1/2
1/20	115	.8	1550	D1243	H	4 1/8	5/16 X 2 3/4
1/20	230	.4	1550	D1245	H	4	5/16 X 2 3/4
KRAMER-TRENTON							
C.W. ROT. • EVAPORATOR COIL AND REFRIGERATION FAN MOTORS SHADED POLE							
1/20	115	2.1	1500	D1152	C	2 7/8	5/16 X 2 3/8
1/20	230	1.0	1500	D1154	C	3 1/8	5/16 X 2 3/8
LARKIN COIL							
C.C.W. ROT. • EVAPORATOR COIL AND REFRIGERATOR FAN MOTORS SHADED POLE							
1/20	115	1.9	1550	D1101^	C	2 3/4	5/16 X 2 1/4
1/20	208-230	1.15	1550	D1103^	C	3	5/16 X 2 1/4
McQUAY							
C.W. ROT. • EVAPORATOR COIL AND REFRIGERATION FAN MOTORS							
1/25-1/35-1/65	115	1.1-.9-.6	1200	D1144+■	E	4 3/4	3/8 X 5 5/8
1/15	115/230	1.7/1.9	1500	D1142†**	D	3 1/2	5/16 X 2 1/2
SINGER							
C.W. ROT. • EVAPORATOR COIL AND REFRIGERATION FAN MOTORS SHADED POLE							
1/25	115/230	1.3/.65	1550	D1164	F	3 1/8	5/16 X 2 1/2
WITT							
C.W. ROT. • EVAPORATOR COIL AND REFRIGERATION FAN MOTORS SHADED POLE							
1/20	115/230	.75/0.4	1550	D1102	I	3 1/2	5/16 X 2 5/8

* Special low temperature oil. ▲ Includes 4M 370V capacitor, PSC Motor
 # C.W. † C.C.W. ^ Special low temperature oil. + PSC use 4M370V capacitor
 † Bolt circle = 3.15" ■ P.S.C. ** Shaded Pole

NOTE: Rotation is determined by looking at shaft end. Shaft length is measured from motor face.



Fig. I D1102

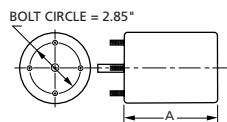

Products on this page are NOT SUITABLE for unattended equipment unless indicated by ▶ symbol. See inside back cover for additional information.

See pages 48 through 71 for OEM direct replacement models.