

- 115 VAC motors
- UL recognized
- Thermally protected
- CSA certified
- Interchangeable with most window air-conditioner motors



Fig. A D366, D367



Fig. B D325



Fig. C D323



Fig. D D326



Fig. E D1176



Fig. F D1112



Fig. G D1113



Fig. H D1111

SHADED POLE • OPEN VENTILATION • AIR-OVER							
H.P.	Amps	RPM	Rot.	Model	Fig.	"A" Dim.	Shaft Dim.
1/18-1/30	2.4/1.2	1330	C.C.W.	D1111 ■	H	3 1/2	3 1/8 x 5/16 x 2 3/8
1/16-1/25-1/35	1.9-1.6-1.4	1550	D.S.	D1113 ■	G	3 3/8	2 7/16 x 5/16 x 3 1/4
1/14-1/25	2.5-1.5	1550	D.S.	D366	A	3 1/4	6 3/8 x 5/16 x 6 3/8
1/12-1/20-1/30	3.0-2.1-1.7	1550	D.S.	D367	A	3 5/8	5 3/4 x 5/16 x 5 3/4
1/10-1/30	2.5-2.3	1550	C.C.W.	D325 ■	B	3 1/2	1 3/4 x 5/16 x 2 3/8

NOTE: Rotation is determined by looking at shaft end. Shaft length is measured from motor face.

PSC • OPEN AND TOTALLY ENCLOSED • AIR-OVER								
H.P.	Amps	RPM	Rot.	Model	Fig.	Const.	"A" Dim.	Shaft Dim.
1/15-1/25	.9-8	1550	D.S.	D1176#	E	Closed	4	4 7/8 x 3/8 x 4 7/8
1/15-1/20-1/35	1.1-8-6	1550	D.S.	D323+°	C	Closed	3 3/4	2 3/4 x 5/16 x 2 3/4
1/15-1/20-1/25	1.5-1.0-9	1550	C.W.	D1112■°	F	Open	4	2 5/8 x 5/16 x 2 7/8
1/10-1/20-1/25	1.9-1.8-1.5	1550	D.S.	D326†#	D	Open	4 1/8	5 1/2 x 5/16 x 3

- † Wiring slightly different from OEM PSC; check nameplate connection diagram. Capacitor and Bracket included. Replaces 2 and 3 speed shaded pole motor; also 2 and 3 speed PSC. Motor in Gibson/Belding window units.
- + Totally enclosed, Sears-Whirlpool 5000-8000 BTU units.
- ° 3M370V capacitor
- Rotation determined by viewing lug end
- Ball bearing motor
- # 4M 370V capacitor

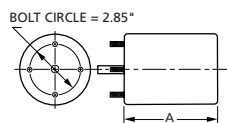

Products on this page are NOT SUITABLE for unattended equipment unless indicated by ► symbol. See inside back cover for additional information.

See pages 48 through 71 for OEM direct replacement models.