

- Thermally protected
- UL Recognized
- CSA Certified



Fig. A D415, D418



Fig. B D1191



Fig. C D1192



Fig. D D1188



Fig. E D1196



Fig. G D1193



Fig. F D1194



Fig. H D1198

SHADED POLE • OPEN VENTILATION								
H.P.	Volts	Amps	RPM	Rot.	Model	Fig.	"A" Dim.	Shaft Dim.
1/50	115	1.1	1550	C.W.	D418•	A	5 ¹ / ₂	¹ / ₄ x 3
1/40	115	1.1	1550	C.C.W.	D415•	A	5 ¹ / ₂	¹ / ₄ x 3
1/40	460	.37	3200	C.C.W.	D1191•	B	5 ³ / ₄	¹ / ₄ x 2 ¹ / ₂
1/40	115	.7	3000	C.C.W.	D1192	C	5 ¹ / ₃	⁵ / ₁₆ x 1 ¹ / ₂
1/33	115	1.5	3200	C.C.W.	D1196	E	3 ¹ / ₄	⁵ / ₁₆ x 2 ¹ / ₃
1/30	115	1.5	3000	C.C.W.	D1198	H	3 ¹ / ₈	⁵ / ₁₆ x 2 ¹ / ₃
1/25	115	1.7	3200	C.W.	D1194•	F	5 ¹ / ₂	⁵ / ₁₆ x 1 ¹ / ₃
1/22	115	1.2	3000	C.C.W.	D1193	G	2 ⁷ / ₈	⁵ / ₁₆ x 2 ¹ / ₃
1/15	208-230/460	1.1/1.6	3000	C.W.	D1188•	D	6 ⁵ / ₈	⁵ / ₁₆ x 2

- Ball bearing motor

NOTE: Rotation is determined by looking at shaft end. Shaft length is measured from motor face.

All models except D1192 and D1194 have stainless steel shafts.

All models with 1/4" diameter shafts include a shaft bushing.

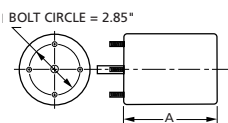

Products on this page are NOT SUITABLE for unattended equipment unless indicated by ► symbol. See inside back cover for additional information.

See pages 48 through 71 for OEM direct replacement models.