



**Fig. A** D116, D118, D170, D310, D374, D377, D674



**Fig. B** D174



**Fig. C** D112, D312, D435



**Fig. D** D1170



**Fig. E** D1039



**Fig. F** D1061



**Fig. G** D119

- 115 and 230 VAC models
- Thermally protected
- UL recognized
- CSA certified

SHADED POLE • OPEN VENTILATION • AIR-OVER									
H.P.	Volts	Amps	RPM	Rot.	Model Dim.	Fig.	"A"	Shaft Dim.	
▶ 1/20-1/30-1/60	115	2.0-1.7- 1.4	1500	C.C.W.	D1061■	F	4 <sup>1</sup> / <sub>8</sub>	1/2 x 2 <sup>3</sup> / <sub>8</sub>	
▶ 1/20	115	1.7	1500	C.W.	D170†	A	2 <sup>3</sup> / <sub>4</sub>	5/16 x 2 <sup>1</sup> / <sub>4</sub>	
▶ 1/15	115	2.4	1500	C.W.	D116	A	3	3/8 x 2 <sup>3</sup> / <sub>8</sub>	
▶ 1/15-1/30	115	2.4-1.4	1500	C.W.	D118	A	3	3/8 x 2 <sup>3</sup> / <sub>8</sub>	
▶ 1/15	115	2.1	1500	C.W.	D1170•✓	D	4 <sup>3</sup> / <sub>4</sub>	3/8 x 2 <sup>1</sup> / <sub>2</sub>	
▶ 1/12	115	3.1	1500	C.C.W.	D377*	A	2 <sup>3</sup> / <sub>4</sub>	3/8 x 2	
▶ 1/12	115	4.0	1500	C.W.	D310★	A	2 <sup>3</sup> / <sub>4</sub>	3/8 x 2	
▶ 1/11-1/25-1/70	115	2.9-1.5-1.0	1500	C.C.W.	D119•#	G	3 <sup>3</sup> / <sub>4</sub>	1/2 x 2 <sup>5</sup> / <sub>8</sub>	
▶ 1/10	115	3.5	1500	C.W.	D174	B	3 <sup>3</sup> / <sub>8</sub>	3/8 x 2 <sup>1</sup> / <sub>8</sub>	
▶ 1/10-1/15	230	2.0-1.3	1500	C.W.	D674	A	3 <sup>3</sup> / <sub>8</sub>	3/8 x 2 <sup>1</sup> / <sub>2</sub>	
▶ 1/10	115	3.1	1500	C.C.W.	D1039‡	E	4 <sup>1</sup> / <sub>2</sub>	1/2 x 2 <sup>3</sup> / <sub>8</sub>	
▶ 1/8-1/20	115	4.0-2.5	1500	C.W.	D374	A	3 <sup>5</sup> / <sub>8</sub>	3/8 x 2 <sup>1</sup> / <sub>2</sub>	

- Ball bearing motor
- \* Used in Jenn Air units. P/N 7108-2101
- ★ Used in Leslie Locke ventilators original P/N 7108-5056
- ✓ OEM direct replacement for Jenn Air 80CR.
- # Used in Acme Eng. Roof Vents.
- ‡ ILG ventilator 7108-2171. Has internal fan.
- For use with Greenheck Fan
- † Shaft stepped down from 3/8" dia. shaft.

SHADED POLE • OPEN VENTILATION SELF COOLED FOR MECHANICAL DUTY									
H.P.	Volts	Amps	RPM	Rot.	Model	Fig. Dim.	"A" Dim.	Shaft Dim.	
1/15	115	2.7	1500	C.W.	D312+	C	4 <sup>1</sup> / <sub>4</sub>	1/2 x 5	
1/10	115	3.6	1500	C.W.	D112	C	4 <sup>1</sup> / <sub>2</sub>	3/8 x 2 <sup>5</sup> / <sub>8</sub>	
1/10	230	1.7	1500	C.C.W.	D435	C	4 <sup>1</sup> / <sub>2</sub>	3/8 x 2 <sup>5</sup> / <sub>8</sub>	

+ External oil retainer to accommodate resilient rings and cradle base, drilled and tapped holes in case for mounting in Coleman applications. (2 holes each end on case OD).

**NOTE:** Rotation is determined by looking at shaft end. Shaft length is measured from motor face.

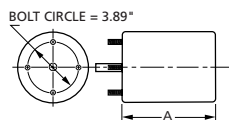

Products on this page are NOT SUITABLE for unattended equipment unless indicated by ▶ symbol. See inside back cover for additional information.

See pages 48 through 71 for OEM direct replacement models.