

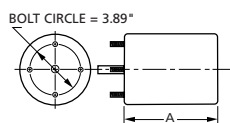

Fig. A D480, D481, D482, D483, D484, D485

- 4.4" Diameter
- 115/208-230 VAC
- Thermally protected
- UL recognized
- CSA certified
- Mechanically reversible
- 3/8" shaft diameter with adapter to convert to 1/2" diameter
- Weld nuts on a 3.5" B.C. for stud mount
- Extended hubs with rubber rings for base mount
- Interchangeable with G.E. 21 and 29 Frame motors and other Emerson, Universal and Franklin refrigeration motors

SHADED POLE • OPEN VENTILATION • SELF-COOLED									
H.P.	Volts	Amps	RPM	Rot.	Model	Fig.	"A" Dim.	Shaft Dim.	Cross Reference
1/20	115/208-230	2.2/1.1	1550	C.W.	D484	A	4	3/8 x 3 1/8	GE 2341,2342
1/15	115/208-230	3.2/1.6	1550	C.W.	D482	A	4	3/8 x 3 1/8	GE 2241,2242
1/10	115/208-230	4.5/2.2	1550	C.W.	D480	A	4 5/8	3/8 x 3 1/8	GE 2141,2142
1/20	115/208-230	2.2/1.1	1550	C.C.W.	D485	A	4	3/8 x 3 1/8	GE 2331,2332
1/15	115/208-230	3.2/1.6	1550	C.C.W.	D483	A	4	3/8 x 3 1/8	GE 2231,2232
1/10	115/208-230	4.5/2.2	1550	C.C.W.	D481	A	4 5/8	3/8 x 3 1/8	GE 2131,2132

NOTE: Rotation is determined by looking at shaft end.
Can be operated on 50Hz with air-over applications.



Products on this page are NOT SUITABLE for unattended equipment unless indicated by ► symbol. See inside back cover for additional information.

See pages 48 through 71 for OEM direct replacement models.