

# 3.3" DIAMETER



## General Purpose Motors



Fig. A D200, D201



Fig. B D202, D203, D206, D210, D216, D229, D230



Fig. C D211, D213



Fig. D D402, D403



Fig. E D207



Fig. F D205



Fig. G D228

- 115 and 230 VAC models
- UL recognized
- Thermally protected
- CSA certified

SKELETON MOTORS • AIR-OVER • 3.25" DIA.									
H.P.	Volts	Amps	RPM	Rot.	Model	Fig.	"A" Dim.	Shaft Dim.	
1/85	115	.6	3000	C.W.	D200	A	2	2 <sup>3</sup> / <sub>8</sub> x 1 <sup>1</sup> / <sub>4</sub> x 3 <sup>3</sup> / <sub>4</sub>	
1/85	115	.6	3000	C.C.W.	D201	A	2 <sup>1</sup> / <sub>4</sub>	1 <sup>1</sup> / <sub>4</sub> x 1 <sup>3</sup> / <sub>8</sub>	

SHADED POLE • OPEN VENTILATION • AIR-OVER									
H.P.	Volts	Amps	RPM	Rot.	Model	Fig.	"A" Dim.	Shaft Dim.	
1/100	115	.55	3000	C.C.W.	D229	B	2 <sup>1</sup> / <sub>2</sub>	1 <sup>1</sup> / <sub>4</sub> x 3 <sup>1</sup> / <sub>2</sub>	
1/100	115	.55	3000	C.W.	D230	B	2 <sup>1</sup> / <sub>2</sub>	1 <sup>1</sup> / <sub>4</sub> x 3 <sup>1</sup> / <sub>2</sub>	
1/85	115	.6	3000	C.W.	D202	B	2 <sup>3</sup> / <sub>8</sub>	1 <sup>1</sup> / <sub>4</sub> x 2 <sup>1</sup> / <sub>4</sub>	
1/80	115	.8	3000	C.W.	D228	G	2 <sup>1</sup> / <sub>2</sub>	1 <sup>1</sup> / <sub>4</sub> x 2	
1/40	115	1.0	3000	C.C.W.	D203	B	2 <sup>3</sup> / <sub>4</sub>	1 <sup>1</sup> / <sub>4</sub> x 2 <sup>1</sup> / <sub>4</sub>	
1/30	115	1.2	3000	C.W.	D206	B	2 <sup>3</sup> / <sub>4</sub>	1 <sup>1</sup> / <sub>4</sub> x 2 <sup>1</sup> / <sub>4</sub>	
1/30	230	.6	3000	D.S.	D207	E	2 <sup>3</sup> / <sub>4</sub>	2 <sup>1</sup> / <sub>4</sub> x 1 <sup>1</sup> / <sub>4</sub> x 2 <sup>1</sup> / <sub>4</sub>	
1/25	115	1.3	3000	C.W.	D210	B	3 <sup>1</sup> / <sub>4</sub>	1 <sup>1</sup> / <sub>4</sub> x 2 <sup>1</sup> / <sub>4</sub>	
1/25	230	.65	3000	C.W.	D216	B	3 <sup>1</sup> / <sub>4</sub>	1 <sup>1</sup> / <sub>4</sub> x 2 <sup>1</sup> / <sub>4</sub>	
1/15	230	1.1	3000	D.S.	D211	C	3 <sup>7</sup> / <sub>8</sub>	2 <sup>1</sup> / <sub>2</sub> x 1 <sup>1</sup> / <sub>4</sub> x 2 <sup>1</sup> / <sub>2</sub>	
1/15	115	2.1	3000	D.S.	D213	C	3 <sup>7</sup> / <sub>8</sub>	2 <sup>3</sup> / <sub>4</sub> x 1 <sup>1</sup> / <sub>4</sub> x 2 <sup>3</sup> / <sub>4</sub>	

SHADED POLE • TOTALLY ENCLOSED • AIR-OVER									
H.P.	Volts	Amps	RPM	Rot.	Model	Fig.	"A" Dim.	Shaft Dim.	
1/60	115	.75	3000	C.W.	D402	D	2 <sup>3</sup> / <sub>8</sub>	1 <sup>1</sup> / <sub>4</sub> x 1 <sup>3</sup> / <sub>4</sub>	
1/60	115	.75	3000	C.C.W.	D403	D	2 <sup>3</sup> / <sub>8</sub>	1 <sup>1</sup> / <sub>4</sub> x 2 <sup>1</sup> / <sub>4</sub>	
1/40-1/70	115	1.0-.5	3000	D.S.	D205	F	2 <sup>7</sup> / <sub>8</sub>	3 x 1 <sup>1</sup> / <sub>4</sub> x 3	

NOTE: Rotation is determined by looking at shaft end. Shaft length is measured from motor face.

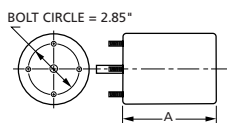

Products on this page are NOT SUITABLE for unattended equipment unless indicated by symbol. See inside back cover for additional information.

See pages 48 through 71 for OEM direct replacement models.



**Fig. A D208, D608**



**Fig. B D209**



**Fig. C D214, D215, D220**



**Fig. D D218, D219**



**Fig. E D404, D405**

- 115, 230 and 115/230 VAC models
- UL recognized
- Self-cooled for mechanical duty
- Thermally protected
- CSA certified

SHADED POLE • OPEN VENTILATION • SELF-COOLED									
H.P.	Volts	Amps	RPM	Rot.	Model	Fig.	Dia.	"A" Dim.	Shaft Dim.
1/50	230	.6	3000	C.W.	D608	A	3.33	3 <sup>3</sup> / <sub>4</sub>	1/4 x 1 <sup>5</sup> / <sub>16</sub>
1/30	115	1.1	3000	D.S.	D209	B	3.33	3 <sup>5</sup> / <sub>8</sub>	3/4 x 1/4 x 3 1/4
1/30	115	1.1	3000	C.W.	D208	A	3.33	3 <sup>5</sup> / <sub>8</sub>	1/4 x 3

SHADED POLE • TOTALLY ENCLOSED • SELF-COOLED									
H.P.	Volts	Amps	RPM	Rot.	Model	Fig.	Dia.	"A" Dim.	Shaft Dim.
1/20	115/230	1.7/1.8	3000	C.W.	D214★	C	3.91	4 <sup>5</sup> / <sub>8</sub>	5/16 x 6 1/2
1/20	115/230	1.7/1.8	3000	C.C.W.	D215•	C	3.91	4 <sup>5</sup> / <sub>8</sub>	5/16 x 6 1/2
1/20	115/230	1.7/1.8	3000	C.W.	D220•	C	3.91	4 <sup>5</sup> / <sub>8</sub>	5/16 x 6 1/2

- ★ Popular ice machine pump motor
- Ball bearing motor

**NOTE:** Rotation is determined by looking at shaft end. Shaft length is measured from motor face.

PSC • TOTALLY ENCLOSED • SELF-COOLED									
H.P.	Volts	Amps	RPM	Rot.	Model	Fig.	Dia.	"A" Dim.	Shaft Dim.
1/25	115	.8	3000	Rev.	D218•#	D	3.91	4 <sup>3</sup> / <sub>8</sub>	5/16 x 2 1/4
1/8	115	1.8	3000	Rev.	D219•#	D	3.91	5 1/8	5/16 x 2 1/4

- Ball bearing motor
- #4M 370V capacitor included

PSC • OPEN VENTILATION • AIR-OVER									
H.P.	Volts	Amps	RPM	Rot.	Model	Fig.	Dia.	"A" Dim.	Shaft Dim.
1/10	208-230	.8	3200	Rev.	D404•#	E	3.33	4 1/4	5/16 x 3 1/4
1/10	115	1.4	3200	Rev.	D405•#	E	3.33	4 1/4	5/16 x 3 1/4

- Ball bearing motor
- #4M 370V capacitor included

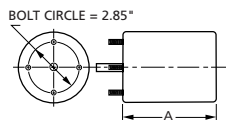

Products on this page are NOT SUITABLE for unattended equipment unless indicated by symbol. See inside back cover for additional information.

See pages 48 through 71 for OEM direct replacement models.

PSC motors use 5M 370V capacitors unless otherwise indicated.

# 3.3" DIAMETER



## General Purpose Motors

- 115, 230, 240 and 208-240 VAC models
- Thermally protected
- UL recognized
- CSA certified



**Fig. A D128, D129, D136**



**Fig. B D365**



**Fig. C D120, D121, D126, D127, D181, D190, D532, D603, D609**



**Fig. D D332**



**Fig. E D364**



**Fig. F D514, D515**



**Fig. G D184**



**Fig. I D105, D106**



**Fig. K D111**



**Fig. H D1134**



**Fig. J D107**



**Fig. L D1119**

### SHADED POLE • OPEN VENTILATION • AIR-OVER

H.P.	Volts	Amps	RPM	Rot.	Model	Fig.	"A" Dim.	Shaft Dim.
1/160	208-240	.5	600	C.C.W.	D107	J	2 <sup>5</sup> / <sub>8</sub>	5 <sup>5</sup> / <sub>16</sub> x 1
1/125-1/200	115	.4-.3	1500	D.S.	D129*	A	2 <sup>1</sup> / <sub>8</sub>	3 <sup>1</sup> / <sub>4</sub> x 1/4 x 3 <sup>1</sup> / <sub>4</sub>
1/90	240	.34	1500	C.C.W.	D1119	L	2 <sup>1</sup> / <sub>4</sub>	1/4 x 1 <sup>1</sup> / <sub>2</sub>
1/70	115	.7	1500	C.W.	D120	C	2 <sup>1</sup> / <sub>8</sub>	1/4 x 2 <sup>1</sup> / <sub>4</sub>
1/70	115	.7	1500	C.C.W.	D121	C	2 <sup>1</sup> / <sub>8</sub>	1/4 x 2 <sup>1</sup> / <sub>4</sub>
1/50-1/65-1/80	115	1.1-8-.6	1300	C.W.	D1134	H	2 <sup>1</sup> / <sub>4</sub>	1/4 x 1 <sup>3</sup> / <sub>4</sub>
1/50	115	.9	1500	C.C.W.	D609	C	2 <sup>3</sup> / <sub>16</sub>	1/4 x 2 <sup>3</sup> / <sub>8</sub>
1/50	115	.9	1500	C.W.	D603	C	2 <sup>3</sup> / <sub>16</sub>	1/4 x 2 <sup>3</sup> / <sub>8</sub>
1/40	115	1.1	1500	C.W.	D126	C	2 <sup>1</sup> / <sub>2</sub>	5 <sup>5</sup> / <sub>16</sub> x 2 <sup>1</sup> / <sub>4</sub>
1/40	115	1.0	1500	C.C.W.	D127	C	2 <sup>1</sup> / <sub>2</sub>	5 <sup>5</sup> / <sub>16</sub> x 2 <sup>1</sup> / <sub>4</sub>
1/40-1/50-1/80	115	1.3-9-.6	1500	D.S.	D128	A	2 <sup>1</sup> / <sub>2</sub>	4 x 5 <sup>5</sup> / <sub>16</sub> x 4
1/40	230	.60	1500	C.W.	D190	C	2 <sup>1</sup> / <sub>2</sub>	1/4 x 2 <sup>1</sup> / <sub>4</sub>
1/40	115	.9	1550	C.C.W.	D106	I	2 <sup>1</sup> / <sub>8</sub>	1/4 x 1 <sup>3</sup> / <sub>4</sub>
1/37	115	.94	1550	C.C.W.	D105	I	2 <sup>1</sup> / <sub>8</sub>	1/4 x 1 <sup>1</sup> / <sub>2</sub>
1/30-1/300	115	1.1-1.5	1550/800	C.C.W.	D111	K	2 <sup>3</sup> / <sub>4</sub>	5 <sup>5</sup> / <sub>16</sub> x 3
1/30	115	1.3	1500	D.S.	D136	A	3 <sup>1</sup> / <sub>4</sub>	2 x 5 <sup>5</sup> / <sub>16</sub> x 2
1/30	115	1.3	1500	C.W.	D514	F	2 <sup>3</sup> / <sub>4</sub>	5 <sup>5</sup> / <sub>16</sub> x 2 <sup>1</sup> / <sub>4</sub>
1/30	115	1.3	1500	C.C.W.	D515	F	2 <sup>5</sup> / <sub>8</sub>	5 <sup>5</sup> / <sub>16</sub> x 2 <sup>1</sup> / <sub>4</sub>
1/30-1/80	115	1.4-.8	1500	C.W.	D532	C	2 <sup>3</sup> / <sub>4</sub>	5 <sup>5</sup> / <sub>16</sub> x 1 <sup>1</sup> / <sub>2</sub>
1/30-1/40	115	1.3-1.0	1500	C.C.W.	D181	C	2 <sup>5</sup> / <sub>8</sub>	5 <sup>5</sup> / <sub>16</sub> x 2 <sup>1</sup> / <sub>4</sub>
1/25-1/65	115	1.5-.8	1500	C.W.	D332	D	3 <sup>1</sup> / <sub>4</sub>	5 <sup>5</sup> / <sub>16</sub> x 2
1/25	115	1.8	1500	D.S.	D364	E	2 <sup>7</sup> / <sub>8</sub>	1 <sup>7</sup> / <sub>8</sub> x 5 <sup>5</sup> / <sub>16</sub> x 1 <sup>7</sup> / <sub>8</sub>
1/25	115	1.8	1500	D.S.	D365†	B	2 <sup>7</sup> / <sub>8</sub>	1 <sup>7</sup> / <sub>8</sub> x 5 <sup>5</sup> / <sub>16</sub> x 1 <sup>7</sup> / <sub>8</sub>
1/25	115	1.2	1500	C.W.	D184*	G	3	5 <sup>5</sup> / <sub>16</sub> x 1 <sup>7</sup> / <sub>8</sub>

\* Closed construction    □ Impedance protected    † Has hubs for end rings

NOTE: Rotation is determined by looking at shaft end. Shaft length is measured from motor face.

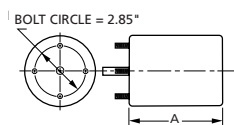

Products on this page are NOT SUITABLE for unattended equipment unless indicated by ► symbol. See inside back cover for additional information.

See pages 48 through 71 for OEM direct replacement models.



**Fig. A D540, D541**



**Fig. B D1162**



**Fig. C D122, D123, D124, D125, D182, D601, D602, D624**



**Fig. D D137**



**Fig. E D636**



**Fig. F D534**



**Fig. G D503**



**Fig. I D1164**



**Fig. K D132, D133, D186, D188, D189**



**Fig. M D1118**



**Fig. H D109**



**Fig. J D1161**



**Fig. L D1109**



**Fig. N D1139**

### SHADED POLE AND PSC • OPEN VENTILATION • AIR-OVER

H.P.	Volts	Amps	RPM	Rot.	Model	Fig.	"A" Dim.	Shaft Dim.
1/25	230	.69	1500	D.S.	D636	E	3 1/4	2 1/4 x 5/16 x 2 1/4
1/20	115	1.8	1500	C.W.	D132	K	2 3/4	5/16 x 2 1/4
1/20	115	1.8	1500	CCW.	D133	K	2 3/4	5/16 x 2 1/4
1/20	230	.9	1500	C.W.	D188	K	2 7/8	5/16 x 2 1/4
1/20	230	.9	1500	CCW.	D189	K	2 7/8	5/16 x 2 1/4
1/20	460	.4	1500	C.W.	D186	K	2 7/8	5/16 x 2 1/3
1/15	115	2.1	1600	C.W.	D109	H	3	5/16 x 3
1/15-1/25	115	2.9-1.9	1500	CCW.	D1161	J	4 1/4	5/16 x 2
1/10	230	.95	1500	Rev.	D503#	G	4 5/8	5/16 x 3 3/4

# PSC motor

### SHADED POLE MOTORS OPEN AND TOTALLY ENCLOSED • AIR-OVER

H.P.	Volts	Amps	RPM	Rot.	Model	Fig.	Const.	"A" Dim.	Shaft Dim.
1/100	115	.6	1500	C.W.	D540	A	Closed	2 1/8	1/4 x 2 1/4
1/100	115	.6	1500	C.C.W.	D541	A	Closed	2 1/8	1/4 x 2 1/4
1/100	115	.65	1500	C.C.W.	D1109	L	Closed	2 1/16	1/4 x 1 1/4
1/100	115	.6	1500	Rev.	D1162	B	Open	3 1/2	5/16 x 1
1/80	115	.6	1500	C.W.	D122	C	Closed	2 1/8	1/4 x 2 1/4
1/80	115	.6	1500	CCW.	D123	C	Closed	2 1/8	1/4 x 2 1/4
1/60	115	.6	1500	C.W.	D182	C	Closed	2 3/4	5/16 x 2 1/4
1/50	115	.75	1500	C.W.	D124	C	Closed	2 1/2	1/4 x 2 1/4
1/50	115	.75	1500	CCW.	D125	C	Closed	2 1/2	1/4 x 2 1/4
1/50	115	.9	1500	C.C.W.	D601	C	Closed	2 3/16	1/4 x 2 3/8
1/50	115	.9	1500	C.W.	D602	C	Closed	2 3/16	1/4 x 2 3/8
1/50	230	.4	1500	C.W.	D624	C	Closed	2 1/2	1/4 x 2 1/4
1/50-1/80-	115	.9-.6-.5	1500	C.W.	D1139	N	Closed	2 13/16	2 1/2 x 5/16 x 1 1/8
1/35-1/100	115	1.4-.5	1500	C.W.	D534	F	Closed	2 1/2	1/4 x 1
1/30-1/65	115	1.0-.7	1500	D.S.	D137	D	Closed	2 7/8	3 x 5/16 x 3
1/30	240	.6	1500	C.W.	D1118	M	Closed	2 13/16	5/16 x 3 1/2
1/25	115/230	1.3/.65	1500	C.W.	D1164	I	Closed	3 1/8	5/16 x 2 1/2

■ Impedance protected • Ball bearing motor

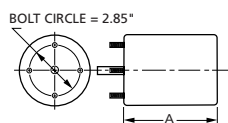

Products on this page are NOT SUITABLE for unattended equipment unless indicated by ► symbol. See inside back cover for additional information.

See pages 48 through 71 for OEM direct replacement models.

# 3.3" DIAMETER



## Refrigeration Fan Motors



Fig. A D429, D437

### UNIT BEARING REPLACEMENT

- Mounting bracket designed to match the original motor (four 8-36 drilled and tapped holes).
- Mounting hardware included with all models.
- All motor lengths were designed to match replacing unit.
- All motors have 22" leads with 1/64" thick insulation
- Rotation is as viewing motor shaft end.
- Three studs all opposite shaft end are 8-32 on a standard 2.84" bolt circle, 120° apart.

SHADED POLE • 1550 RPM • HUBLESS FAN TYPE							
Watts	Volts	Amps	Rot.	Model	Fig.	"C" Dim.	Cross Reference
9	115	.6	C.C.W.	D429	A	3	GE 5411
16	115	1.1	C.C.W.	D437	A	3 7/32	GE 5811

**IMPORTANT NOTE:** These motors often replace unit bearing motors whose rotation is described *opposite* shaft end. This is different from Fasco standard, which is determined by looking at shaft end.



Fig. B D470, D471, D472, D473, D477

- 115, 208-230 and 460 VAC models
- Thermally protected
- 3.9" Diameter
- Extended hubs with rubber rings for base mount
- UL recognized
- Interchangeable with G.E. 11 Frame refrigeration motors
- 1/2" studs for mounting

SHADED POLE • OPEN VENTILATION • SELF COOLED									
H.P.	Volts	Amps	RPM	Rot.	Model	Fig.	"A" Dim.	Shaft Dim.	Cross Reference
1/35	208-230	.75	1550	CCW.	D477	B	4 1/4	5/16 x 1 5/8	GE 1432
1/20	208/230	1.1	1550	CCW.	D471	B	4 1/4	5/16 x 2 1/2	GE 1332
1/20	208/230	.94	1550	C.W.	D470	B	4 1/4	5/16 x 2 5/8	GE 1342
1/20	115	1.9	1550	C.W.	D472	B	4 1/4	5/16 x 2 5/8	GE 1341
1/20	115	2.0	1550	CCW.	D473	B	4 1/4	5/16 x 2 5/8	GE 1331
1/15	460	.6	1550	C.C.W.	D475*†	C	4 1/2	5/16 x 2 1/2	*
1/15	460	.5	1550	C.W.	D498†	C	4 1/2	5/16 x 2 1/2	—
1/12	208/230	1.3	1550	C.C.W.	D469	D	4 1/3	5/16 x 2 1/8	GE 1232

\* See Tecumseh OEM section (page 68) for cross references

† Do not have extended hubs or rubber rings for base mount

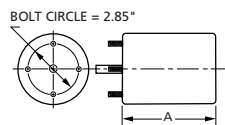
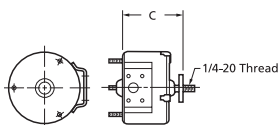

Fig. C D475, D498



Fig. D D469

**NOTE:** Rotation is determined by looking at shaft end. Shaft length is measured from motor face.



Products on this page are NOT SUITABLE for unattended equipment unless indicated by ► symbol. See inside back cover for additional information.

See pages 48 through 71 for OEM direct replacement models.



Fig. A D1125



Fig. B D1124, D1126



Fig. C D1101, D1103, D1152, D1154



Fig. D D1142



Fig. E D1144



Fig. F D1164



Fig. G D1120, D1121



Fig. H D1243, D1245

NEW  
NEW

NEW

BOHN*							
EVAPORATOR COIL AND REFRIGERATOR FAN MOTORS							
H.P.	Volts	Amps	RPM	Model	Fig.	"A" Dim.	Shaft Dim.
1/20	115	2.1	1550	D1124*#	B	3	5/16 X 3
1/15	230	1.1	1550	D1126*#	B	3 1/2	5/16 X 3
1/15	208-230	.4	1550	D1125▲†	A	3 3/4	5/16 X 2 5/8
KEEPRITE							
C.C.W. ROT. • EVAPORATOR COIL AND REFRIGERATOR FAN MOTORS SHADED POLE							
1/20	115	2.1	1550	D1120	G	3 1/2	5/16 X 2 1/2
1/20	208-230	1.0	1550	D1121	G	3 1/2	5/16 X 2 1/2
1/20	115	.8	1550	D1243	H	4 1/8	5/16 X 2 3/4
1/20	230	.4	1550	D1245	H	4	5/16 X 2 3/4
KRAMER-TRENTON							
C.W. ROT. • EVAPORATOR COIL AND REFRIGERATION FAN MOTORS SHADED POLE							
1/20	115	2.1	1500	D1152	C	2 7/8	5/16 X 2 3/8
1/20	230	1.0	1500	D1154	C	3 1/8	5/16 X 2 3/8
LARKIN COIL							
C.C.W. ROT. • EVAPORATOR COIL AND REFRIGERATOR FAN MOTORS SHADED POLE							
1/20	115	1.9	1550	D1101^	C	2 3/4	5/16 X 2 1/4
1/20	208-230	1.15	1550	D1103^	C	3	5/16 X 2 1/4
McQUAY							
C.W. ROT. • EVAPORATOR COIL AND REFRIGERATION FAN MOTORS							
1/25-1/35-1/65	115	1.1-.9-.6	1200	D1144+■	E	4 3/4	3/8 X 5 5/8
1/15	115/230	1.7/1.9	1500	D1142†**	D	3 1/2	5/16 X 2 1/2
SINGER							
C.W. ROT. • EVAPORATOR COIL AND REFRIGERATION FAN MOTORS SHADED POLE							
1/25	115/230	1.3/.65	1550	D1164	F	3 1/8	5/16 X 2 1/2
WITT							
C.W. ROT. • EVAPORATOR COIL AND REFRIGERATION FAN MOTORS SHADED POLE							
1/20	115/230	.75/0.4	1550	D1102	I	3 1/2	5/16 X 2 5/8

\* Special low temperature oil. ▲ Includes 4M 370V capacitor, PSC Motor  
 # C.W. † C.C.W. ^ Special low temperature oil. + PSC use 4M370V capacitor  
 † Bolt circle = 3.15" ■ P.S.C. \*\* Shaded Pole

NOTE: Rotation is determined by looking at shaft end. Shaft length is measured from motor face.



Fig. I D1102

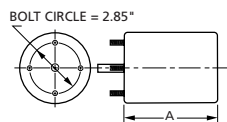

Products on this page are NOT SUITABLE for unattended equipment unless indicated by ▶ symbol. See inside back cover for additional information.

See pages 48 through 71 for OEM direct replacement models.

# 3.3" DIAMETER

## Self Cooled Motors



**Fig. A** D192, D226, D234, D235, D334



**Fig. B** D134, D135, D227



**Fig. C** D138, D238



**Fig. D** D130, D131, D167, D169, D330



**Fig. E** D1138



**Fig. F** D1173



**Fig. G** D504

- 115, 230 and 115/230 VAC Motors
- UL recognized
- Self-cooled for mechanical duty
- Thermally Protected
- CSA certified

SHADED POLE • TOTALLY ENCLOSED SELF COOLED • 3.91" DIA.								
H.P.	Volts	Amps	RPM	Rot.	Model	Fig.	"A" Dim.	Shaft Dim.
1/25-1/80-1/140	115	1.6	1500	C.W.	D134	B	4 1/4	5/16 x 2 1/4
	115	.9-.6-.5	1500	C.W.	D1138+	E	4	5/16 x 2 1/2
	115	1.6	1500	C. C.W.	D135	B	4 1/4	5/16 x 2 1/4
1/25	230	.9	1500	C.W.	D192	A	4 1/4	5/16 x 2 1/4
	115	1.6	1500	C.W.	D226•	A	4 1/4	5/16 x 2 1/4
	115	1.7	1500	C. C.W.	D227•	B	4 1/4	5/16 x 2 1/4
1/15	230	1.4	1500	C.W.	D334•	A	4 3/4	5/16 x 3
	115	2.2	1500	C.W.	D234	A	4 3/4	5/16 x 2 1/4
	115	2.2	1500	C..C.W.	D235	A	4 3/4	5/16 x 2 1/4

• Ball bearing motor + Open ventilated

SHADED POLE • TOTALLY ENCLOSED SELF COOLED • 3.91" DIA.								
H.P.	Volts	Amps	RPM	Rot.	Model	Fig. Dim.	"A" Dim.	Shaft Dim.
1/25	115	1.6	1500	C.W.	D138	C	4 1/2	5/16 x 2 5/8
1/15	115	2.3	1500	C.W.	D238+	C	4 1/2	5/16 x 2 5/8

+ With conduit box

SHADED POLE • OPEN VENTILATION • SELF COOLED								
H.P.	Volts	Amps	RPM	Rot.	Model	Fig. Dim.	"A" Dim.	Shaft
1/70	115	.7	1500	C.W.	D167	D	2 7/8	1/4 x 3
1/70	115	.7	1500	C. C.W.	D169	D	3	1/4 x 3
1/40	115	1.0	1500	C.W.	D130	D	3 1/3	5/16 x 4 1/8
1/40	115	1.0	1500	C.C.W.	D131	D	3 1/3	5/16 x 2 1/4
1/40	230	.5	1500	C.W.	D330	D	3 7/8	5/16 x 2 1/4
1/30	115	1.2	1500	C.W.	D1173•	F	3 7/8	5/16 x 2 1/2
1/8	115/230	1.6/1.8	1500	Rev.	D504*✱	G	5 1/2	5/16 x 3 1/2

• Ball bearing motor

\* This is a PSC motor requiring a 10 MFD 370V cap.

✱ 3.91" Dia. motor

**NOTE:** Rotation is determined by looking at shaft end. Shaft length is measured from motor face.

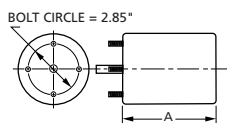

Products on this page are NOT SUITABLE for unattended equipment unless indicated by ► symbol. See inside back cover for additional information.

See pages 48 through 71 for OEM direct replacement models.

- 115 VAC motors
- UL recognized
- Thermally protected
- CSA certified
- Interchangeable with most window air-conditioner motors



**Fig. A D366, D367**



**Fig. B D325**



**Fig. C D323**



**Fig. D D326**



**Fig. E D1176**



**Fig. F D1112**



**Fig. G D1113**



**Fig. H D1111**

SHADED POLE • OPEN VENTILATION • AIR-OVER							
H.P.	Amps	RPM	Rot.	Model	Fig.	"A" Dim.	Shaft Dim.
1/18-1/30	2.4/1.2	1330	C.C.W.	D1111 ■	H	3 1/2	3 1/8 x 5/16 x 2 3/8
1/16-1/25-1/35	1.9-1.6-1.4	1550	D.S.	D1113 ■	G	3 3/8	2 7/16 x 5/16 x 3 1/4
1/14-1/25	2.5-1.5	1550	D.S.	D366	A	3 1/4	6 3/8 x 5/16 x 6 3/8
1/12-1/20-1/30	3.0-2.1-1.7	1550	D.S.	D367	A	3 5/8	5 3/4 x 5/16 x 5 3/4
1/10-1/30	2.5-2.3	1550	C.C.W.	D325 ■	B	3 1/2	1 3/4 x 5/16 x 2 3/8

NOTE: Rotation is determined by looking at shaft end. Shaft length is measured from motor face.

PSC • OPEN AND TOTALLY ENCLOSED • AIR-OVER								
H.P.	Amps	RPM	Rot.	Model	Fig.	Const.	"A" Dim.	Shaft Dim.
1/15-1/25	.9-8	1550	D.S.	D1176#	E	Closed	4	4 7/8 x 3/8 x 4 7/8
1/15-1/20-1/35	1.1-8-6	1550	D.S.	D323+°	C	Closed	3 3/4	2 3/4 x 5/16 x 2 3/4
1/15-1/20-1/25	1.5-1.0-9	1550	C.W.	D1112■°	F	Open	4	2 5/8 x 5/16 x 2 7/8
1/10-1/20-1/25	1.9-1.8-1.5	1550	D.S.	D326†#	D	Open	4 1/8	5 1/2 x 5/16 x 3

- † Wiring slightly different from OEM PSC; check nameplate connection diagram. Capacitor and Bracket included. Replaces 2 and 3 speed shaded pole motor; also 2 and 3 speed PSC. Motor in Gibson/Belding window units.
- + Totally enclosed, Sears-Whirlpool 5000-8000 BTU units.
- ° 3M370V capacitor
- Rotation determined by viewing lug end
- Ball bearing motor
- # 4M 370V capacitor

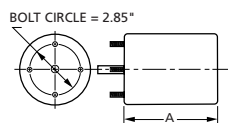

Products on this page are NOT SUITABLE for unattended equipment unless indicated by ► symbol. See inside back cover for additional information.

See pages 48 through 71 for OEM direct replacement models.

# 3.3" DIAMETER



## Flue Exhaust Draft Booster Blower Motors



Fig. A D222



Fig. B D520

- Thermally protected
- UL Recognized
- CSA Certified

SHADED POLE MOTORS TOTALLY ENCLOSED • AIR-OVER • 3.81" DIA.								
H.P.	Volts	Amps	RPM	Rot.	Model	Fig.	"A" Dim.	Shaft Dim.
1/25	115	1.6	1500	D.S.	D222	A	2 <sup>7</sup> / <sub>8</sub>	2 <sup>1</sup> / <sub>4</sub> x 5 <sup>5</sup> / <sub>16</sub> x 2 <sup>1</sup> / <sub>4</sub>

SHADED POLE MOTORS OPEN AND TOTALLY ENCLOSED • AIR-OVER MECHANICALLY REVERSIBLE									
H.P.	Volts	Amps	RPM	Rot.	Model	Fig.	Const.	"A" Dim.	Shaft Dim.
1/20-1/50 1/100	115	2.0-1.0 -.6	1500	C.W.	D520	B	Open	3 <sup>1</sup> / <sub>8</sub>	1/4 x 2 <sup>1</sup> / <sub>4</sub>

NOTE: Rotation is determined by looking at shaft end. Shaft length is measured from motor face.



Endshield on D520 is easily removed, allowing rotor and shaft to be rotated, thereby reversing motor rotation.



Fig. C D410, D412



Fig. D D1184, D1186

- Thermally protected
- UL Recognized
- CSA Certified

PSC • OPEN VENTILATION								
H.P.	Volts	Amps	RPM	Rot.	Model	Fig.	"A" Dim.	Shaft Dim.
1/16	460	.3	3450	C.C.W.	D1186#•	D	4 <sup>3</sup> / <sub>4</sub>	5 <sup>1</sup> / <sub>16</sub> x 3 <sup>1</sup> / <sub>3</sub>
1/16	460	.3	3450	C.C.W.	D1184#•■	D	4 <sup>3</sup> / <sub>4</sub>	5 <sup>1</sup> / <sub>16</sub> x 3 <sup>1</sup> / <sub>3</sub>
1/10	115	1.5	3000	Rev.	D410✓•†^	C	7 <sup>1</sup> / <sub>8</sub>	1/4 x 3 <sup>3</sup> / <sub>4</sub>
1/9	230	.7	3000	Rev.	D412#•†^	C	6 <sup>5</sup> / <sub>8</sub>	1/4 x 3 <sup>3</sup> / <sub>4</sub>

- ✓ 7.5M 370V capacitor
- # 4M 370V capacitor
- Ball bearing motor
- Has Hall Effect sensor
- † Motors include shaft bushing
- ^ Motors have stainless steel shaft

NOTE: Rotation is determined by looking at shaft end. Shaft length is measured from motor face.

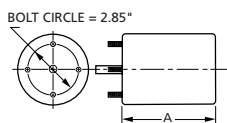

Products on this page are NOT SUITABLE for unattended equipment unless indicated by symbol. See inside back cover for additional information.

See pages 48 through 71 for OEM direct replacement models.

- Thermally protected
- UL Recognized
- CSA Certified



**Fig. A D415, D418**



**Fig. B D1191**



**Fig. C D1192**



**Fig. D D1188**



**Fig. E D1196**



**Fig. G D1193**



**Fig. F D1194**



**Fig. H D1198**

SHADED POLE • OPEN VENTILATION								
H.P.	Volts	Amps	RPM	Rot.	Model	Fig.	"A" Dim.	Shaft Dim.
1/50	115	1.1	1550	C.W.	D418•	A	5 1/2	1/4 x 3
1/40	115	1.1	1550	C.C.W.	D415•	A	5 1/2	1/4 x 3
1/40	460	.37	3200	C.C.W.	D1191•	B	5 3/4	1/4 x 2 1/2
1/40	115	.7	3000	C.C.W.	D1192	C	5 1/3	5/16 x 1 1/2
1/33	115	1.5	3200	C.C.W.	D1196	E	3 1/4	5/16 x 2 1/3
1/30	115	1.5	3000	C.C.W.	D1198	H	3 1/8	5/16 x 2 1/3
1/25	115	1.7	3200	C.W.	D1194•	F	5 1/2	5/16 x 1 1/3
1/22	115	1.2	3000	C.C.W.	D1193	G	2 7/8	5/16 x 2 1/3
1/15	208-230/460	1.1/1.6	3000	C.W.	D1188•	D	6 5/8	5/16 x 2

- Ball bearing motor

**NOTE:** Rotation is determined by looking at shaft end. Shaft length is measured from motor face.

All models except D1192 and D1194 have stainless steel shafts.

All models with 1/4" diameter shafts include a shaft bushing.

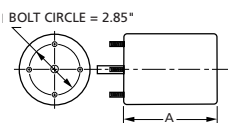

Products on this page are NOT SUITABLE for unattended equipment unless indicated by ► symbol. See inside back cover for additional information.

See pages 48 through 71 for OEM direct replacement models.

# 3.3" DIAMETER



## Flue Exhaust and Draft Booster Blower Motors



**Fig. A D408**



**Fig. B D454**



**Fig. C D455**



**Fig. D D456, D457, D458, D1174, D1171**



**Fig. E D1179, D1180**



**Fig. F D1190**



**Fig. G D1169**



**Fig. H D1167**

- Thermally protected
- UL Recognized
- Supplied with bushings
- CSA Certified
- Supplied with Centrifugal Switch

SHADED POLE • OPEN VENTILATION								
H.P.	Volts	Amps	RPM	Rot.	Model	Fig.	A Dim.	Shaft Dim.
1/150	115	.5	3000	C.W.	D408★	A	5½	¼ x 1½
1/40	208/230	.55	3000	C.C.W.	D1167	H	4⅞	⅝ x 1
1/30	115/230	1.3/1.7	3000	C.C.W.	D455•	C	5⅞	¼ x 3⅞
1/30	115	1.5	3000	C.W.	D454△	B	6⅜	¼ x 1½
1/15	115/230	2.0/1.0	3000	C.W.	D456•#	D	6½	¼ x 2¾
1/15	208/230	1.0	3000	C.W.	D458•#	D	6½	¼ x 2¾
1/15	115/230	2.0/1.0	3000	C.C.W.	D457•#	D	6½	¼ x 2¾
1/15	460	.6	3000	C.W.	D1174•	D	6¾	¼ x 2½
1/15	460	.6	3000	C.C.W.	D1171•	D	6⅞	¼ x 2½
1/10	208-230	1.5	3000	C.C.W.	D1169	G	5¾	⅝ x 1

★ Drilled & Tapped Holes (No. 8-32NC) in face of case at shaft end for mounting in various Coleman mobile home furnace applications, also has mounting studs.

▲ Used in Economite, "E-20", LS1/Miller and Mid Continent gas units.

- Ball bearing motor
- # Stainless steel shafts

All models with ¼" diameter shafts include a shaft bushing.

**NOTE:** Rotation is determined by looking at shaft end. Shaft length is measured from motor face.

- Thermally protected
- UL Recognized
- CSA Certified

SHADED POLE • OPEN VENTILATION								
H.P.	Volts	Amps	RPM	Rot.	Model	Fig.	A Dim.	Shaft Dim.
1/30	115	1.5	3000	C.W.	D1179#	E	3½	⅝ x 2⅞
1/30	115	1.6	3300	C.W.	D1190#	F	4⅞	⅝ x 1¾
1/20	115	1.5	3300	C.W.	D1180#	E	3⅝	⅝ x 2⅞

# Stainless steel shafts

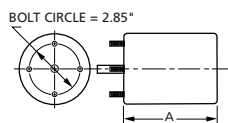

Products on this page are NOT SUITABLE for unattended equipment unless indicated by ► symbol. See inside back cover for additional information.

See pages 48 through 71 for OEM direct replacement models.