

5.6" DIAMETER

Condenser Fan Motors



Fig. A D735, D737, D739



Fig. B D747, D748, D937



Fig. C D745, D749, D929, D935, D939



Fig. D D930, D951



Fig. E D719, D720



Fig. F D7745



Fig. G D7748



Fig. H D7749



Fig. I D1709

SHAFT UP OR HORIZONTAL

- 208-230 VAC
- Electrically reversible
- Thermally protected
- UL recognized
- CSA certified
- All angle mount bearings
- Includes shaft water slinger
- Closed end shield shaft end
- 60° ambient temperature rating

PSC • OPEN VENTILATION • AIR-OVER								
H.P.	Volts	Amps	RPM	Load Factor	Model	Fig.	"A" Dim.	Shaft Dim.
1/5	208-230	1.5	1075	1.2	D720	E	3 ³ / ₄	1/2 x 6
1/5-1/8	208-230	1.3-.8	1075	1.2	D719	E	3 ³ / ₄	1/2 x 6 ¹ / ₂
1/4	208-230	1.7	1075	1.3	D7749*	H	3 ³ / ₄	1/2 x 6 ¹ / ₂
1/4	208-230	1.8	1075	1.3	D749	C	3 ³ / ₄	1/2 x 6 ¹ / ₂
1/4	208-230	2.1	1075	1.3	D939*	C	4	1/2 x 6
1/4-1/6	208-230	2.0-1.3	1075	1.2	D739*	A	4 ¹ / ₄	1/2 x 6
1/3	208-230	2.5	1075	1.4	D747	B	4 ³ / ₄	1/2 x 6
1/3	208-230	2.9	1075	1.2	D937*	B	4	1/2 x 6 ¹ / ₂
1/3	208-230	2.9	1075	1.2	D7748*	G	4 ¹ / ₄	1/2 x 6 ¹ / ₂
1/3	208-230	2.9	1075	1.2	D748	B	4 ¹ / ₄	1/2 x 6 ¹ / ₂
1/3-1/4	208-230	3.5-1.9	1075	1.3	D737*	A	4 ¹ / ₂	1/2 x 6
1/2	208-230	4.1	1075	1.2	D935*★	C	5	1/2 x 6 ¹ / ₂
1/2	208-230	3.7	1075	1.2	D7745*★	F	4 ³ / ₄	1/2 x 6 ¹ / ₂
1/2	208-230	3.7	1075	1.2	D745*	C	4 ³ / ₄	1/2 x 6 ¹ / ₂
1/2-1/3	208-230	4.4-2.7	1075	1.3	D735*+	A	5 ¹ / ₄	1/2 x 6
3/4	208-230	5.0	1075	1.0	D929*	C	5 ¹ / ₄	1/2 x 6 ¹ / ₄
3/4-1/3	208-230	4.4-2.1	1075	1.1	D930*#	D	5 ¹ / ₄	1/2 x 6 ¹ / ₄
3/4-1/3	208-230	5.0-2.2	1075	1.3	D951*#	D	5 ¹ / ₄	5/8 x 4 ¹ / ₂ (Keyed)
1	208-230	5.5	1075	1.1	D1709†*#	I	5 ¹³ / ₁₆	1/2 x 6 ¹ / ₂

• Ball bearing motor +7.5M 370V capacitor #15M 370V capacitor ★ 10M 370V capacitor
 † Open vented on opposite shaft end

SHAFT DOWN OR HORIZONTAL

- 208-230 VAC
- Electrically reversible
- Thermally protected
- UL recognized
- CSA certified
- All angle mount bearings. Use rainshield when necessary
- Sleeve bearing models
- Closed endshield opposite shaft end
- 60° ambient temperature rating



Fig. F D740, D742, D743, D744, S719, D944

PSC • OPEN VENTILATION • AIR-OVER								
H.P.	Volts	Amps	RPM	Load Factor	Model	Fig.	"A" Dim.	Shaft Dim.
1/5-1/8	208-230	1.3-.8	1075	1.2	S719^	F	3 ³ / ₄	1/2 x 6 ¹ / ₂
1/5	208-230	1.2	1075	1.0	D743^	F	3 ¹ / ₂	1/2 x 6
1/4	208-230	2.1	1075	1.3	D742^	F	4	1/2 x 6
1/3	208-230	2.9	1075	1.4	D944	F	4 ¹ / ₄	1/2 x 6
1/3-1/4	208-230	3.2-2.4	1075	1.3	D744	F	4 ³ / ₄	1/2 x 6 ¹ / ₂
1/2	208-230	4.5	1075	1.3	D740	F	5	1/2 x 6 ¹ / ₂

^ Has 4 drilled and tapped holes in shell

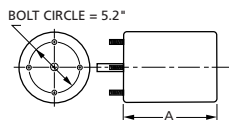

Products on this page are NOT SUITABLE for unattended equipment unless indicated by ▶ symbol. See inside back cover for additional information.

See pages 48 through 71 for OEM direct replacement models.

PSC motors use 5M 370V capacitors unless otherwise indicated.