

# 5.6" DIAMETER

## Condenser Fan Motors



**Fig. A** D903, D904, D905, D1700, D1701, D1702



**Fig. B** D906, D907, D908, D909, D917, D919, D922, D925, D931, D932, D933



**Fig. C** D7907, D7908, D7909

### TOTALLY ENCLOSED MOTORS

- Ideal for any angle mounting
- 208-230 and 230 VAC models
- Electrically reversible
- Thermally protected
- UL recognized
- CSA certified
- All angle mount bearings
- Ball bearing and sleeve bearing models
- 60° ambient temperature rating

PSC • TOTALLY ENCLOSED • AIR-OVER								
H.P.	Volts	Amps	RPM	Fig.	Load Factor	Model	"A" Dim.	Shaft Dim.
1/8	208-230	.9	1075	B	1.3	D919 <sup>^</sup>	3 <sup>3</sup> / <sub>4</sub>	1/2 x 6 <sup>1</sup> / <sub>2</sub>
1/6-1/8	208-230	1.2-.9	1075	A	1.2	D905	3 <sup>3</sup> / <sub>4</sub>	1/2 x 6 <sup>1</sup> / <sub>2</sub>
1/6	208-230	1.0	1075	B	1.2	D917 <sup>^</sup>	3 <sup>3</sup> / <sub>4</sub>	1/2 x 6 <sup>1</sup> / <sub>2</sub>
1/5	208-230	1.5	1075	B	1.2	D906 <sup>^</sup>	4	1/2 x 6 <sup>1</sup> / <sub>2</sub>
1/4-1/5	208-230	1.8-1.0	1075	A	1.4	D904	4 <sup>1</sup> / <sub>4</sub>	1/2 x 6 <sup>1</sup> / <sub>2</sub>
1/4-1/8	208-230	1.7-.8	1075	A	1.1	D1702 <sup>•</sup>	4	1/2 x 6
1/4	208-230	1.8	1075	B	1.3	D922 <sup>†</sup>	4 <sup>1</sup> / <sub>3</sub>	1/2 x 6 <sup>1</sup> / <sub>2</sub>
1/4	208-230	1.8	1075	C	1.2	D7909 <sup>•^</sup>	4	1/2 x 6 <sup>1</sup> / <sub>2</sub>
1/4	208-230	1.8	1075	B	1.2	D909 <sup>^</sup>	4	1/2 x 6 <sup>1</sup> / <sub>2</sub>
1/3-1/4	208-230	2.7-1.3	1075	A	1.3	D903 <sup>+</sup>	4 <sup>3</sup> / <sub>4</sub>	1/2 x 6 <sup>1</sup> / <sub>2</sub>
1/3-1/4	208-230	2.2-1.3	1075	A	1.1	D1701 <sup>•+</sup>	5	1/2 x 5 <sup>1</sup> / <sub>2</sub>
1/3	208-230	2.7	1075	B	1.6	D925 <sup>†+</sup>	4 <sup>3</sup> / <sub>4</sub>	1/2 x 6 <sup>1</sup> / <sub>2</sub>
1/3	208-230	2.6	1075	C	1.2	D7908 <sup>•+^</sup>	4 <sup>1</sup> / <sub>2</sub>	1/2 x 6 <sup>1</sup> / <sub>2</sub>
1/3	208-230	2.4	1075	B	1.2	D908 <sup>+^</sup>	4 <sup>1</sup> / <sub>2</sub>	1/2 x 6 <sup>1</sup> / <sub>2</sub>
1/2-1/3	208-230	3.7-1.9	1075	A	1.1	D1700 <sup>•+</sup>	5	1/2 x 5 <sup>1</sup> / <sub>2</sub>
1/2	208-230	3.9	1075	B	1.5	D932 <sup>†*</sup>	5 <sup>5</sup> / <sub>8</sub>	1/2 x 6 <sup>1</sup> / <sub>2</sub>
1/2	208-230	3.7	1075	C	1.2	D7907 <sup>•*</sup>	5	1/2 x 6 <sup>1</sup> / <sub>2</sub>
1/2	208-230	3.7	1075	B	1.2	D907 <sup>*</sup>	4 <sup>3</sup> / <sub>4</sub>	1/2 x 6 <sup>1</sup> / <sub>2</sub>
3/4	208-230	5	1075	B	1.3	D933 <sup>†■</sup>	5 <sup>3</sup> / <sub>4</sub>	1/2 x 6 <sup>1</sup> / <sub>2</sub>
3/4	208-230	4.5	1075	B	1.2	D931 <sup>•■</sup>	5 <sup>1</sup> / <sub>4</sub>	1/2 x 6 <sup>1</sup> / <sub>2</sub>

+ 7.5M 370V capacitor    ★ 10M 370V capacitor    • Ball bearing motor  
 ■ 15M 370V capacitor    † Motor has increased stack for higher ambient temperatures.  
 ^ Has 4 drilled and tapped holes in shell

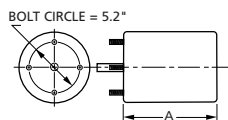

Products on this page are NOT SUITABLE for unattended equipment unless indicated by ► symbol. See inside back cover for additional information.

See pages 48 through 71 for OEM direct replacement models.

PSC motors use 5M 370V capacitors unless otherwise indicated.