

5.6" DIAMETER



Condenser Fan Motors



Fig. A D2710, D2713, D2714



Fig. B D2711



Fig. C D2712, D2715, D2720, D2721



Fig. D D2729

200-575 VAC FAN SHELTERED MOTORS

- Thermally protected
- Ideal for shaft up applications
- 60° ambient temperature rating
- Ball bearings
- Electrically reversible

NEW
NEW
NEW
NEW
NEW
NEW

PSC • OPEN VENTILATION • AIR OVER								
H.P.	Volts	Amps	RPM	Load Factor	Model	Fig.	"A" Dim.	Shaft Dim.
.4	200-230/460	3.2/1.6	1075	1.0	D2710•	A	5 1/4	1/2 x 5 1/2
.6	200-230/460	4.0/2.0	1075	1.0	D2711•	B	6 3/4	1/2 x 5 1/2
.6	200-230/460	4.0/2.0	1075	1.0	D2712•	C	6 3/4	5/8 x 5 1/2 Keyed
.6	575	1.5	1075	1.0	D2713•	A	7	1/2 x 5 1/2
.8	200-230/460	4.6/2.3	1075	1.2	D2714•	A	8	1/2 x 5 1/2
.8	200-230/460	4.6/2.3	1075	1.2	D2715•	C	8	5/8 x 5 1/2 Keyed
1/2	200-230/460	4.6/2.3	1075	1.5	D2729•	D	6 1/4	1/2 x 3 1/2

- Ball bearing motor

3 PHASE MOTORS

NEW
NEW

3 PHASE • OPEN VENTILATION • AIR OVER								
H.P.	Volts	Amps	RPM	Load Factor	Model	Fig.	"A" Dim.	Shaft Dim.
3/4	200-230	3.0	1140	1.1	D2720•	C	8	5/8 x 5 7/8 Keyed
3/4	460	1.5	1140	1.1	D2721•	C	8	5/8 x 5 7/8 Keyed

- Ball bearing motor

575 VAC MOTORS

- Thermally protected
- Ideal for shaft up applications
- 60° ambient temperature rating
- Ball bearings
- Electrically reversible

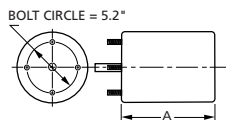

Fig. E D2750, D2751, D2752, D2753,

NEW
NEW
NEW
NEW

PSC • TOTALLY ENCLOSED • AIR OVER								
H.P.	Volts	Amps	RPM	Load Factor	Model	Fig.	"A" Dim.	Shaft Dim.
1/2	575	1.0	1625	1.4	D2750•	E	5	1/2 x 6 1/2
1/3	575	.75	1100	1.3	D2751•	E	5 1/4	1/2 x 6 1/2
1/2	575	1.1	1075	1.2	D2752•	E	5 1/2	1/2 x 6 1/2
3/4	575	1.8	1075	1.3	D2753•	E	6	1/2 x 6 1/2

- Ball bearing motor



Products on this page are NOT SUITABLE for unattended equipment unless indicated by ► symbol. See inside back cover for additional information.

See pages 48 through 71 for OEM direct replacement models.

PSC motors use 5M 370V capacitors unless otherwise indicated.