



**Fig. A** D116, D118, D170, D310, D374, D377, D674



**Fig. B** D174



**Fig. C** D112, D312, D435



**Fig. D** D1170



**Fig. E** D1039



**Fig. F** D1061



**Fig. G** D119

- 115 and 230 VAC models
- Thermally protected
- UL recognized
- CSA certified

SHADED POLE • OPEN VENTILATION • AIR-OVER									
H.P.	Volts	Amps	RPM	Rot.	Model Dim.	Fig.	"A"	Shaft Dim.	
▶ 1/20-1/30-1/60	115	2.0-1.7- 1.4	1500	C.C.W.	D1061■	F	4 1/8	1/2 x 2 3/4	
▶ 1/20	115	1.7	1500	C.W.	D170†	A	2 3/4	5/16 x 2 1/4	
▶ 1/15	115	2.4	1500	C.W.	D116	A	3	3/8 x 2 3/8	
▶ 1/15-1/30	115	2.4-1.4	1500	C.W.	D118	A	3	3/8 x 2 3/8	
▶ 1/15	115	2.1	1500	C.W.	D1170•✓	D	4 3/4	3/8 x 2 1/2	
▶ 1/12	115	3.1	1500	C.C.W.	D377*	A	2 3/4	3/8 x 2	
▶ 1/12	115	4.0	1500	C.W.	D310★	A	2 3/4	3/8 x 2	
▶ 1/11-1/25-1/70	115	2.9-1.5-1.0	1500	C.C.W.	D119•#	G	3 3/4	1/2 x 2 5/8	
▶ 1/10	115	3.5	1500	C.W.	D174	B	3 3/8	3/8 x 2 1/8	
▶ 1/10-1/15	230	2.0-1.3	1500	C.W.	D674	A	3 3/8	3/8 x 2 1/2	
▶ 1/10	115	3.1	1500	C.C.W.	D1039‡	E	4 1/2	1/2 x 2 3/8	
▶ 1/8-1/20	115	4.0-2.5	1500	C.W.	D374	A	3 5/8	3/8 x 2 1/2	

- Ball bearing motor
- \* Used in Jenn Air units. P/N 7108-2101
- ★ Used in Leslie Locke ventilators original P/N 7108-5056
- ✓ OEM direct replacement for Jenn Air 80CR.
- # Used in Acme Eng. Roof Vents.
- ‡ ILG ventilator 7108-2171. Has internal fan.
- For use with Greenheck Fan
- † Shaft stepped down from 3/8" dia. shaft.

SHADED POLE • OPEN VENTILATION SELF COOLED FOR MECHANICAL DUTY									
H.P.	Volts	Amps	RPM	Rot.	Model	Fig. Dim.	"A" Dim.	Shaft Dim.	
1/15	115	2.7	1500	C.W.	D312+	C	4 1/4	1/2 x 5	
1/10	115	3.6	1500	C.W.	D112	C	4 1/2	3/8 x 2 5/8	
1/10	230	1.7	1500	C.C.W.	D435	C	4 1/2	3/8 x 2 5/8	

+ External oil retainer to accommodate resilient rings and cradle base, drilled and tapped holes in case for mounting in Coleman applications. (2 holes each end on case OD).

**NOTE:** Rotation is determined by looking at shaft end. Shaft length is measured from motor face.

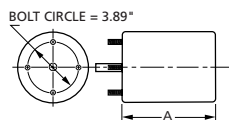

Products on this page are NOT SUITABLE for unattended equipment unless indicated by ▶ symbol. See inside back cover for additional information.

See pages 48 through 71 for OEM direct replacement models.

# 4.4" DIAMETER



## Fan Coil Air-Conditioning and Heating Unit Motors

- 115, 230 and 115/230 VAC models
- Thermally protected
- Interchangeable with most fan coil air-conditioning or heating units and unit heaters



Fig. A D117



Fig. B D236, D336, D337, D338, D339, D635



Fig. C D329



Fig. D D333



Fig. E D113, D114, D115



Fig. F D335



Fig. G D1006

SHADED POLE • OPEN VENTILATION • AIR-OVER									
H.P.	Volts	Amps	RPM	Rot.	Model	Fig.	"A" Dim.	Shaft Dim.	
1/25	115	1.4	1550	D.S.	D333	D	2 <sup>7</sup> / <sub>8</sub>	7 <sup>1</sup> / <sub>4</sub> x <sup>3</sup> / <sub>8</sub> x 7 <sup>1</sup> / <sub>4</sub>	
1/20-1/30-1/40-1/60	115	2.1-1.4-1.2-1.1	1550	D.S.	D335	F	3 <sup>1</sup> / <sub>4</sub>	8 x <sup>1</sup> / <sub>2</sub> x 8	
1/15-1/25-1/30-1/40	115	2.4-1.4-1.1-.9	1550	C.C.W.	D117	A	3	1 <sup>1</sup> / <sub>2</sub> x 7 <sup>1</sup> / <sub>2</sub>	
1/15	115	2.5	1550	D.S.	D329	C	3 <sup>3</sup> / <sub>8</sub>	7 <sup>1</sup> / <sub>2</sub> x <sup>3</sup> / <sub>8</sub> x 7 <sup>1</sup> / <sub>2</sub>	
1/10-1/15-1/25	115	3.5-2.4-1.8	1550	D.S.	D236	B	3 <sup>3</sup> / <sub>8</sub>	7 <sup>1</sup> / <sub>2</sub> x <sup>1</sup> / <sub>2</sub> x 7 <sup>1</sup> / <sub>2</sub>	
1/10-1/15-1/25	115	3.5-2.4-1.8	1550	D.S.	D336	B	3 <sup>1</sup> / <sub>2</sub>	7 <sup>1</sup> / <sub>2</sub> x <sup>3</sup> / <sub>8</sub> x 7 <sup>1</sup> / <sub>2</sub>	
1/10-1/20-1/35	230	1.8-1.3-1.0	1550	D.S.	D635	B	3 <sup>3</sup> / <sub>8</sub>	10 x <sup>1</sup> / <sub>2</sub> x 10	
1/8-1/10-1/12-1/15	115	4.1-2.7-2.3-1.9	1550	D.S.	D337	B	3 <sup>3</sup> / <sub>8</sub>	7 <sup>1</sup> / <sub>2</sub> x <sup>1</sup> / <sub>2</sub> x 7 <sup>1</sup> / <sub>2</sub>	
1/8-1/12	230	2.0-1.4	1550	D.S.	D339	B	4 <sup>1</sup> / <sub>8</sub>	6 <sup>1</sup> / <sub>2</sub> x <sup>1</sup> / <sub>2</sub> x 6 <sup>1</sup> / <sub>2</sub>	
1/6-1/10-1/12-1/15	115	5.4-3.2-2.5-2.1	1550	D.S.	D338	B	4 <sup>1</sup> / <sub>8</sub>	7 <sup>1</sup> / <sub>4</sub> x <sup>1</sup> / <sub>2</sub> x 7 <sup>1</sup> / <sub>4</sub>	
1/4	115	7.2	1600	C.W.	D1006	G	4 <sup>1</sup> / <sub>8</sub>	1 <sup>1</sup> / <sub>2</sub> x 2 <sup>3</sup> / <sub>4</sub>	

NEW

NOTE: Rotation is determined by looking at shaft end. Shaft length is measured from motor face.

SHADED POLE • TOTALLY ENCLOSED • AIR-OVER • UNIT HEATERS									
H.P.	Volts	Amps	RPM	Rot.	Model	Fig.	"A" Dim.	Shaft Dim.	
▶ 1/12	115/230	2.5/1.3	1550	C.C.W.	D113	E	4 <sup>1</sup> / <sub>8</sub>	<sup>3</sup> / <sub>8</sub> x 3	
▶ 1/12	115/230	2.5/1.3	1550	C.W.	D114	E	4 <sup>1</sup> / <sub>8</sub>	<sup>3</sup> / <sub>8</sub> x 3	
▶ 1/12	115/230	2.5/1.3	1550	C.C.W.	D115	E	4 <sup>1</sup> / <sub>8</sub>	1 <sup>1</sup> / <sub>2</sub> x 2	

NOTE: Rotation is determined by looking at shaft end. Shaft length is measured from motor face.

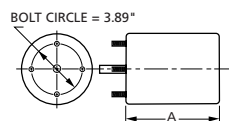

Products on this page are NOT SUITABLE for unattended equipment unless indicated by ▶ symbol. See inside back cover for additional information.

See pages 48 through 71 for OEM direct replacement models.

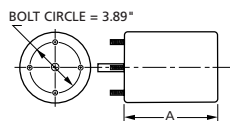

**Fig. A D480, D481, D482, D483, D484, D485**

- 4.4" Diameter
- 115/208-230 VAC
- Thermally protected
- UL recognized
- CSA certified
- Mechanically reversible
- 3/8" shaft diameter with adapter to convert to 1/2" diameter
- Weld nuts on a 3.5" B.C. for stud mount
- Extended hubs with rubber rings for base mount
- Interchangeable with G.E. 21 and 29 Frame motors and other Emerson, Universal and Franklin refrigeration motors

SHADED POLE • OPEN VENTILATION • SELF-COOLED									
H.P.	Volts	Amps	RPM	Rot.	Model	Fig.	"A" Dim.	Shaft Dim.	Cross Reference
1/20	115/208-230	2.2/1.1	1550	C.W.	D484	A	4	3/8 x 3 1/8	GE 2341,2342
1/15	115/208-230	3.2/1.6	1550	C.W.	D482	A	4	3/8 x 3 1/8	GE 2241,2242
1/10	115/208-230	4.5/2.2	1550	C.W.	D480	A	4 5/8	3/8 x 3 1/8	GE 2141,2142
1/20	115/208-230	2.2/1.1	1550	C.C.W.	D485	A	4	3/8 x 3 1/8	GE 2331,2332
1/15	115/208-230	3.2/1.6	1550	C.C.W.	D483	A	4	3/8 x 3 1/8	GE 2231,2232
1/10	115/208-230	4.5/2.2	1550	C.C.W.	D481	A	4 5/8	3/8 x 3 1/8	GE 2131,2132

**NOTE:** Rotation is determined by looking at shaft end.  
Can be operated on 50Hz with air-over applications.



Products on this page are NOT SUITABLE for unattended equipment unless indicated by ► symbol. See inside back cover for additional information.

See pages 48 through 71 for OEM direct replacement models.