

5.6" DIAMETER

Window Air Conditioner Motors

FASCO



Fig. A D750, D751, D752, D754, D755, D756, D757, D758, D760, D761, D763, D769

- 208-230, 230 and 115 VAC models
- Thermally protected
- UL recognized
- CSA certified
- All angle mount sleeve bearings
- Hubless end shields for flush mounting
- Extended tie rods
- Ideal versatility using Kit 200 "X" brackets to accommodate various cradle base lengths
- Ideal for lug mounting using lug Kit 55L or 55S

PSC • OPEN VENTILATION • AIR-OVER									
H.P.	Volts	Amps	Rot.	RPM	Ld. Fac.	Model	Fig.	"A" Dim	Shaft Dim.
1/8-1/10-1/15	115	2.3-1.5-1.1	D.S.	1075	1.3	D751	A	3 1/2	7 1/2 x 1/2 x 9
1/8-1/10-1/12	208-230	.9-.6-.5	D.S.	1075	1.3	D750	A	3 3/4	7 1/2 x 1/2 x 9
1/6-1/8-1/10	115	2.7-2.1-1.7	D.S.	1075	1.1	D754	A	3 1/2	7 1/2 x 1/2 x 9
1/6-1/8-1/10	208-230	1.4-.9-.5	D.S.	1075	1.3	D752	A	3 1/2	7 1/2 x 1/2 x 9
1/4-1/6-1/8	115	4.6-3.1-2.7	D.S.	1075	1.0	D756	A	4	10 x 1/2 x 10
1/4-1/6-1/8	208-230	2-1.4-1.2	D.S.	1075	1.2	D755	A	4	7 1/2 x 1/2 x 8 1/2
1/3-1/4-1/6	115	6.9-4.8-3.8	D.S.	1075	1.2	D757	A	4 1/4	8 1/2 x 1/2 x 8 1/2
1/3-1/4-1/6	208-230	2.3-1.7-1.1	D.S.	1075	1.0	D758	A	4 1/2	8 1/2 x 1/2 x 8 1/2
1/2-1/3-1/4	115	9.0-6.3-4.8	D.S.	1075	1.0	D761	A	5 1/4	8 x 1/2 x 8
1/2-1/3-1/4	208-230	4.3-3.1-2.3	D.S.	1075	1.3	D760	A	5 1/4	8 x 1/2 x 8
3/4-1/2-1/3	115	11.9-8.1-6.0	D.S.	1075	1.1	D769*	A	5 1/2	8 x 1/2 x 8
3/4-1/2-1/3	208-230	5.7-4.1-3.1	D.S.	1075	1.0	D763*	A	5 1/2	8 x 1/2 x 8

*10M 370V capacitor

- Thermally protected
- Electrically reversible
- All angle mount sleeve bearings
- Hubless end shields for flush mounting
- Extended tie rods
- Ideal versatility using Kit 200 "X" bracket to accommodate various cradle base leng
- Ideal for lug mounting using lug Kits 55L or 55S



Fig. B D766

PSC • TOTALLY ENCLOSED • AIR-OVER									
H.P.	Volts	Amps	Rot.	RPM	Ld. Fac.	Model	Fig.	"A" Dim.	Shaft Dim.
1/4-1/6-1/8	230	1.9-1.2-.8	D.S.	1075	1.1	D766	B	4	7 1/2 x 1/2 x 8 1/2

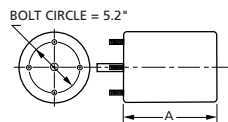

Products on this page are NOT SUITABLE for unattended equipment unless indicated by ► symbol. See inside back cover for additional information.

See pages 48 through 71 for OEM direct replacement models.

PSC motors use 5M 370V capacitors unless otherwise indicated.