

5.6" DIAMETER



Pedestal Fan Motors and Gearmotors



Fig. A D824, D901, D997, D999



Fig. B D900



Fig. C D998



Fig. D V44-36

- 115 and 115/230 VAC models
- Fan motors include pull-chain switches, except D998 and D900
- D998 designed for maximum protection against dirt and moisture

5.6" DIA. • PEDESTAL FAN MOTORS • 1100 RPM PERMANENT SPLIT CAPACITOR							
H.P.	Volts	Amps	Rot.	Model	Fig.	"A" Dim.	Shaft Dim.
1/4-1/8	115	3.2-2.4	Rev.	D824•#^	A	5 ³ / ₄	1/2 x 3 ¹ / ₂
1/3-1/8	115	4.0-3.5	Rev.	D901•^	A	6	1/2 x 3 ¹ / ₂
1/2-1/4	115	7.1-4	Rev.	D997†	A	7 ¹ / ₃	1/2 x 3
1/2-1/4	115	7.1-4	Rev.	D999†	A	7 ¹ / ₃	5/8 x 3
1/2-1/4	115	7.1-4.0	Rev.	D900†	B	7 ¹ / ₄	5/8 x 3

• Ball bearing motor # 4MFD 370V capacitor included
 † 12.5MFD 370V capacitor included ^ Has 10' cordset

POULTRY AND HOG HOUSE FAN MOTOR • 825 RPM AGRICULTURAL APPLICATIONS							
H.P.	Volts	Amps	Rot.	Model	Fig.	"A" Dim.	Shaft Dim.
1/2	115/230	6.0/3.0	C.W.	D998•+□	C	7 ¹ / ₂	5/8 x 2 ⁵ / ₈

+Keyed Shaft •Ball bearing motor ■ No pedestal yoke mount

BULK MILK AGITATOR GEARMOTOR 120 IN LBS.							
H.P.	Volts	Amps	Rot.	Model	Fig.	"A" Dim.	Shaft Dim.
1/12	115/230	1.85/1.0	C.C.W.	V44-36	D	8.9	3/4 x 2 ³ / ₁₆

NOTE: Rotation is determined by looking at shaft end. Shaft length is measured from motor face.

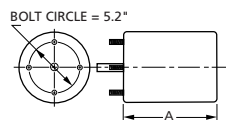

Products on this page are NOT SUITABLE for unattended equipment unless indicated by ► symbol. See inside back cover for additional information.

See pages 48 through 71 for OEM direct replacement models.

PSC motors use 5M 370V capacitors unless otherwise indicated.