

H.P.	Volts	Amps	RPM	Spd.	Model	Fig.	Type	Mtg.	Dia.	Rot.	"A" Dim	Shaft Dia. and Length.	Reference No.
<b>ARKLA</b>													
1/3	115	6.1	825	1	D795	G	PSC	Base Band	5.6	Rev.	5-3/4	1/2 x 6-1/2	Gas Heat Pump K55HX5FN8042
<b>ARMSTRONG</b>													
—	115	1.4	3000	1	A155	L	SP	—	3.3	C.C.W.	—	—	7021-10046
<b>BOHN</b>													
1/20	115	2.1	1550	1	D1124✓	H	SP	Band	3.3	C.W.	3	5/16 x 3	5KSM59JSK143S & 5KSM59JS5036S
1/15	230	1.1	1550	1	D1126✓	H	SP	Band	3.3	C.W.	3-1/2	5/16 x 3	5KSM59LS2262AS
1/15	208-230	.4	1550	1	D1125+	K	PSC	Stud	3.3	C.C.W.	3-3/4	5/16 x 2-5/8	7190-0442
<b>BROAN</b>													
▶ 1" (stack)	115	.9-.7	3000	2	K610	A	SP	Stud	—	C.C.W.	—	.2178 x 1.3"	Motor 30080011 Model Y2-52000
▶ 1" (stack)	115	.8	3000	1	K612	B	SP	Stud	—	C.W.	—	.250 x 2.7	Model 162 (Before 1980)
▶ 3/4" (stack)	115	.7	3000	1	K611	C	SP	Stud	—	C.C.W.	—	.250 x 2.45	Model 162 (After 1980)
1/12	115	2.9	1050	1	D1087	I	SP	Lug	5.1	C.W.	2-5/8	1/2 x 2-1/3	99-08-0178, 7151-3160
1/75	115	.9	3000	1	K110	J	SP	Stud	—	C.C.W.	—	7/32 x 2-13/32	99-08-0165, 670A
<b>BRYANT/CARRIER</b>													
1/3-1/4	230	2.6-2.2	1075	2	D803	D	PSC	Lug	5.6	Rev.	4-1/2	1/2 x 3-1/2	K55HXLKK-5918 HC41VB701
1/30	115	1.5	3000	1	D1179	E	SP	Lug	3.3	C.W.	3-1/2	5/16 x 2	BDP P251-2916 Franklin 8251510360
1/20	115	1.5	3300	1	D1180	E	SP	Lug	3.3	C.W.	3-5/8	5/16 x 2-1/8	Carrier HC27UE120, BDP 398A, BDP P251-2307 U.E. JAIP053N, UE Stock 580
<b>BRYANT/PAYNE</b>													
1/8	208-230	.9	1125	1	D847	F	PSC	Band	5.6	C.C.W.	3-3/4	1/2 x 3-1/2	K1543 HC35VE-230 KA55CGD-9658

✓ Special low-temperature oil

+ Includes 4M 370V capacitor

NOTE: Rotation is determined by looking at shaft end. Shaft length is measured from motor face.



Fig. A K610



Fig. D D803



Fig. G D795



Fig. J K110



Fig. B K612



Fig. E D1179, D1180



Fig. H D1124, D1126



Fig. K D1125



Fig. C K611



Fig. F D847



Fig. I D1087



Fig. L A155

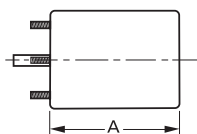

Products on this page are NOT SUITABLE for unattended equipment unless indicated by ▶ symbol. See inside back cover for additional information.

PSC motors use 5M 370V capacitors unless otherwise indicated.