

# 5.6" DIAMETER

## Condenser Fan Motors



**Fig. A D735, D737, D739**



**Fig. B D747, D748, D937**



**Fig. C D745, D749, D929, D935, D939**



**Fig. D D930, D951**



**Fig. E D719, D720**

### SHAFT UP OR HORIZONTAL

- 208-230 VAC
- Electrically reversible
- Thermally protected
- UL recognized
- CSA certified
- All angle mount bearings
- Includes shaft water slinger
- Closed end shield shaft end

NEW

NEW

NEW

PSC • OPEN VENTILATION • AIR-OVER								
H.P.	Volts	Amps	RPM	Load Factor	Model	Fig.	"A" Dim.	Shaft Dim.
1/5	208-230	1.5	1075	1.2	D720	E	3 1/4	1/2 x 6
1/5-1/8	208-230	1.3-.8	1075	1.2	D719	E	3 3/4	1/2 x 6 1/2
1/4	208-230	1.7	1075	1.3	D7749*	H	3 3/4	1/2 x 6 1/2
1/4	208-230	1.8	1075	1.3	D749	C	3 3/4	1/2 x 6 1/2
1/4	208-230	2.1	1075	1.3	D939*	C	4	1/2 x 6
1/4-1/6	208-230	2.0-1.3	1075	1.2	D739*	A	4 1/4	1/2 x 6
1/3	208-230	2.5	1075	1.4	D747	B	4 3/4	1/2 x 6
1/3	208-230	2.9	1075	1.2	D937*	B	4	1/2 x 6 1/2
1/3	208-230	2.9	1075	1.2	D7748*	G	4 1/4	1/2 x 6
1/3	208-230	2.9	1075	1.2	D748	B	4 1/4	1/2 x 6 1/2
1/3-1/4	208-230	3.5-1.9	1075	1.3	D737*	A	4 1/2	1/2 x 6
1/2	208-230	4.1	1075	1.2	D935*★	C	5	1/2 x 6 1/2
1/2	208-230	3.7	1075	1.2	D7745*★	F	4 3/4	1/2 x 6
1/2	208-230	3.7	1075	1.2	D745*	C	4 3/4	1/2 x 6 1/2
1/2-1/3	208-230	4.4-2.7	1075	1.3	D735*+	A	5 1/4	1/2 x 6
3/4	208-230	5.0	1075	1.0	D929*	C	5 1/4	1/2 x 6 1/4
3/4-1/3	208-230	4.4-2.1	1075	1.1	D930*#	D	5 1/4	1/2 x 6 1/4
3/4-1/3	208-230	5.0-2.2	1075	1.3	D951*#	D	5 1/4	5/8 x 4 1/2 (Keyed)

• Ball bearing motor +7.5M 370V capacitor #15M 370V capacitor ★ 10M 370V capacitor



**Fig. F D7745**



**Fig. G D7748**



**Fig. H D7749**

### SHAFT DOWN OR HORIZONTAL

- 208-230 VAC
- Electrically reversible
- Thermally protected
- UL recognized
- CSA certified
- All angle mount bearings. Use rainshield when necessary
- Sleeve bearing models
- Closed endshield opposite shaft end



**Fig. F D740, D742, D743, D744, S719, D944**

PSC • OPEN VENTILATION • AIR-OVER								
H.P.	Volts	Amps	RPM	Load Factor	Model	Fig.	"A" Dim.	Shaft Dim.
1/5-1/8	208-230	1.3-.8	1075	1.2	S719^	F	3 3/4	1/2 x 6 1/2
1/5	208-230	1.2	1075	1.0	D743^	F	3 1/2	1/2 x 6
1/4	208-230	2.1	1075	1.3	D742^	F	4	1/2 x 6
1/3	208-230	2.9	1075	1.4	D944	F	4 1/4	1/2 x 6
1/3-1/4	208-230	3.2-2.4	1075	1.3	D744	F	4 3/4	1/2 x 6 1/2
1/2	208-230	4.5	1075	1.3	D740	F	5	1/2 x 6 1/2

^ Has 4 drilled and tapped holes in shell

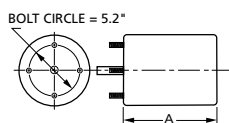

Products on this page are NOT SUITABLE for unattended equipment unless indicated by ► symbol. See inside back cover for additional information.

See pages 48 through 71 for OEM direct replacement models.

PSC motors use 5M 370V capacitors unless otherwise indicated.



**Fig. A D790, D791, D792, D795, D934, D936**



**Fig. B D793**



**Fig. C D796, D797**



**Fig. D D798, D799, D794**



**Fig. E D938**



**Fig. F D1745, D1748, D1749**



**Fig. G D713**

### 825 RPM MOTORS

- Models for shaft-up, shaft-down and horizontal applications
- Electrically reversible
- Thermally protected
- UL recognized
- CSA certified
- 208-230 and 115 VAC models
- All angle mount bearings. Use rainshield when necessary

PSC • OPEN VENTILATION AND TOTALLY ENCLOSED • AIR-OVER							
H.P.	Volts	Amps	RPM	Model	Fig	"A" Dim.	Shaft Dim.
1/8	208-230	.9	825	D799^#	D	4	1/2 x 6
1/6	208-230	1.0	825	D793#•	B	4	1/2 x 6
1/6	208-230	1.3	825	D798^#	D	4 1/3	1/2 x 6
1/5	208-230	1.3	825	D794^#	D	4 1/3	1/2 x 6
1/4	208-230	1.9	825	D934^#	A	4 1/3	1/2 x 6
1/4	208-230	1.8	825	D792•†^	A	4 1/4	1/2 x 6
1/4	208-230	1.8	825	D797†^	C	4 1/4	1/2 x 6
1/3	208-230	2	825	D936#+	A	5	1/2 x 6
1/3	208-230	2.6	825	D796†^	C	5	1/2 x 6
1/3	208-230	2.6	825	D791•†^	A	5	1/2 x 6
1/3	115	6.1	825	D795•♦	A	5 3/4	1/2 x 6
1/2	208-230	3.4	825	D938+†	E	5 1/2	1/2 x 6
1/2	208-230	3.5	825	D790+•†	A	5	1/2 x 6
1/2	208-230	3	825	D713+#	G	5 1/3	1/2 x 6

- # Totally enclosed
- Ball bearing motor
- † Shaft down or horizontal applications
- + 7.5MFD 370VAC capacitor
- ♦ Shaft up or horizontal applications
- ^ Has 4 drilled and tapped holes in shell

### DESERT LINE

- 208-230 VAC
- Electrically reversible
- Thermally protected
- UL recognized
- CSA certified
- All angle mount bearings. Use rainshield when necessary
- Motors designed for high ambient temperature conditions
- Sleeve bearing models

DESIGNED FOR SHAFT DOWN OR HORIZONTAL OPERATION ELECTRICALLY REVERSIBLE • 1075 RPM VENTILATED FOR HIGH AMBIENT TEMPERATURES							
H.P.	Volts	Amps	Load Factor	Model	Fig.	"A" Dim.	Shaft Dim.
1/2	208-230	4.1	1.2	D1745*	F	5	1/2 X 6 1/2
1/3	208-230	2.9	1.2	D1748	F	4	1/2 X 6 1/2
1/4	208-230	2.1	1.3	D1749	F	4	1/2 X 6

\* 10M 370V capacitor

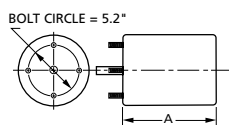

Products on this page are NOT SUITABLE for unattended equipment unless indicated by ► symbol. See inside back cover for additional information.

See pages 48 through 71 for OEM direct replacement models.

PSC motors use 5M 370V capacitors unless otherwise indicated.

# 5.6" DIAMETER

## Condenser Fan Motors



Fig. A D903, D904, D905, D1700, D1701, D1702



Fig. B D906, D907, D908, D909, D917, D919, D922, D925, D931, D932, D933



Fig. C D1709



Fig. D D7907, D7908, D7909

### TOTALLY ENCLOSED MOTORS

- Ideal for any angle mounting
- 208-230 and 230 VAC models
- Electrically reversible
- Thermally protected
- UL recognized
- CSA certified
- All angle mount bearings
- Ball bearing and sleeve bearing models

PSC • TOTALLY ENCLOSED • AIR-OVER								
H.P.	Volts	Amps	RPM	Fig.	Load Factor	Model	"A" Dim.	Shaft Dim.
1/8	208-230	.9	1075	B	1.3	D919 <sup>^</sup>	3 <sup>3</sup> / <sub>4</sub>	1/2 x 6 <sup>1</sup> / <sub>2</sub>
1/6-1/8	208-230	1.2-.9	1075	A	1.2	D905	3 <sup>3</sup> / <sub>4</sub>	1/2 x 6 <sup>1</sup> / <sub>2</sub>
1/6	208-230	1.0	1075	B	1.2	D917 <sup>^</sup>	3 <sup>3</sup> / <sub>4</sub>	1/2 x 6 <sup>1</sup> / <sub>2</sub>
1/5	208-230	1.5	1075	B	1.2	D906 <sup>^</sup>	4	1/2 x 6 <sup>1</sup> / <sub>2</sub>
1/4-1/5	208-230	1.8-1.0	1075	A	1.4	D904	4 <sup>1</sup> / <sub>4</sub>	1/2 x 6 <sup>1</sup> / <sub>2</sub>
1/4-1/8	208-230	1.7-.8	1075	A	1.1	D1702 <sup>•</sup>	4	1/2 x 6
1/4	208-230	1.8	1075	B	1.3	D922 <sup>†</sup>	4 <sup>1</sup> / <sub>3</sub>	1/2 x 6 <sup>1</sup> / <sub>2</sub>
1/4	208-230	1.8	1075	D	1.2	D7909 <sup>•^</sup>	4	1/2 x 6 <sup>1</sup> / <sub>2</sub>
1/4	208-230	1.8	1075	B	1.2	D909 <sup>^</sup>	4	1/2 x 6 <sup>1</sup> / <sub>2</sub>
1/3-1/4	208-230	2.7-1.3	1075	A	1.3	D903 <sup>+</sup>	4 <sup>3</sup> / <sub>4</sub>	1/2 x 6 <sup>1</sup> / <sub>2</sub>
1/3-1/4	208-230	2.2-1.3	1075	A	1.1	D1701 <sup>•+</sup>	5	1/2 x 5 <sup>1</sup> / <sub>2</sub>
1/3	208-230	2.7	1075	B	1.6	D925 <sup>†+</sup>	4 <sup>3</sup> / <sub>4</sub>	1/2 x 6 <sup>1</sup> / <sub>2</sub>
1/3	208-230	2.6	1075	D	1.2	D7908 <sup>•+^</sup>	4 <sup>1</sup> / <sub>2</sub>	1/2 x 6 <sup>1</sup> / <sub>2</sub>
1/3	208-230	2.4	1075	B	1.2	D908 <sup>+^</sup>	4 <sup>1</sup> / <sub>2</sub>	1/2 x 6 <sup>1</sup> / <sub>2</sub>
1/2-1/3	208-230	3.7-1.9	1075	A	1.1	D1700 <sup>•+</sup>	5	1/2 x 5 <sup>1</sup> / <sub>2</sub>
1/2	208-230	3.9	1075	B	1.5	D932 <sup>†*</sup>	5 <sup>5</sup> / <sub>8</sub>	1/2 x 6 <sup>1</sup> / <sub>2</sub>
1/2	208-230	3.7	1075	D	1.2	D7907 <sup>•*</sup>	5	1/2 x 6 <sup>1</sup> / <sub>2</sub>
1/2	208-230	3.7	1075	B	1.2	D907 <sup>*</sup>	4 <sup>3</sup> / <sub>4</sub>	1/2 x 6 <sup>1</sup> / <sub>2</sub>
3/4	208-230	5	1075	B	1.3	D933 <sup>†■</sup>	5 <sup>3</sup> / <sub>4</sub>	1/2 x 6 <sup>1</sup> / <sub>2</sub>
3/4	208-230	4.5	1075	B	1.2	D931 <sup>•■</sup>	5 <sup>1</sup> / <sub>4</sub>	1/2 x 6 <sup>1</sup> / <sub>2</sub>
1	208-230	5.5	1075	C	1.1	D1709 <sup>•■</sup>	5 <sup>13</sup> / <sub>16</sub>	1/2 x 6 <sup>1</sup> / <sub>2</sub>

NEW

NEW

NEW

+ 7.5M 370V capacitor    ★ 10M 370V capacitor    • Ball bearing motor  
 ■ 15M 370V capacitor    † Motor has increased stack for higher ambient temperatures.

<sup>^</sup> Has 4 drilled and tapped holes in shell    # Open ventilation

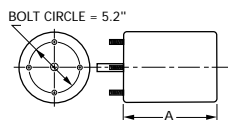

Products on this page are NOT SUITABLE for unattended equipment unless indicated by ► symbol. See inside back cover for additional information.

See pages 48 through 71 for OEM direct replacement models.

PSC motors use 5M 370V capacitors unless otherwise indicated.

### MULTI-PURPOSE CONDENSER FAN & DIRECT DRIVE BLOWER MOTORS

CONDENSER FAN MOTORS • TOTALLY ENCLOSED AIR-OVER										
H.P.	Volts	Amps	CAP @ 208V Line	CAP @ 230V Line	RPM	Rot.	Model	Fig.	"A" Dim.	Shaft Dim.
1/3	208-230	1.9	10 MFD	7.5 MFD	825	Rev.	D2826•	A	5-1/4	1/2 x 5
1/4		1.5	10 MFD	7.5 MFD						
1/5		1.2	10 MFD	7.5 MFD						
1/6		1.0	10 MFD	7.5 MFD						
1/3	208-230	2.6	7.5 MFD	5 MFD	1075	Rev.	D837	A	4-1/2	1/2 x 3-3/4
1/4		2.5	7.5 MFD	5 MFD						
1/5		2.0	7.5 MFD	5 MFD						
1/6		1.8	7.5 MFD	5 MFD						
1/3	208-230	3.0	12.5 MFD	10 MFD	1075	Rev.	D2827•	A	5-1/4	1/2 x 5
1/4		2.2	12.5 MFD	10 MFD						
1/5		1.6	12.5 MFD	10 MFD						
1/6		1.3	12.5 MFD	10 MFD						

DIRECT DRIVE FAN & BLOWER MOTORS • OPEN DRIPPROOF											
H.P.	Volts	Amps	Cooling	Heating	Cap.	RPM	Rot.	Model	Fig.	"A" Dim.	Shaft Dim.
1/2	115	7.3	High	Med-Low	10 MFD	1075	Rev.	D2835	B	4-3/4	1/2 x 5
1/3		6.9	High	Med-Low	5 MFD						
1/4		5.5	Med-Hi	Low	5 MFD						
1/5		3.6	Med-Low	Low	5 MFD						
1/6		2.8	Low	Low	5 MFD						
1/2	208-230	3.6	High	Med-Low	10 MFD	1075	Rev.	D833	B	4-3/4	1/2 x 5
1/3		3.5	High	Med-Low	5 MFD						
1/4		2.8	Med-Hi	Low	5 MFD						
1/5		1.9	Med-Low	Low	5 MFD						
1/6		1.3	Low	Low	5 MFD						
3/4	115	8.1	High	Med-Low	20 MFD	1075	Rev.	D2832	B	5-3/4	1/2 x 5
1/2		6.6	High	Low	10 MFD						
1/3		4.6	Med-Hi	Low	10 MFD						
1/4		3.8	Med-Low	Low	10 MFD						
1/5		3.1	Low	Low	10 MFD						
3/4	208-230	3.8	High	Med-Low	20 MFD	1075	Rev.	D2833	B	5-3/4	1/2 x 5
1/2		3.7	High	Low	10 MFD						
1/3		2.5	Med-Hi	Low	10 MFD						
1/4		1.8	Med-Low	Low	10 MFD						
1/5		1.7	Low	Low	10 MFD						

• Ball bearing motor



**Fig. A** D2826, D837, D2827



**Fig. B** D833, D2832, D2833, D2835

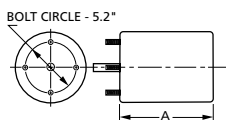

Products on this page are NOT SUITABLE for unattended equipment unless indicated by ▶ symbol. See inside back cover for additional information.

See pages 48 through 71 for OEM direct replacement models.

PSC motors use 5M 370V capacitors unless otherwise indicated.

# 5.6" DIAMETER

## Condenser Fan Motors



Fig. A S2846



Fig. B S2848



Fig. C D910, D911, D912, D913



Fig. D D819



Fig. E D821, D823



Fig. F D914, D915



Fig. G D1910, D1911



Fig. H D980



Fig. I D982



Fig. J D966, D968



Fig. K D967



Fig. L D1710

### 230/460 VAC MOTORS • FAN SHELTERED WITH INTERNAL COOLING FAN

- Ideal for shaft-up applications
- Electrically reversible
- All angle mount bearings
- 230/460 VAC
- Ball bearings
- Comes with unmounted conduit box
- Thermally protected

PSC • OPEN VENTILATION • AIR-OVER								
H.P.	Volts	Amps	RPM	Load Factor	Model	Fig.	"A" Dim.	Shaft Dim.
1/2	230/460	3.9/2.0	1075	1.2	S2846•+	A	6 1/2	1/2 x 5 3/8
3/4	230/460	4.7/2.4	1075	1.1	S2848•‡	B	7 3/4	1/2 x 6

- Ball bearing motor
- + 7.5M 440V capacitor
- ‡ 20M 370V capacitor

### 460 VAC MOTORS

- Thermally protected
- All angle mount bearings. Use rain-shield when necessary
- Electrically reversible
- Comes with unmounted conduit box
- Ball bearings

PSC • OPEN VENTILATION AND TOTALLY ENCLOSED • AIR-OVER								
H.P.	Volts	Amps	RPM	Load Factor	Model	Fig.	"A" Dim.	Shaft Dim.
1/4	460	1	1075	1.4	D980#•	H	4 1/8	1/2 x 6 1/2
1/4	460	1.1	1075	1.4	D913•	C	4 1/4	1/2 x 6 3/8
1/3	460	1.2	1075	1.4	D982#•	I	4 3/4	1/2 x 6 1/2
1/3	460	1.5	1075	1.4	D966	J	4 1/2	1/2 x 6 1/2
1/3	460	1.1	1075	1.3	D912•▲	C	4 1/4	1/2 x 6 3/8
1/3-1/4	460	1.2-1	1075	1.4	D821•▲^	E	4 3/4	1/2 x 6
1/2	460	2	1075	1.3	D967▲	K	5	1/2 x 6
1/2	460	1.8	1075	1.3	D1911†(1)•	G	5	1/2 x 6 3/8
1/2	460	1.8	1075	1.4	D911†•	C	5	1/2 x 6 3/8
1/2	208-230/460	4/2	1075	1.0	D819•▲^	D	7	1/2 x 3
3/4	460	2.5	1075	1.2	D968▲	J	5 1/2	1/2 x 6 1/2
3/4	460	2.2	1075	1.2	D1910(1)•†	G	5 1/2	1/2 x 6 3/8
3/4	460	2.2	1075	1.2	D910†•	C	5 1/2	1/2 x 6 3/8
3/4-1/2	460	2.5-1.6	1075	1.3	D915†•■(2)	F	5 1/2	5/8 x 4 1/2
3/4-1/2	460	2.5-1.6	1075	1.3	D914†•■	F	5 1/2	1/2 x 4 1/2
3/4-1/2	460	2.1-1.6	1075	1	D823•†^	E	5 1/2	1/2 x 6
1	460	3	1075	1.1	D1710•†^	L	6	1/2 x 6 1/2

- ^ Does not have removeable conduit boxes
- Ball bearing motor
- † 15M 370V capacitor
- #Totally enclosed
- ▲ 7.5M 370V capacitor
- Special wiring configuration. Cannot be used with SPDT switching.
- (1) D1910, D1911 have maximum ventilation for high ambient temperatures
- (2) Has keyed shaft

NOTE: Rotation is determined by looking at shaft end. Shaft length is measured from motor face.

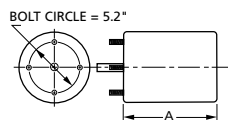

Products on this page are NOT SUITABLE for unattended equipment unless indicated by ▶ symbol. See inside back cover for additional information.

See pages 48 through 71 for OEM direct replacement models.

PSC motors use 5M 370V capacitors unless otherwise indicated.



**Fig. A D802**



**Fig. B D1914**



**Fig. C D916, D918**



**Fig. D D921**



**Fig. E D920**



**Fig. F D960, D961**

### 460 VAC MOTORS

- Thermally protected
- Electrically reversible
- Ball bearings
- All angle mount bearings

PSC • TOTALLY ENCLOSED • AIR-OVER								
H.P.	Volts	Amps	RPM	Load Factor	Model	Fig.	"A" Dim.	Shaft Dim.
1/2	460	1.0	1050	1.0	D802★•	A	5½	½ x 3½
¾	460	1.7	1050	1.1	D1914★•	B	6	½ x 6

- ★ 10M 370V capacitor
- Ball bearing motor

- 230/460 and 460 VAC models
- Electrically reversible
- Thermally protected
- All angle mount bearings. Use rainshield when necessary
- Comes with unmounted conduit box
- Ball bearing and sleeve bearing models

PSC • OPEN VENTILATION • AIR-OVER								
H.P.	Volts	Amps	RPM	Load Factor	Model	Fig.	"A" Dim.	Shaft Dim.
1/4-1/6	460	1.0-.6	1625	1.0	D918•	C	4¼	½ x 6½
1/2-1/3	460	1.6-1.1	1625	1.3	D916+•	C	5½	½ x 6½

- + 7.5M 370V capacitor
- Ball bearing motor

PSC • OPEN VENTILATION • AIR-OVER								
H.P.	Volts	Amps	RPM	Load Factor	Model	Fig.	"A" Dim.	Shaft Dim.
1/3	460	1.3	825	1.3	D960•	F	5	½ x 6
1/3	230/460	2.7/1.4	825	1.3	D921•	D	5¼	½ x 6¾
1/2	460	1.9	825	1.3	D961+•	F	5¾	½ x 6
1/2	460	2.1	825	1.3	D920#†	E	5½	½ x 4½

- Ball bearing motor
- # 15M 370V capacitor
- + 7.5M 370V Capacitor
- † Doesn't come with conduit box

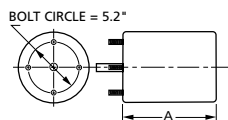

Products on this page are NOT SUITABLE for unattended equipment unless indicated by ► symbol. See inside back cover for additional information.

See pages 48 through 71 for OEM direct replacement models.

PSC motors use 5M 370V capacitors unless otherwise indicated.

# 5.6" DIAMETER

## Direct Drive Blower Motors



**Fig. A** D701, D712, D721, D727, D728, D902, D928

### OPEN CONSTRUCTION

- Ideal for blowers and fans used in furnaces and air-conditioners
- Electrically reversible
- Thermally protected
- UL recognized
- 115 VAC
- CSA certified
- All angle mount bearings
- Sleeve bearings



**Fig. B** D726



**Fig. C** D724



**Fig. D** D1730, D1731, D1732

PSC • OPEN VENTILATION • AIR-OVER									
H.P.	Volts	Amps	RPM	Load Factor	Rot.	Model	Fig.	"A" Dim.	Shaft Dim.
1/6-1/8-1/10	115	2.7-2.1-1.7	1075	1.2	Rev.	D928	A	3 <sup>3</sup> / <sub>4</sub>	1/2 x 5 <sup>1</sup> / <sub>4</sub>
1/4-1/5-1/6	115	4.8-3.3-2.6	1075	1.2	Rev.	D721	A	4	1/2 x 6
1/3-1/4-1/5	115	5.9-4.6-3.8	1075	1.2	Rev.	D727	A	4 <sup>1</sup> / <sub>4</sub>	1/2 x 6
1/2-1/3-1/4-1/5	115	7.7-5.5-4.2-3.3	1075	1.2	Rev.	D701*	A	5 <sup>1</sup> / <sub>4</sub>	1/2 x 5 <sup>1</sup> / <sub>2</sub>
3/4-1/3	115	11.0-5.0	1075	1.0	Rev.	D726#	B	5 <sup>1</sup> / <sub>4</sub>	5/8 x 4 <sup>1</sup> / <sub>2</sub>
3/4-1/2-1/3	115	10.5-6.9-4.8	1075	1.2	Rev.	D728*	A	5 <sup>1</sup> / <sub>2</sub>	1/2 x 6
3/4-1/2-1/3-1/4	115	9.5-7.2-5.6-3.5	1075	1.0	Rev.	D724#^	C	5 <sup>3</sup> / <sub>4</sub>	1/2 x 6
1-1/2-1/3	115	11.8-6.3-3.9	1075	1.0	Rev.	D712‡	A	6	1/2 x 6
1/2-1/3-1/4-1/5	115	9.9-5.6-3.7-2.7	1075	1.1	C.W.	D902**	A	5 <sup>1</sup> / <sub>4</sub>	1/2 x 5 <sup>1</sup> / <sub>2</sub>

\* 10M 370V capacitor      # 15M 370V capacitor      ‡ 20M 370V capacitor

^ Includes 8 drilled and tapped holes in shell.      ★ Mechanically reversible

**NOTE:** Rotation is determined by looking at shaft end. Shaft length is measured from motor face.

PSC • OPEN VENTILATION • AIR-OVER									
H.P.	Volts	Amps	RPM	Load Factor	Rot.	Model	Fig.	"A" Dim.	Shaft Dim.
1/4	115	4.8-2.6-1.5	1075	1.4	Rev.	D1730	D	4	1/2 x 6
1/3	115	5.9-4.6-3.8	1075	1.3	Rev.	D1731	D	4 <sup>1</sup> / <sub>3</sub>	1/2 x 6
1/2	115	7.7-5.5-4.2	1075	1.3	Rev.	D1732*	D	5 <sup>13</sup> / <sub>16</sub>	1/2 x 5 <sup>1</sup> / <sub>2</sub>

\* 10M 370V capacitor

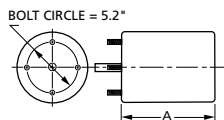

Products on this page are NOT SUITABLE for unattended equipment unless indicated by ► symbol. See inside back cover for additional information.

See pages 48 through 71 for OEM direct replacement models.

PSC motors use 5M 370V capacitors unless otherwise indicated.



**Fig. A D830, D826**

### OPEN CONSTRUCTION

- 208-230 VAC
- Electrically reversible
- Thermally protected
- UL recognized
- CSA certified
- All angle mount bearings. Use rainshield when necessary
- Ball bearing and sleeve bearing models



**Fig. B D703, D723, D725, D729, D730, D923, D927**



**Fig. C D711**

PSC • OPEN VENTILATION • AIR-OVER									
H.P.	Volts	Amps	RPM	Load Factor	Rot.	Model	Fig	"A" Dim.	Shaft Dim.
1/8-1/12	208-230	1.2-.7	825	1.4	Rev.	D830 <sup>^</sup>	A	4	1/2 x 6
1/6-1/8-1/10	208-230	1.4-.9-.5	1075	1.2	Rev.	D927	B	3 3/4	1/2 x 6
1/4-1/6-1/8	208-230	2.2-1.5-1.1	1075	1.3	Rev.	D725	B	4	1/2 x 6
1/3-1/4-1/6	208-230	3.3-2.3-1.8	1075	1.3	Rev.	D723	B	4 1/2	1/2 x 6
1/3-1/4-1/5	208-230	2.9-2.2-1.7	1075	1.2	Rev.	D923	B	4 1/4	1/2 x 6
1/2	208-230	2.6	825	1	Rev.	D826 <sup>Ø^</sup>	A	5	1/2 x 6
1/2-1/3-1/4	208-230	4.0-2.7-2.0	1075	1.4	Rev.	D703 <sup>+</sup>	B	5	1/2 x 6
3/4-1/2	208-230	4.8-3.5	1075	1.2	Rev.	D730 <sup>•*</sup>	B	5 1/2	1/2 x 6
3/4-1/2-1/3	208-230	5.4-3.8-2.9	1075	1.3	Rev.	D729 <sup>*</sup>	B	5 1/2	1/2 x 6
1-1/2-1/3	208-230	5.3-2.8-1.8	1075	1.0	Rev.	D711 <sup>‡</sup>	C	5 1/2	1/2 x 6

- Ball bearing motor
- ‡ 20M 370V capacitor
- Ø 15 Mfd 370V capacitor
- + 7.5M 370V capacitor
- ^ Includes 8 drilled and tapped holes in shell
- \* 10M 370 capacitor
- # Totally enclosed non ventilated

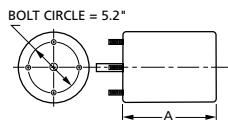

Products on this page are NOT SUITABLE for unattended equipment unless indicated by ► symbol. See inside back cover for additional information.

See pages 48 through 71 for OEM direct replacement models.

PSC motors use 5M 370V capacitors unless otherwise indicated.

# 5.6" DIAMETER



## Direct Drive Blower and Unit Heater Motors



**Fig. A** D970, D971, D972, D973, D975

- Ideal for blowers and fans used in furnaces and air-conditioners
- 277 VAC (Not suitable for 230 VAC applications)
- Single and double shaft
- Single shaft electrically reversible
- Thermally protected
- UL recognized
- CSA certified
- All angle mount
- Sleeve bearings



**Fig. B** D976, D979



**Fig. C** D733



**Fig. D** D732, D834



**Fig. E** D734, D736, D817



**Fig. F** D974



**Fig. G** D1703, D1704, D1705, D1706, D1707, D1708

PSC • OPEN VENTILATION • AIR-OVER									
H.P.	Volts	Amps	RPM	Load Factor	Rot.	Model	Fig	"A" Dim	Shaft Dim.
1/6-1/10-1/12	277	.9-.4-.3	1075	1.0	Rev.	D975	A	4	1/2 x 5 1/2
1/6-1/8-1/10	277	.9-.7-.6	1075	1.2	D.S.	D979	B	3 3/4	7 7/8 x 1/2 x 8 1/4
1/4-1/6-1/8	277	2.0-1.4-1.0	1075	1.1	Rev.	D973	A	4	1/2 x 5 1/2
1/3-1/4-1/5	277	2.4-1.5-1.0	1075	1.1	Rev.	D972	A	4 1/4	1/2 x 5 1/2
1/2-1/3-1/4	277	3.2-2.2-1.8	1075	1.1	Rev.	D971★	A	4 3/4	1/2 x 5 1/2
1/2-1/3-1/4	277	3.4-2.2-1.6	1075	1.5	D.S.	D976★	B	5 1/4	7 3/8 x 1/2 x 7 1/4
1/2-1/3-1/4	277	2.3-1.6-1.3	825	1	Rev.	D974▲	F	5 1/3	1/2 x 5
3/4-1/2-1/3	277	3.9-2.2-1.6	1075	1.0	Rev.	D970*	A	5 1/4	1/2 x 5 1/2

★ 10M 370V capacitor

\* 20M 370V capacitor

▲ 15M 370V capacitor

PSC • TOTALLY ENCLOSED • AIR-OVER									
H.P.	Volts	Amps	RPM	Load Factor	Rot.	Model	Fig	"A" Dim	Shaft Dim.
1/4	115	4.1-3-2.3	1075	1.3	D.S.	D1703	G	4 1/4	8 x 1/2 x 8
1/3	115	4.9-3.1-2.2	1075	1.2	D.S.	D1704	G	4 3/4	8 x 1/2 x 8
1/2	115	8.7-6.2-4.9	1075	1.3	D.S.	D1705	G	5 3/4	8 x 1/2 x 8
1/4	208-230	1.7-1.3-1	1075	1.2	D.S.	D1706	G	4 1/4	8 x 1/2 x 8
1/3	208-230	2.3-1.5-1.1	1075	1.1	D.S.	D1707	G	4 3/4	8 x 1/2 x 8
1/2	208-230	4.1-3-2.3	1075	1.3	D.S.	D1708	G	5 3/4	8 x 1/2 x 8

- Ideal for unit heaters
- All angle mount bearings
- CW and electrically reversible models
- Thermally protected
- UL recognized
- CSA certified
- Ball bearings

PSC • TOTALLY ENCLOSED • AIR-OVER • UNIT HEATERS									
H.P.	Volts	Amps	RPM	Load Factor	Rot.	Model	Fig	"A" Dim	Shaft Dim.
1/6	115	2.0	1625	1.1	Rev.	D736*	E	4 1/4	1/2 x 3 1/4
1/6	115	2.7	1075	1.3	C.W.	D834*	D	4 1/4	1/2 x 3
1/6-1/8	115	2.5-1.8	1075	1.2	Rev.	D733•	C	4 1/4	1/2 x 4 1/2
1/4	115	3.8	1075	1.1	Rev.	D734+••	E	4 1/4	1/2 x 3 1/4
1/3	115	4.1	1075	1.0	Rev.	D732*•	D	4 3/4	1/2 x 5
1/2	115	5.5	1140	-	C.W.	D817*•	E	4 1/2	1/2 x 6

• Ball bearing motor

\* The capacitor and base are included

+ 7.5M 370V capacitor

See pages 27, 32 for 4.4" and 5.0" dia. unit heater motors.

**NOTE:** Rotation is determined by looking at shaft end. Shaft length is measured from motor face.

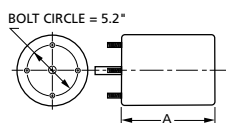

Products on this page are NOT SUITABLE for unattended equipment unless indicated by ► symbol. See inside back cover for additional information.

See pages 48 through 71 for OEM direct replacement models.

PSC motors use 5M 370V capacitors unless otherwise indicated.



**Fig. A D786, D789**



**Fig. B D781, D783, D784, D787, D788**



**Fig. C D780, D782, D785**



**Fig. D D770, D771, D773, D774, D775, D776, D777**



**Fig. E D772**



**Fig. F D778**

- 208-230,230 and 115 VAC models
- Thermally protected
- UL recognized
- CSA certified
- All angle mount sleeve bearings

- Single shaft motors are electrically reversible
- These motors should **not** be used for replacements where original motor is rated below 1500 RPM.

Some high slip air-conditioning motors are rated often at 1300-1400 RPM.

SINGLE SHAFT									
PSC • OPEN VENTILATION • AIR-OVER									
H.P.	Volts	Amps	RPM	Ld. Fac.	Model	Fig.	"A" Dim	Shaft Dim.	
1/4	115	3.5	1625	1.2	D782	C	4 1/4	1/2 x 6	
1/4	208-230	1.5	1625	1.2	D783	B	4	1/2 x 6	
1/3-1/4-1/6	115	4.7-3.5-2.7	1625	1.2	D780	C	4 1/2	1/2 x 6	
1/3	208-230	2.3	1625	1.2	D787	B	4 1/4	1/2 x 7	
1/3-1/4-1/6	208-230	2.0-1.6-1.2	1625	1.2	D781	B	4 1/2	1/2 x 7	
1/2-1/3-1/4	115	8.4-6.4-5.0	1625	1.4	D785	C	4 3/4	1/2 x 6	
1/2	208-230	3.9	1625	1.3	D788	B	5	1/2 x 6	
1/2-1/3-1/4	208-230	3.8-2.8-2.1	1625	1.3	D784	B	5	1/2 x 6	
3/4	208-230	5.2	1625	1.3	D789+	A	5 1/4	1/2 x 6	
3/4-1/2-1/3	230	5.3-3.8-2.9	1625	1.3	D786+	A	5 1/4	1/2 x 6	

+ 7.5M 370V capacitor

- Ideal versatility using Kit 200 "X" brackets to

accommodate various cradle base lengths

- Ideal for lug mounting using lug Kit 55L or 55S

DOUBLE SHAFT										
PSC • OPEN VENTILATION • AIR-OVER										
H.P.	Volts	Amps	Rot.	RPM	Ld. Fac.	Model	Fig.	"A" Dim.	Shaft Dim.	
1/5-1/8-1/10	115	2.8-2.0-1.6	D.S.	1625	1.0	D776	D	3 1/2	8 1/2 x 1/2 x 8 1/2	
1/5-1/6-1/8	208-230	1.1-1.8-7	D.S.	1625	1.0	D775	D	3 1/2	8 1/2 x 1/2 x 8 1/2	
1/4-1/5-1/6	115	3.8-2.8-2.1	D.S.	1625	1.3	D773	D	4	8 1/2 x 1/2 x 8 1/2	
1/4-1/5-1/6	208-230	1.9-1.2-9	D.S.	1625	1.3	D774	D	4	8 1/2 x 1/2 x 8 1/2	
1/3-1/4-1/6	115	5.9-4.4-3.5	D.S.	1625	1.6	D770	D	4 1/2	8 3/4 x 1/2 x 8 3/4	
1/3-1/4-1/6	208-230	2.4-1.8-1.4	D.S.	1625	1.4	D771	D	4 1/2	8 3/4 x 1/2 x 8 3/4	
1/2-1/3-1/4	115	9.4-6.0-4.5	D.S.	1625	1.5	D777	D	5	7 1/2 x 1/2 x 7 1/2	
1/2-1/3-1/4	208-230	3.8-2.8-2.1	D.S.	1625	1.3	D772	E	4 3/4	8 x 1/2 x 8	
3/4-1/2-1/3	208-230	5.3-3.8-3.2	D.S.	1625	1.3	D778	F	5 1/4	7 1/2 x 1/2 x 7	

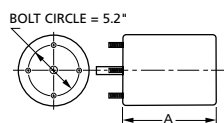

Products on this page are NOT SUITABLE for unattended equipment unless indicated by symbol. See inside back cover for additional information.

See pages 48 through 71 for OEM direct replacement models.

PSC motors use 5M 370V capacitors unless otherwise indicated.

# 5.6" DIAMETER

## Window Air Conditioner Motors

# FASCO



**Fig. A D750, D751, D752, D754, D755, D756, D757, D758, D760, D761, D763, D769**

- 208-230, 230 and 115 VAC models
- Thermally protected
- UL recognized
- CSA certified
- All angle mount sleeve bearings
- Hubless end shields for flush mounting
- Extended tie rods
- Ideal versatility using Kit 200 "X" brackets to accommodate various cradle base lengths
- Ideal for lug mounting using lug Kit 55L or 55S

PSC • OPEN VENTILATION • AIR-OVER									
H.P.	Volts	Amps	Rot.	RPM	Ld. Fac.	Model	Fig.	"A" Dim	Shaft Dim.
1/8-1/10-1/15	115	2.3-1.5-1.1	D.S.	1075	1.3	D751	A	3 1/2	7 1/2 x 1/2 x 9
1/8-1/10-1/12	208-230	.9-6-.5	D.S.	1075	1.3	D750	A	3 3/4	7 1/2 x 1/2 x 9
1/6-1/8-1/10	115	2.7-2.1-1.7	D.S.	1075	1.1	D754	A	3 1/2	7 1/2 x 1/2 x 9
1/6-1/8-1/10	208-230	1.4-9-.5	D.S.	1075	1.3	D752	A	3 1/2	7 1/2 x 1/2 x 9
1/4-1/6-1/8	115	4.6-3.1-2.7	D.S.	1075	1.0	D756	A	4	10 x 1/2 x 10
1/4-1/6-1/8	208-230	2-1.4-1.2	D.S.	1075	1.2	D755	A	4	7 1/2 x 1/2 x 8 1/2
1/3-1/4-1/6	115	6.9-4.8-3.8	D.S.	1075	1.2	D757	A	4 1/4	8 1/2 x 1/2 x 8 1/2
1/3-1/4-1/6	208-230	2.3-1.7-1.1	D.S.	1075	1.0	D758	A	4 1/2	8 1/2 x 1/2 x 8 1/2
1/2-1/3-1/4	115	9.0-6.3-4.8	D.S.	1075	1.0	D761	A	5 1/4	8 x 1/2 x 8
1/2-1/3-1/4	208-230	4.3-3.1-2.3	D.S.	1075	1.3	D760	A	5 1/4	8 x 1/2 x 8
3/4-1/2-1/3	115	11.9-8.1-6.0	D.S.	1075	1.1	D769*	A	5 1/2	8 x 1/2 x 8
3/4-1/2-1/3	208-230	5.7-4.1-3.1	D.S.	1075	1.0	D763*	A	5 1/2	8 x 1/2 x 8

\*10M 370V capacitor

- Thermally protected
- Electrically reversible
- All angle mount sleeve bearings
- Hubless end shields for flush mounting
- Extended tie rods
- Ideal versatility using Kit 200 "X" bracket to accommodate various cradle base leng
- Ideal for lug mounting using lug Kits 55L or 55S



**Fig. B D766**

PSC • TOTALLY ENCLOSED • AIR-OVER									
H.P.	Volts	Amps	Rot.	RPM	Ld. Fac.	Model	Fig.	"A" Dim.	Shaft Dim.
1/4-1/6-1/8	230	1.9-1.2-.8	D.S.	1075	1.1	D766	B	4	7 1/2 x 1/2 x 8 1/2

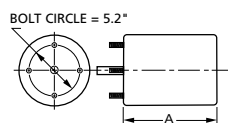

Products on this page are NOT SUITABLE for unattended equipment unless indicated by ► symbol. See inside back cover for additional information.

See pages 48 through 71 for OEM direct replacement models.

PSC motors use 5M 370V capacitors unless otherwise indicated.



**Fig. A** D3771, D3772, D3758, D3760



**Fig. B** D3775, D3774, D3752, D3755

- 230 VAC models
- All angle mount bearings. Use rainshield when necessary

**Note:** Motors on this page have RPM ratings based on 50 Hz power. 60 Hz power will increase RPM approximately 20%.

- Sleeve bearings
- Thermally protected
- UL recognized
- CSA certified

PSC • 50 Hz • OPEN AND TOTALLY ENCLOSED VENTILATION AIR-OVER									
H.P.	Volts	Amps	Rot.	RPM	Model	Fig.	"A" Dim. Inch/MM	Shaft Dim. Inches/MM	Weight Lbs./Kilos
1/6-1/8-1/10	230	.8-.6-.5	D.S.	1350	D3775	B	3.5/89	7.75 x .5 x 7.75 197 x 12.7 x 197	11/5.0
1/4-1/5-1/6	230	1.5-1.1-.8	D.S.	1350	D3774+	B	4.0/102	7.5 x .5 x 7.5 191 x 12.7 x 191	14/6.4
1/3-1/4-1/5	230	2.1-1.5-1.1	D.S.	1350	D3771	A	4.5/114	7.25 x .5 x 7.25 184 x 12.7 x 184	15/6.8
1/2-1/3-1/4	230	3.0-1.9-1.3	D.S.	1350	D3772*	A	4.8/122	7.0 x .5 x 7.0 178 x 12.7 x 178	17/7.7
1/6-1/8-1/10	230	1.2-.8-.6	D.S.	900	D3752	B	4.0/102	7.5 x .5 x 7.5 191 x 12.7 x 191	13/5.9
1/4-1/5-1/6	230	2.0-1.4-1.0	D.S.	900	D3755+	B	4.5/114	7.25 x .5 x 7.25 184 x 12.7 x 184	16/7.3
1/3-1/4-1/5	230	2.6-1.7-1.3	D.S.	900	D3758	A	5.3/135	7.0 x .5 x 6.75 178 x 12.7 x 178	20/9.1
1/2-1/3-1/4	230	4.2-2.2-1.5	D.S.	900	D3760*	A	5.5/140	7.0 x .5 x 7.0 178 x 12.7 x 178	22/9.0

\*Uses 10M 370V capacitor  
+Includes dust seal

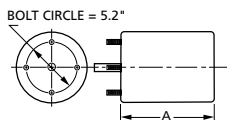

Products on this page are NOT SUITABLE for unattended equipment unless indicated by ► symbol. See inside back cover for additional information.

# 5.6" DIAMETER



## Pedestal Fan Motors and Gearmotors



Fig. A D824, D901, D997, D999



Fig. B D900



Fig. C D998



Fig. D V44-36

- 115 and 115/230 VAC models
- Fan motors include pull-chain switches, except D998 and D900
- D998 designed for maximum protection against dirt and moisture

5.6" DIA. • PEDESTAL FAN MOTORS • 1100 RPM PERMANENT SPLIT CAPACITOR							
H.P.	Volts	Amps	Rot.	Model	Fig.	"A" Dim.	Shaft Dim.
1/4-1/8	115	3.2-2.4	Rev.	D824•#^	A	5 <sup>3</sup> / <sub>4</sub>	1/2 x 3 <sup>1</sup> / <sub>2</sub>
1/3-1/8	115	4.0-3.5	Rev.	D901•^	A	6	1/2 x 3 <sup>1</sup> / <sub>2</sub>
1/2-1/4	115	7.1-4	Rev.	D997†	A	7 <sup>1</sup> / <sub>3</sub>	1/2 x 3
1/2-1/4	115	7.1-4	Rev.	D999†	A	7 <sup>1</sup> / <sub>3</sub>	5/8 x 3
1/2-1/4	115	7.1-4.0	Rev.	D900†	B	7 <sup>1</sup> / <sub>4</sub>	5/8 x 3

• Ball bearing motor # 4MFD 370V capacitor included  
 † 12.5MFD 370V capacitor included ^ Has 10' cordset

POULTRY AND HOG HOUSE FAN MOTOR • 825 RPM AGRICULTURAL APPLICATIONS							
H.P.	Volts	Amps	Rot.	Model	Fig.	"A" Dim.	Shaft Dim.
1/2	115/230	6.0/3.0	C.W.	D998•+□	C	7 <sup>1</sup> / <sub>2</sub>	5/8 x 2 <sup>5</sup> / <sub>8</sub>

+Keyed Shaft •Ball bearing motor ■ No pedestal yoke mount

BULK MILK AGITATOR GEARMOTOR 120 IN LBS.							
H.P.	Volts	Amps	Rot.	Model	Fig.	"A" Dim.	Shaft Dim.
1/12	115/230	1.85/1.0	C.C.W.	V44-36	D	8.9	3/4 x 2 <sup>3</sup> / <sub>16</sub>

NOTE: Rotation is determined by looking at shaft end. Shaft length is measured from motor face.

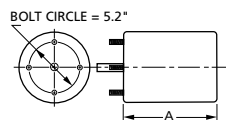

Products on this page are NOT SUITABLE for unattended equipment unless indicated by ► symbol. See inside back cover for additional information.

See pages 48 through 71 for OEM direct replacement models.

PSC motors use 5M 370V capacitors unless otherwise indicated.