

H.P.	Volts	Amps	RPM	Spd.	Model	Fig.	Type	Mtg.	Dia.	Rot.	"A" Dim	Shaft Dia. and Length.	Reference No.
COLEMAN													
88CFM	115	1.3	3200	1	A088	A	S.P.	-	3.3.	C.W.	-	-	7021-5478
1/8-1/11	115	4.5-3.4	1050	2	D178	B	SP	Base	5.0	C.W.	3-1/4	1/2 x 4	Blower Motor
1/150	115	.48	3000	1	D408	C	SP	Threaded Holes	3.3	C.W.	5-1/2	1/4 x 1-1/2	7995-316, 7121-5906
CONSOLIDATED INDUSTRIES													
-	115	.9	3000	1	A128	I	SP	-	3.3	C.W.	-	-	7021-6376, 7021-9404
COPELAND													
1/4	208-230	1.5	1625	1	D783	D	PSC	Base	5.6	Rev.	4	1/2 x 6	3047 050-0238-00
DUOTHERM													
1/6	115	7.9	1050	1	D1080	E	SP	Lug	5.1	C.W.	4-1/2	1/2 x 4	3-14826 100,000 BTU Furnaces
1/6-1/8-1/10	115	2.4-1.9 1.5	1625	3	D1081*	F	PSC	Lug	5.1	Rev.	4-7/8	3-1/2 x 1/2 x 3-5/8	3-9650, 12,0000-13,000BTU's 5KCP29MG4011S 8743810260, 3-18440
1/15	115	3.2	1000	1	D1001	H	SP	Lug	5.1	C.W.	2-1/3	3/8 x 3-3/4	3-9930
ECONOMITE/MID-CONTINENT GAS BURNER													
1/40	115	1.2	1500	1	D1151	G	SP	Stud	3.3	C.C.W.	2-3/4	5/16 x 3-1/4	AA2P026N

* 10M 370V capacitor

NOTE: Rotation is determined by looking at shaft end. Shaft length is measured from motor face.



Fig. A A088



Fig. C D408



Fig. E D1080



Fig. G D1151



Fig. I A128



Fig. B D178



Fig. D D783



Fig. F D1081



Fig. H D1001

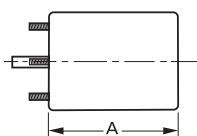

Products on this page are NOT SUITABLE for unattended equipment unless indicated by ► symbol. See inside back cover for additional information.

PSC motors use 5M 370V capacitors unless otherwise indicated.