

H.P.	Volts	Amps	RPM	Spd.	Model	Fig.	Type	Mtg.	Dia.	Rot.	"A" Dim	Shaft Dia. and Length	Reference No.
FEDDERS (continued)													
1/3	208-230	2.1-1.9 1.5	1240	3	D888	C	PSC	Stud Base	5.6	D.S.	5-1/4	3-3/4 x 1/2 x 3-1/4	S206-00014-004 FASCO 7124-0589
159 CFM	230	.5	1550	1	A159*	B	SP	-	3.3	C.C.W.	-	-	AK4K84BX 11-7096
161 CFM	230	.6	1600	1	A161*	B	SP	-	3.3	C.C.W.	-	-	Brinkley 8353920103 Fedders
FRIEDRICH													
1/3-1/4-1/5-1/6-1/7	230	2.1-1.5 1.2-1.0-.9	1075	5	D868 ■	A	PSC	Lug	5.6	C.C.W.	4-3/4	2-3/4 x 1/2 x 2-1/4	5KCP39MG9096S 5KCP39KGE992S 5KCP39LGD804S 5KCP39LGG720S 5KCP39LGK010T 5KCP39MG7145S 5KCP39MG9679S 5KCP39LGM011T
GAFFERS AND SATTLER													
1/2-1/3	208-230	3.2-3.0	1075	2	D862+	D	PSC	Base	5.6	D.S.	5-1/4	2-5/8 x 1/2 x 2-1/2	Roof Top A/C Direct Pak 1.5 and 2.0 EA

• Ball bearing motor + 7.5M 370V capacitor

■ Rotation is determined by viewing lug end.

NOTE: Rotation is determined by looking at shaft end. Shaft length is measured from motor face.



Fig. A D868



Fig. C D888



Fig. B A159, A161



Fig. D D862

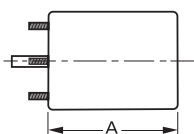

Products on this page are NOT SUITABLE for unattended equipment unless indicated by ► symbol. See inside back cover for additional information.

PSC motors use 5M 370V capacitors unless otherwise indicated.