

NEW
NEW

H.P.	Volts	Amps	RPM	Spd.	Model	Fig.	Type	Mtg.	Dia.	Rot.	"A" Dim	Shaft Dia. and Length	Reference No.
KEEPRITE													
1/20	115	.8	1550	1	D1243*	G	PSC	Stud	3.3	C.C.W.	4-1/8	5/16 x 2-3/4	501899, 7164-1243 7164-1854, R370
1/20	230	.4	1550	1	D1245*	G	PSC	Stud	3.3	C.C.W.	4	5/16 x 2-3/4	501909, 7164-1313, 7164-1853, R371
1/20	115	2.3	1550	1	D1120	J	SP	Stud	3.3	C.W.	3-1/2	5/16 x 2-1/2	7163-8722, 1043336
1/20	208-230	2.3	1550	1	D1121	J	SP	Stud	3.3	C.W.	3-1/2	5/16 x 2-1/2	7163-8861, 1043766
1/15	115	2.3	1550	1	D1246	H	SP	Band	4.4	C.C.W.	3-1/2	3/8 x 1-3/4	81356, 7108-2206
JAKEL													
—	115	0.95	3000	1	A143	I	SP	—	3.3	C.W.	—	—	J238-138-1344
KOLD-DRAFT♦													
1/10	115	1.32	13	1	VS62-13*	A	PSC	—	—	—	—	5/8 x 2-1/4 Threaded	Flaker Ice Machine Gearmotor, V00682AU62
KRACK REFRIGERATION													
1/20	115/ 208-230	1.4/8	1550	1	D1158*	B	SP	BKT	3.3	C.W.	3-5/16	5/16 x 1-5/8	Commercial Refrigeration Units
1/20	115/ 208-230	1.4/ 0.76	1550	1	D1189*	C	SP	BKT	3.3	C.W.	3-1/8	5/16 x 1-5/8	11528, 11529 JB2PO46N, JA2P216N JA2P217N, JB2PO47N 8354110940, 8254111030
KRAMER/TRENTON													
1/20	115	2.1	1550	1	D1152	E	SP	Stud	3.3	C.W.	2-7/8	5/16 x 2-3/8	5KSM59ES2001
1/20	230	1.0	1550	1	D1154	E	SP	Stud	3.3	C.W.	3-1/8	5/16 x 2-3/8	JA2R140N
1/2	208-230	4.0	1075	1	D2862+*	D	PSC	Base	5.6	Rev.	6-1/2	1/2 x 3	5KCP37PN244BS MTG3041
LARKIN COIL													
1/20	115	1.9	1550	1	D1101▼	E	SP	Stud	3.3	C.C.W.	2-3/4	5/16 x 2-1/4	Larkin No. 253-1194 Fasco No. 7163-2113
1/20	208-230	1.3	1550	1	D1103‡▼	E	SP	Stud	3.3	C.C.W.	3	5/16 x 2-1/4	Fasco No. 7163-3371, 253-1195
1/2	208-230	4.4	1075	1	D863+	F	PSC	Base	5.6	Rev.	6-3/4	1/2 x 3	SCS0500HI-CPM120-3, 5KCP39PGH728T

* Ball bearing motor + 7.5M 370V capacitor * 4M 370V capacitor included
 ‡ Not a direct replacement for 253-1194, but is an acceptable substitute
 ♦ KOLD-DRAFT is a registered Trademark of UNIFLOW MFG. CO.
 ▼ Special low temperature oil.
NOTE: Rotation is determined by looking at shaft end. Shaft length is measured from motor face.



Fig. A VS62-13



Fig. C D1189



**Fig. E D1101, D1103,
D1152, D1154**



Fig. G D1243, D1245



Fig. I A143



Fig. B D1158



Fig. D D2862



Fig. F D863,



Fig. H D1246



Fig. J D1120, D1121

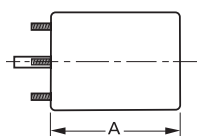

Products on this page are NOT SUITABLE for unattended equipment unless indicated by ► symbol. See inside back cover for additional information.

PSC motors use 5M 370V capacitors unless otherwise indicated.