

# CENTRIFUGAL BLOWERS

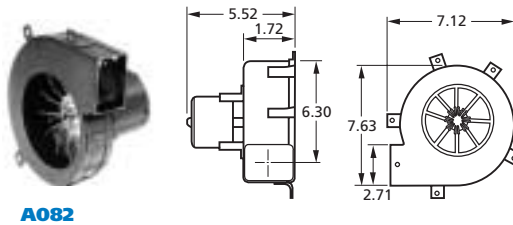

## 69-75 Free Air Output

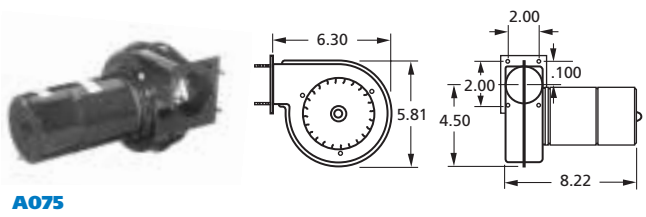
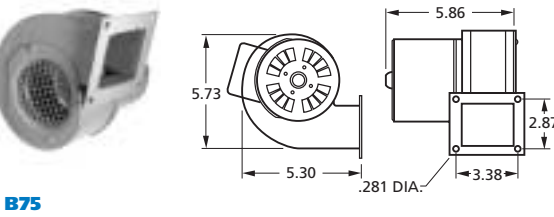
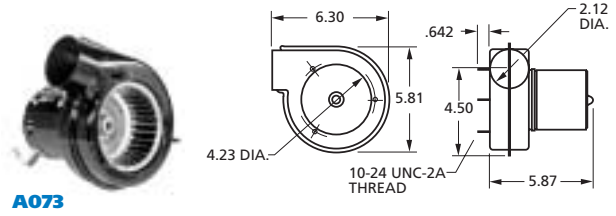
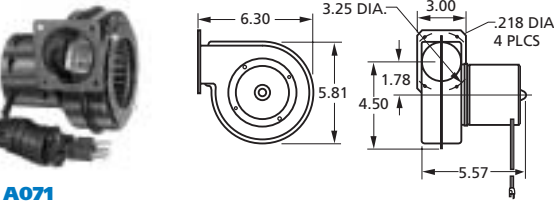
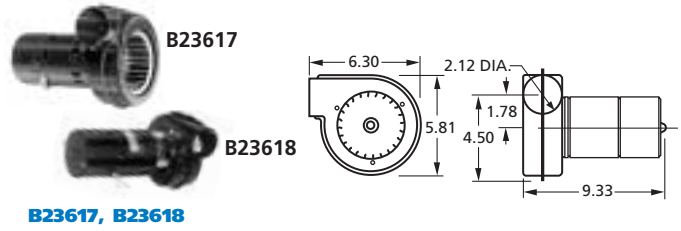
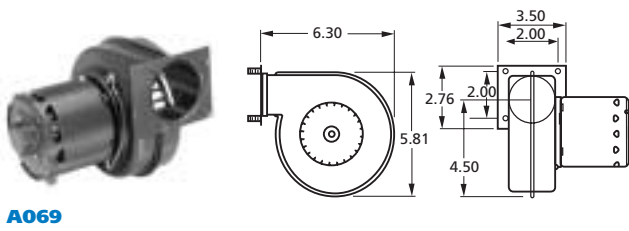

CFM at Static Pressure Shown Static Pressure (inches of water)										Nameplate CFM	Volts	Freq	No. of Speeds	RPM@ Free Air	Amps@ Free Air	MODEL
0.1	0.2	0.3	0.4	0.5	0.6	0.7	0.8	0.9	1							
72	67	63	60	53	52	50	43	40	—	69	208-230	60	1	3000	.45	A069
72	67	64	62	57	55	50	46	41	33	70	115/230	60	1	3100	.9/.45	B23617
72	67	64	62	57	55	50	46	41	33	70	115/208-230	60	1	3100	.9/.45	B23618*
70	67	63	58	57	55	51	35	—	—	71	115	60	1	2850	.7	A071
72	69	67	63	61	57	53	48	43	37	73	115/230	60	1	3200	.82/.48	A073*
68	63	57	47	34	14	—	—	—	—	75	115	60	1	3000	.59	B75
73	69	65	62	58	55	50	45	40	35	75	230	60	1	3200	.4	A075*
66	62	53	52	47	42	23	—	—	—	75	115	60	1	2800	.95	A082

• Ball Bearing

See page 81 for High Static Pressure Blowers.