

CENTRIFUGAL BLOWERS



135 to 265 Free Air Output



**50752-D500,
50752-D230**

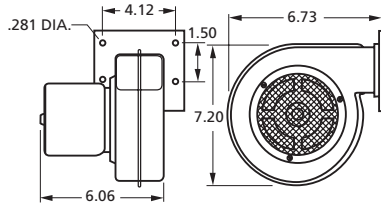

Uses model 1-6042 wheel



A159

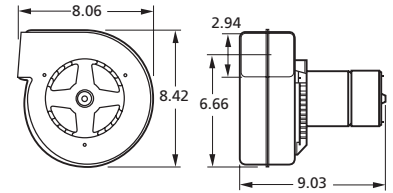

Uses model 1-6053 wheel



**50755-D500,
50755-D230**

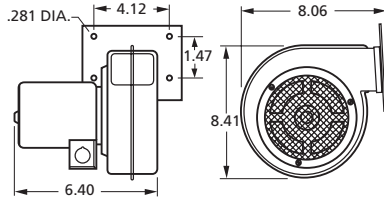

Uses model 1-6054 wheel



A161

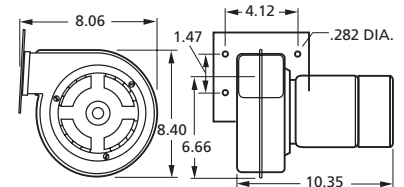

Uses model 1-6053 wheel



B47120

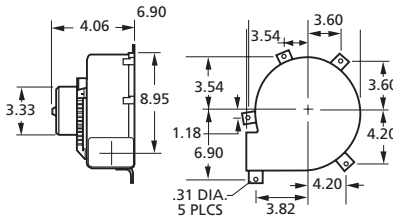

Uses model 1-6066 wheel



A212

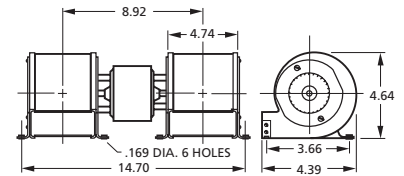

B45227, B45227-2

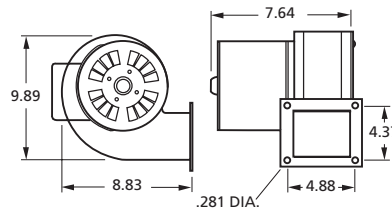

CFM at Static Pressure Shown Static Pressure (inches of water)										Nameplate CFM	Volts	Freq.	No. of Speeds	RPM@ Free Air	Amps@ Free Air	MODEL
0.1	0.2	0.3	0.4	0.5	0.6	0.7	0.8	0.9	1							
108	105	97	93	90	83	77	65	32	—	135	115	60	11	3100	1.1	50752-D500
108	105	97	93	90	83	77	65	32	—	135	208-230	50/60	1	3100	.67	50752-D230
140	138	118	105	—	—	—	—	—	—	159	230	60	1	1600	.45	A159*
140	128	118	105	—	—	—	—	—	—	160	115	60	1	1600	1	50755-D500
140	128	118	105	—	—	—	—	—	—	160	208-230	50/60	1	1600	.51	50755-D230
140	138	118	105	—	—	—	—	—	—	161	230	60	1	1600	.55	A161*
180/ 144/ 112	170/ 140/ 109	165/ 134/ 106	158/ 120/ 100	150/ 122/ 90	140/ 117/ 76	130/ 87/ 58	110/ 72	90	—	180	115	60	3	1360/ 1100/ 830	1.95	B47120
190	173	142	110	70	22	—	—	—	—	212	115	60	1	2500	1.25	A212
230	212	191	175	130	27	—	—	—	—	265	115	60	1	1650	1.86	B45227
230	212	191	175	130	27	—	—	—	—	265	230	50/60	1	1650	.93	B45227-2

* Ball Bearing See page 81 for High Static Pressure Blowers.