

50756-D500, 50756-D230

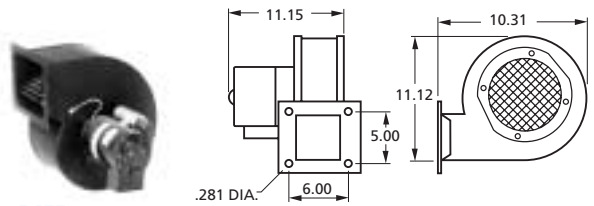

A455

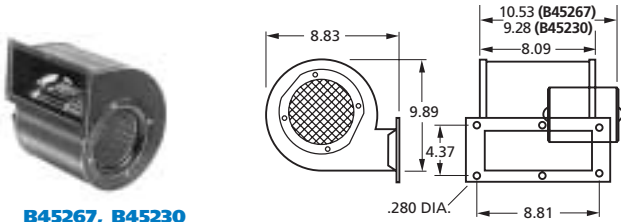

B45267, B45230

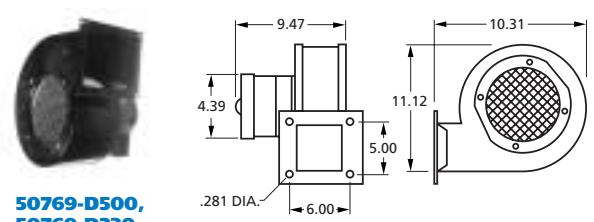

50769-D500, 50769-D230

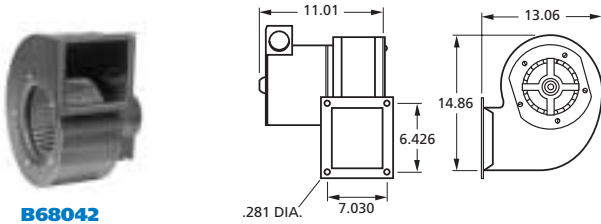

B68042

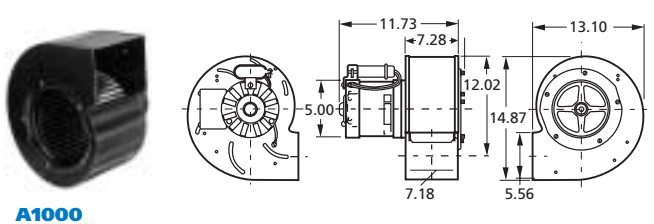

A1000

CFM at Static Pressure Shown										Nameplate CFM	Volts	Freq.	No. of Speeds	RPM@ Free Air	Amps@ Free Air	MODEL
Static Pressure (inches of water)																
0.1	0.2	0.3	0.4	0.5	0.6	0.7	0.8	0.9	1							
245	225	200	160	—	—	—	—	—	—	320	115	60	1	1500	1.3	50756-D500
245	225	200	160	—	—	—	—	—	—	320	230	50/60	1	1500	.65	50756-D230
440/ 318	417/ 307	390/ 290	375/ 275	350/ 250	319/ 228	275/ 170	231/ 108	150/ 75	68/ 40	455	115	60	2	1500/ 1100	1.5	A455
393/ 356	359/ 331	318/ 297	254/ 240	187/ 167	64/58	—	—	—	—	460	115	60	2	1600/ 1400	2.9	B45267
393/ 356	359/ 331	318/ 297	254/ 240	187/ 167	64/58	—	—	—	—	460	208-230	50/60	2	1600/ 1400	1.2	B45230
391/ 331	370/ 315	349/ 280	318/ 273	292/ 241	250/ 203	204/ 138	91/70	47/40	—	480	115	60	2	1200/ 1400	3.55	50769-D500
391/ 331	370/ 315	349/ 280	318/ 273	292/ 241	250/ 203	204/ 138	91/70	47/40	—	480	208-230	50/60	2	1200/ 1400	1.9	50769-D230
694	674	652	585	557	483	127	51	—	—	815	115	60	1	1100	5.6	B68042
950/-	920/-	880/-	850/ 799	800/ 750	730/ 700	660/ 640	580/ 500	300/ 260	120/ 120	1000	115/230	60	2	1100/ 1100	4-2.9/ 2-1.4	A1000

+ 2 speed

See page 81 for High Static Pressure Blowers.