

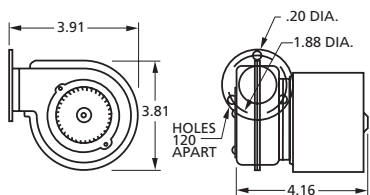

50745-D500

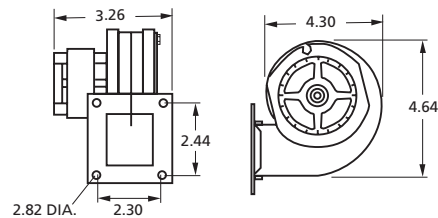

A167



B30

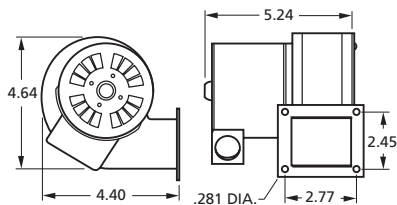

**50747-D500, 50747-D600,
50747-D230**

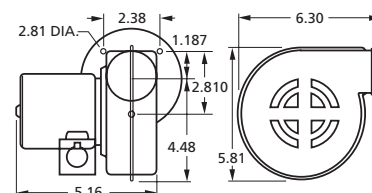

50747-D401

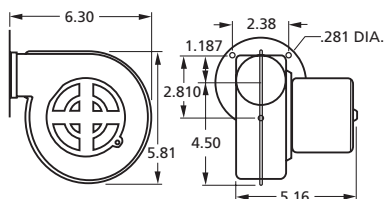

**50748-D500,
50748-D700**

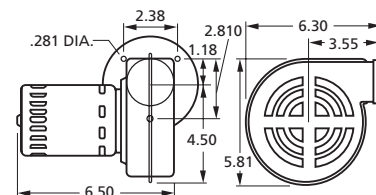

A063

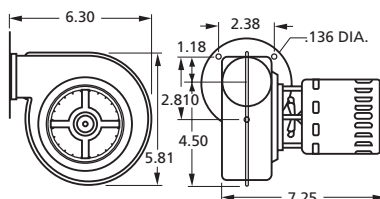

CFM at Static Pressure Shown Static Pressure (inches of water)										Nameplate CFM	Volts	Freq.	No. of Speeds	RPM@ Free Air	Amps@ Free Air	MODEL
0.1	0.2	0.3	0.4	0.5	0.6	0.7	0.8	0.9	1							
6.5	—	—	—	—	—	—	—	—	—	15	115	60	1	3100	.21	50745-D500
30	27	25	5	—	—	—	—	—	—	30	115	60	1	2900	.4	A167
40	37	32	22	6	—	—	—	—	—	45	115	60	1	3200	.59	B30
47	42	37	33	21	7	—	—	—	—	60	115	60	1	3200	.52	50747-D500
47	42	37	33	21	7	—	—	—	—	60	115	60	1	3200	.52	50747-D600
47	42	37	33	21	7	—	—	—	—	60	208-230	50/60	1	3200	.26	50747-D230
47	42	37	33	21	7	—	—	—	—	60	115	50/60	1	3200	.49	50747-D401
64	60	56	52	47	42	37	—	—	—	65	115	60	1	2900	.81	50748-D500
64	60	56	52	47	42	37	—	—	—	65	115	60	1	2900	.74	50748-D700
69	65	62	57	52	46	37	30	—	—	65	230	60	1	3100	.6	A063*

* Ball Bearing

See page 81 for High Static Pressure Blowers.

CENTRIFUGAL BLOWERS



69-75 Free Air Output

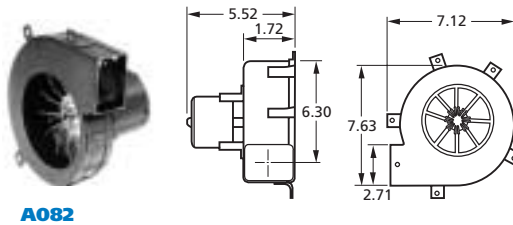
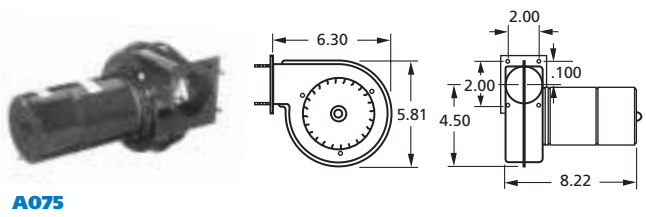
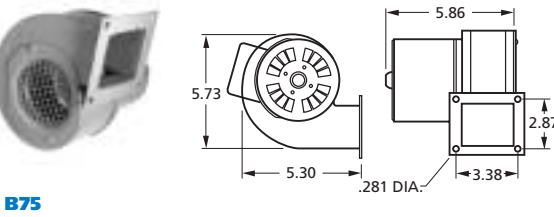
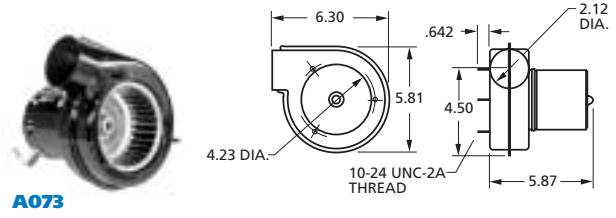
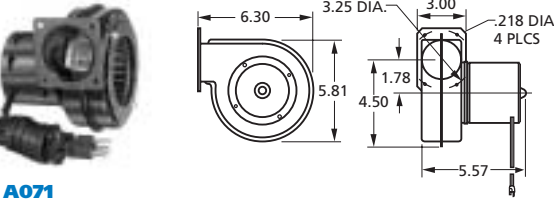
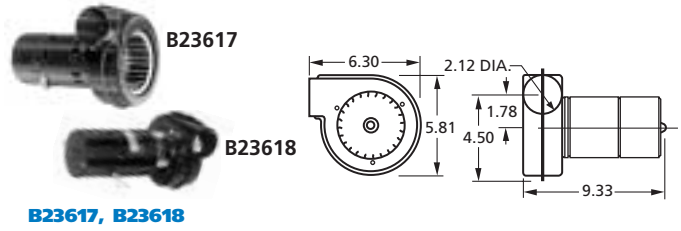
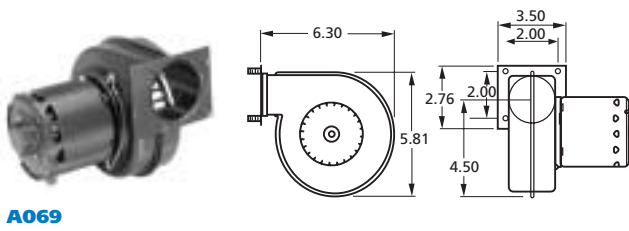

CFM at Static Pressure Shown Static Pressure (inches of water)										Nameplate CFM	Volts	Freq	No. of Speeds	RPM@ Free Air	Amps@ Free Air	MODEL
0.1	0.2	0.3	0.4	0.5	0.6	0.7	0.8	0.9	1							
72	67	63	60	53	52	50	43	40	—	69	208-230	60	1	3000	.45	A069
72	67	64	62	57	55	50	46	41	33	70	115/230	60	1	3100	.9/.45	B23617
72	67	64	62	57	55	50	46	41	33	70	115/208-230	60	1	3100	.9/.45	B23618*
70	67	63	58	57	55	51	35	—	—	71	115	60	1	2850	.7	A071
72	69	67	63	61	57	53	48	43	37	73	115/230	60	1	3200	.82/.48	A073*
68	63	57	47	34	14	—	—	—	—	75	115	60	1	3000	.59	B75
73	69	65	62	58	55	50	45	40	35	75	230	60	1	3200	.4	A075*
66	62	53	52	47	42	23	—	—	—	75	115	60	1	2800	.95	A082

• Ball Bearing

See page 81 for High Static Pressure Blowers.

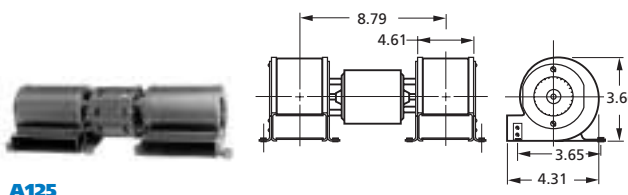
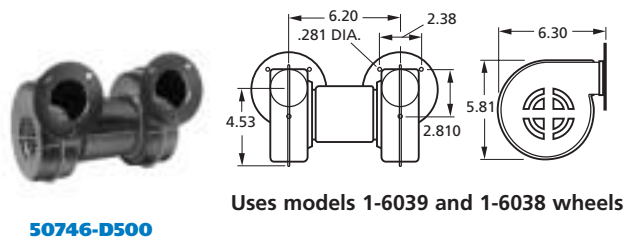
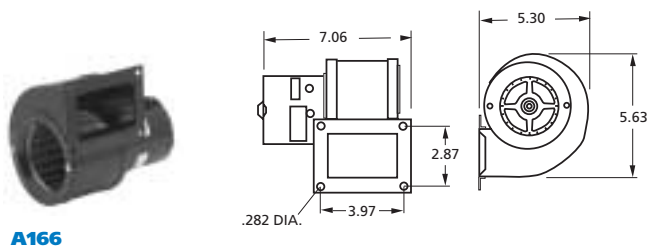
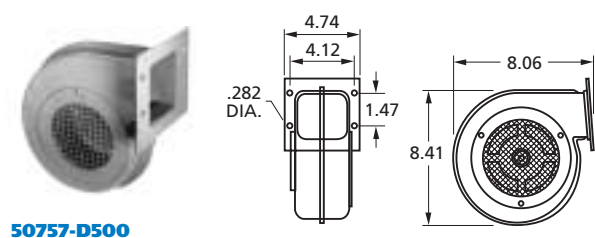
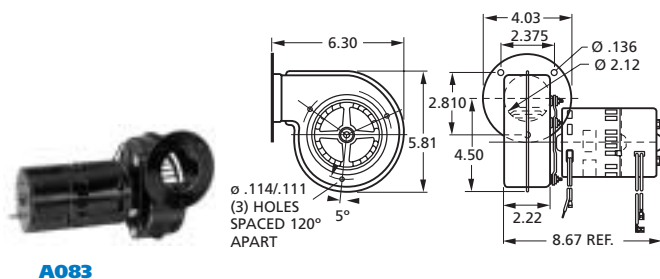
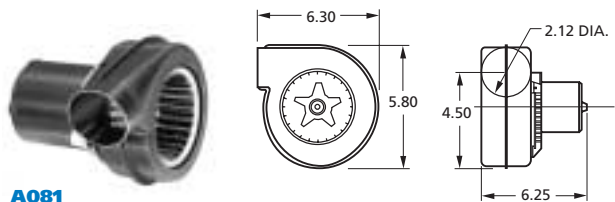

CFM at Static Pressure Shown Static Pressure (inches of water)										Nameplate CFM	Volts	Freq.	No. of Speeds	RPM@ Free Air	Amps@ Free Air	MODEL
0.1	0.2	0.3	0.4	0.5	0.6	0.7	0.8	0.9	1							
70	67	64	62	57	53	48	42	—	—	80	230	60	1	3100	.45	A081*
71	68	66	63	59	54	47	43	37	—	83	230	60	1	3000	.8	A083*
80	63	45	—	—	—	—	—	—	—	105	115	60	1	1560	.55	50757-D500
110	100	95	85	82	60	40	10	—	—	115	115	50/60	1	3200	1.4	A166
94	87	77	67	48	18	—	—	—	—	120	115	60	1	3100	.72	50746-D500
110	92	71	—	—	—	—	—	—	—	125	115	60	1	3200	1.1	A125

* Ball Bearing

See page 81 for High Static Pressure Blowers.

CENTRIFUGAL BLOWERS



135 to 265 Free Air Output



**50752-D500,
50752-D230**

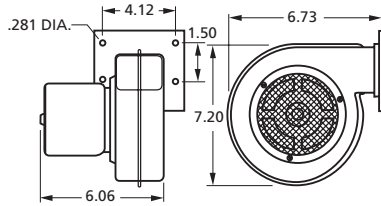

Uses model 1-6042 wheel



A159

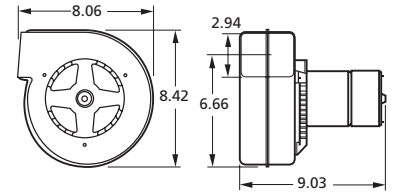

Uses model 1-6053 wheel



**50755-D500,
50755-D230**

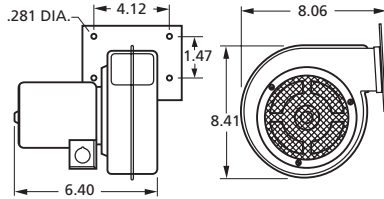

Uses model 1-6054 wheel



A161

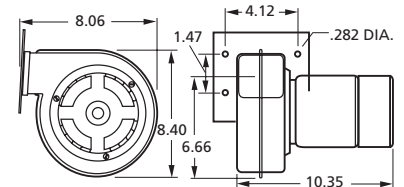

Uses model 1-6053 wheel



B47120

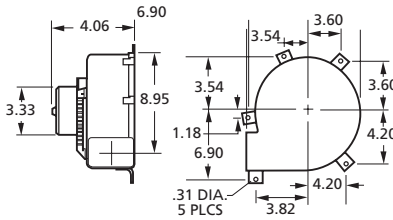

Uses model 1-6066 wheel



A212

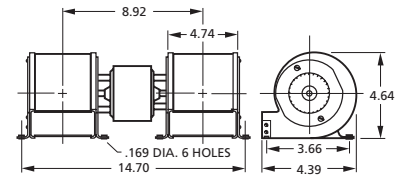

B45227, B45227-2

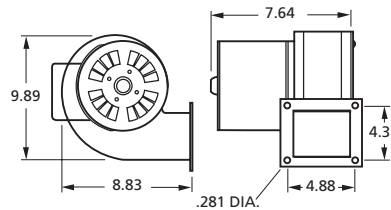

CFM at Static Pressure Shown Static Pressure (inches of water)										Nameplate CFM	Volts	Freq.	No. of Speeds	RPM@ Free Air	Amps@ Free Air	MODEL
0.1	0.2	0.3	0.4	0.5	0.6	0.7	0.8	0.9	1							
108	105	97	93	90	83	77	65	32	—	135	115	60	11	3100	1.1	50752-D500
108	105	97	93	90	83	77	65	32	—	135	208-230	50/60	1	3100	.67	50752-D230
140	138	118	105	—	—	—	—	—	—	159	230	60	1	1600	.45	A159*
140	128	118	105	—	—	—	—	—	—	160	115	60	1	1600	1	50755-D500
140	128	118	105	—	—	—	—	—	—	160	208-230	50/60	1	1600	.51	50755-D230
140	138	118	105	—	—	—	—	—	—	161	230	60	1	1600	.55	A161*
180/ 144/ 112	170/ 140/ 109	165/ 134/ 106	158/ 120/ 100	150/ 122/ 90	140/ 117/ 76	130/ 87/ 58	110/ 72	90	—	180	115	60	3	1360/ 1100/ 830	1.95	B47120
190	173	142	110	70	22	—	—	—	—	212	115	60	1	2500	1.25	A212
230	212	191	175	130	27	—	—	—	—	265	115	60	1	1650	1.86	B45227
230	212	191	175	130	27	—	—	—	—	265	230	50/60	1	1650	.93	B45227-2

* Ball Bearing

See page 81 for High Static Pressure Blowers.

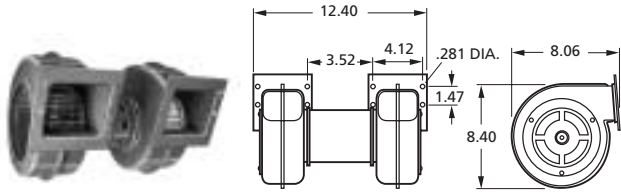

50756-D500, 50756-D230

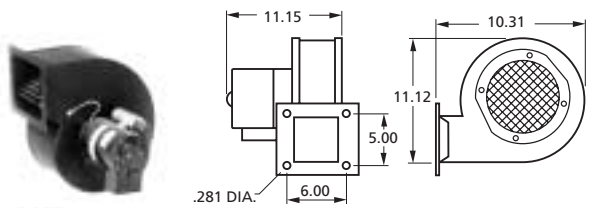

A455

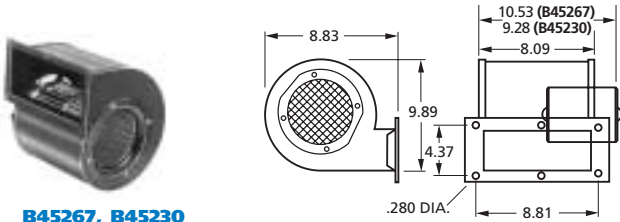

B45267, B45230

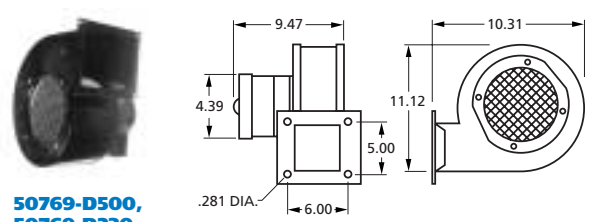

50769-D500, 50769-D230

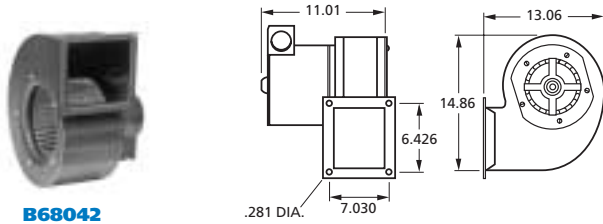

B68042

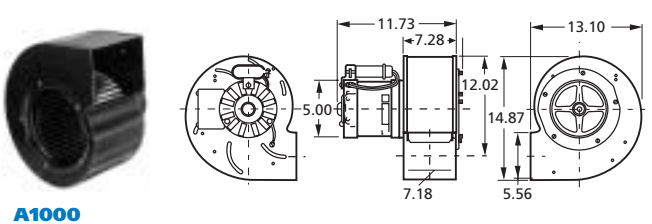

A1000

CFM at Static Pressure Shown										Nameplate CFM	Volts	Freq.	No. of Speeds	RPM@ Free Air	Amps@ Free Air	MODEL
Static Pressure (inches of water)																
0.1	0.2	0.3	0.4	0.5	0.6	0.7	0.8	0.9	1							
245	225	200	160	—	—	—	—	—	—	320	115	60	1	1500	1.3	50756-D500
245	225	200	160	—	—	—	—	—	—	320	230	50/60	1	1500	.65	50756-D230
440/ 318	417/ 307	390/ 290	375/ 275	350/ 250	319/ 228	275/ 170	231/ 108	150/ 75	68/ 40	455	115	60	2	1500/ 1100	1.5	A455
393/ 356	359/ 331	318/ 297	254/ 240	187/ 167	64/58	—	—	—	—	460	115	60	2	1600/ 1400	2.9	B45267
393/ 356	359/ 331	318/ 297	254/ 240	187/ 167	64/58	—	—	—	—	460	208-230	50/60	2	1600/ 1400	1.2	B45230
391/ 331	370/ 315	349/ 280	318/ 273	292/ 241	250/ 203	204/ 138	91/70	47/40	—	480	115	60	2	1200/ 1400	3.55	50769-D500
391/ 331	370/ 315	349/ 280	318/ 273	292/ 241	250/ 203	204/ 138	91/70	47/40	—	480	208-230	50/60	2	1200/ 1400	1.9	50769-D230
694	674	652	585	557	483	127	51	—	—	815	115	60	1	1100	5.6	B68042
950/-	920/-	880/-	850/ 799	800/ 750	730/ 700	660/ 640	580/ 500	300/ 260	120/ 120	1000	115/230	60	2	1100/ 1100	4-2.9/ 2-1.4	A1000

+ 2 speed

See page 81 for High Static Pressure Blowers.

CENTRIFUGAL BLOWERS



64 to 1200 Free Air Output



A064

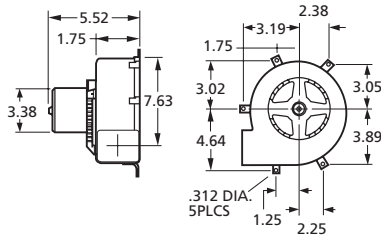

A079

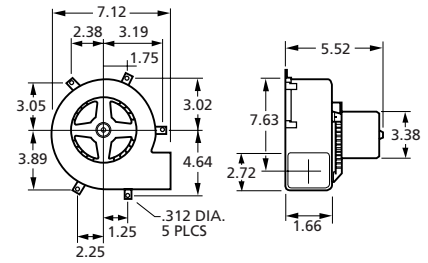

A080

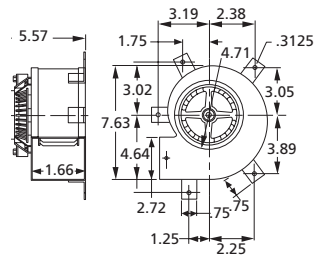

A090

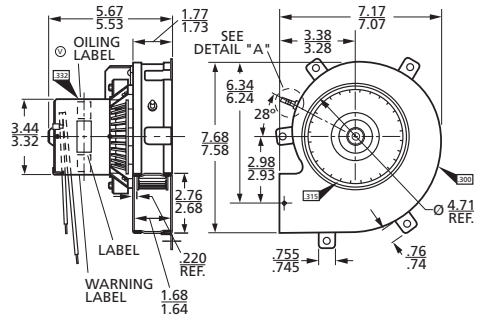

A118

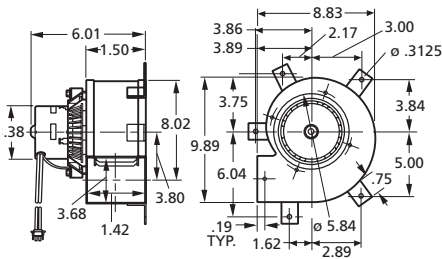

B24220

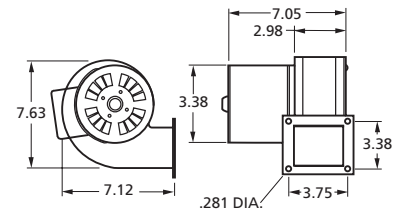

A1200

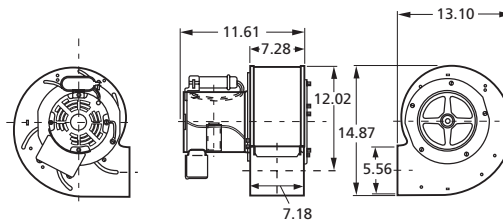

CFM at Static Pressure Shown Static Pressure (inches of water)													Nameplate CFM	Volts	Freq.	No. of Speeds	RPM@ Free Air	Amps@ Free Air	MODEL
0.2	0.4	0.6	0.8	1	1.2	1.4	1.6	1.8	2	2.2	2.4	2.6							
—	66	65	64	58	48	25	—	—	—	—	—	—	64	115	60	1	2400	.65	A064
78	75	72	68	63	60	47	—	—	—	—	—	—	80	115	60	1	2100	1.1	A080
85	81	77	73	65	51	22	—	—	—	—	—	—	89	115	60	1	2200	1.1	A079
86	84	78	73	66	57	24	—	—	—	—	—	—	90	115	60	1	2300	1.1	A090
112	110	106	102	97	90	83	73	60	39	22	18	10	118	115	60	1	2600	1.8	A118
—	140	130	120	110	45	22	—	—	—	—	—	—	135	115	50/60	1	2600	1.3	B24220
1260/ 1065	1240/ 1060	1200/ 1050	1150/ 1000	1075/ 950	1000/ 900	925/ 800	800/ 675	200/ 200	—	—	—	—	1200	115/ 230	60	2	1500/ 1400	8-6.8/ 4-3.4	A1200