

**A/B-C-D • CAST IRON SHEAVES**



**LEESON offers a comprehensive line of A/B-C-D pulleys for "Quick Detachable" (QD) taper bushings.**

Also referred to as classical V-Belt sheaves each item is made under ISO quality assurance systems.

**Features:**

GG25 high performance cast iron

Precision CNC machining

Precision balancing to 06.3

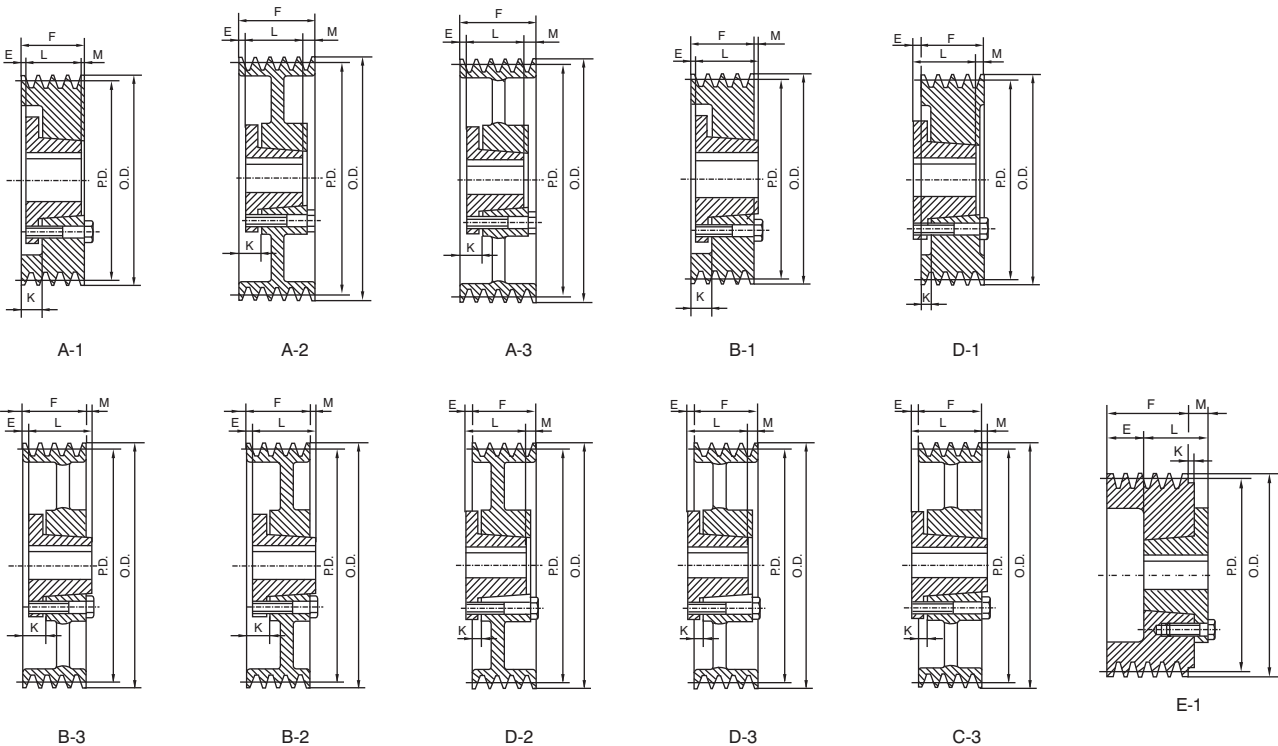

**NOMENCLATURE FOR TAPER-LOCK SHEAVES FOR STANDARD NARROW V BELT**

**2 B 34 SH**

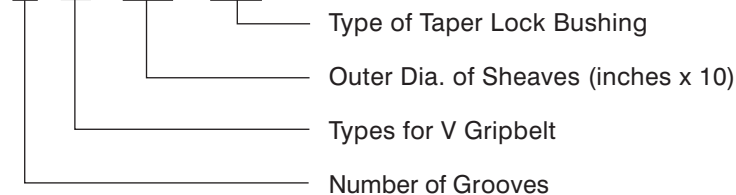

A/B-C-D

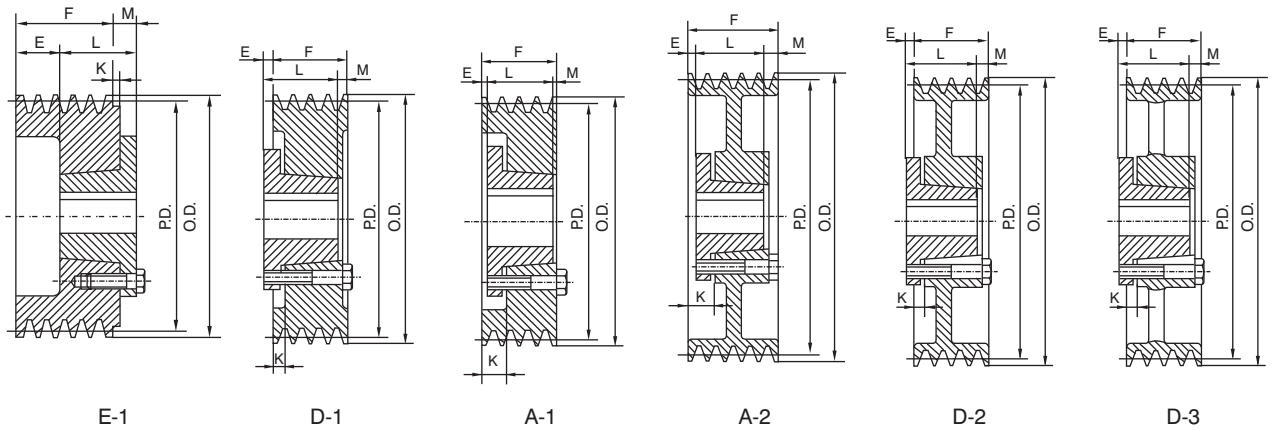

## A/B-2

**F = 1 3/4" (44.45mm)**

Part No.	P.D.		O.D.	Bush	Type	Bush Max. Bore	E	K	L	M	Wgt. Less Bush
	A Belt	B Belt									
2 B 34 SH	3.00	3.40	3.75	SH	E 1	1 11/16	1	—	15/16	9/16	1.0
2 B 36 SH	3.20	3.60	3.95	SH	D 1	1 11/16	3/8	3/16	15/16	13/16	1.4
2 B 38 SH	3.40	3.80	4.15	SH	D 1	1 11/16	3/8	3/16	15/16	13/16	1.8
2 B 40 SH	3.60	4.00	4.35	SH	A 1	1 11/16	1/8	11/16	15/16	5/16	2.0
2 B 42 SH	3.80	4.20	4.55	SH	A 1	1 11/16	1/8	11/16	15/16	5/16	2.5
2 B 44 SH	4.00	4.40	4.75	SH	A 1	1 11/16	1/8	11/16	15/16	5/16	2.8
2 B 46 SDS	4.20	4.60	4.95	SDS	A 1	2	1/16	11/16	13/8	5/16	4.8
2 B 48 SDS	4.40	4.80	5.15	SDS	A 1	2	1/16	11/16	13/8	5/16	5.0
2 B 50 SDS	4.60	5.00	5.35	SDS	A 1	2	1/16	11/16	13/8	5/16	5.4
2 B 52 SDS	4.80	5.20	5.55	SDS	A 1	2	1/16	11/16	13/8	5/16	5.6
2 B 54 SDS	5.00	5.40	5.75	SDS	A 1	2	1/16	11/16	13/8	5/16	5.8
2 B 56 SDS	5.20	5.60	5.95	SDS	A 2	2	1/16	11/16	13/8	5/16	6.0
2 B 58 SDS	5.40	5.80	6.15	SDS	A 2	2	1/16	11/16	13/8	5/16	7.0
2 B 60 SDS	5.60	6.00	6.35	SDS	A 2	2	1/16	11/16	13/8	5/16	7.5
2 B 62 SDS	5.80	6.20	6.55	SDS	A 2	2	1/16	11/16	13/8	5/16	7.8
2 B 64 SDS	6.00	6.40	6.75	SDS	A 2	2	1/16	11/16	13/8	5/16	8.0
2 B 66 SDS	6.20	6.60	6.95	SDS	A 2	2	1/16	11/16	13/8	5/16	9.0
2 B 68 SDS	6.40	6.80	7.15	SDS	A 2	2	1/16	11/16	13/8	5/16	9.5
2 B 70 SK	6.60	7.00	7.35	SK	D 2	25/8	1/4	7/16	115/16	1/16	9.8
2 B 74 SK	7.00	7.40	7.75	SK	D 2	25/8	1/4	7/16	115/16	1/16	11.0
2 B 80 SK	7.60	8.00	8.35	SK	D 2	25/8	1/4	7/16	115/16	1/16	12.0
2 B 86 SK	8.20	8.60	8.95	SK	D 3	25/8	1/4	7/16	115/16	1/16	13.0
2 B 94 SK	9.00	9.40	9.75	SK	D 3	25/8	1/4	7/16	115/16	1/16	14.0
2 B 110 SK	10.60	11.00	11.35	SK	D 3	25/8	1/4	7/16	115/16	1/16	15.0
2 B 124 SK	12.00	12.40	12.75	SK	D 3	25/8	1/4	7/16	115/16	1/16	17.0
2 B 136 SK	13.20	13.60	13.95	SK	D 3	25/8	1/4	7/16	115/16	1/16	19.0
2 B 154 SK	15.00	15.40	15.75	SK	D 3	25/8	1/4	7/16	115/16	1/16	22.0
2 B 160 SK	15.60	16.00	16.35	SK	D 3	25/8	1/4	7/16	115/16	1/16	25.0
2 B 184 SK	18.00	18.40	18.75	SK	D 3	25/8	1/4	7/16	115/16	1/16	30.0
2 B 200 SF	19.60	20.00	20.35	SF	D 3	2 15/16	5/16	3/8	2 1/16	—	39.0
2 B 250 SF	24.60	25.00	25.35	SF	D 3	2 15/16	5/16	3/8	2 1/16	—	61.0
2 B 300 SF	29.60	30.00	30.35	SF	D 3	2 15/16	5/16	3/8	2 1/16	—	64.0
2 B 380 SF	37.60	38.00	38.35	SF	D 3	2 15/16	5/16	3/8	2 1/16	—	86.0

A/B-C-D