

A/B-C-D • CAST IRON SHEAVES



LEESON offers a comprehensive line of A/B-C-D pulleys for "Quick Detachable" (QD) taper bushings.

Also referred to as classical V-Belt sheaves each item is made under ISO quality assurance systems.

Features:

GG25 high performance cast iron

Precision CNC machining

Precision balancing to 06.3

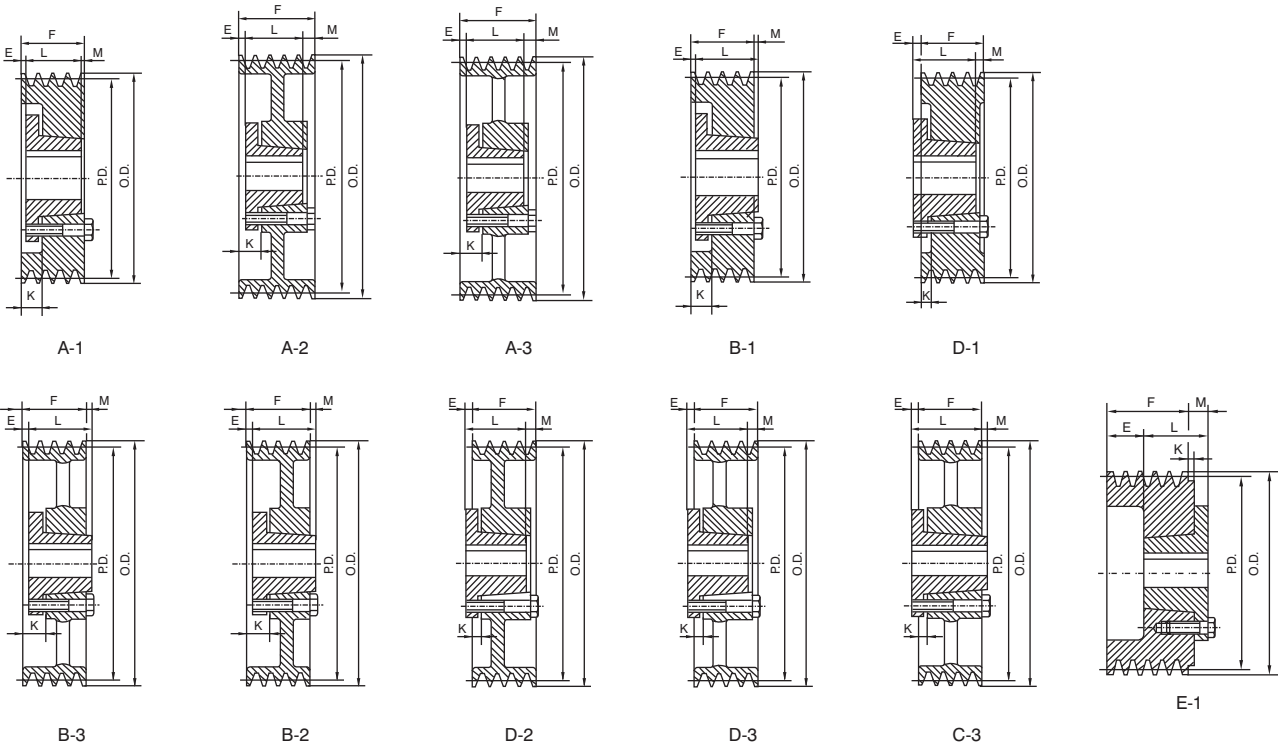

NOMENCLATURE FOR TAPER-LOCK SHEAVES FOR STANDARD NARROW V BELT

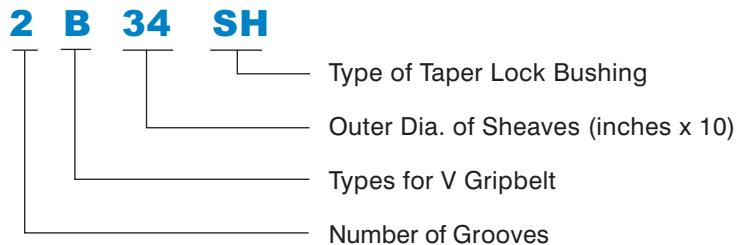

A/B-C-D

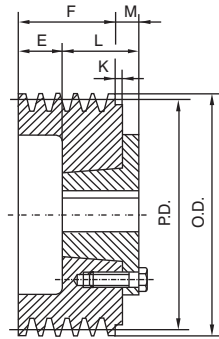

E-1

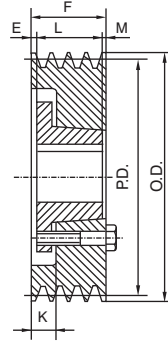

A-1

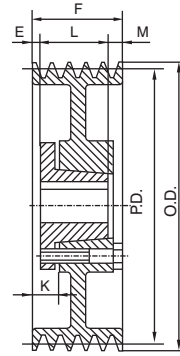

A-2

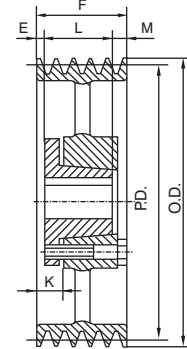

A-3

A/B-6

F=4 3/4" (120.65mm)

Part No.	P.D.		O.D.	Bush	Type	Bush Max. Bore	E	K	L	M	Wgt. Less Bush
	A Belt	B Belt									
6 B 34 SD	3.00	3.40	3.75	SD	E1	2	37/8	5/16	113/16	15/16	6.0
6 B 36 SD	3.20	3.60	3.95	SD	E1	2	37/8	5/16	113/16	13/16	7.0
6 B 38 SD	3.40	3.80	4.15	SD	E1	2	37/8	5/16	113/16	13/16	7.5
6 B 40 SD	3.60	4.00	4.35	SD	E1	2	39/16	—	113/16	5/8	8.0
6 B 42 SD	3.80	4.20	4.55	SD	E1	2	39/16	—	113/16	5/8	9.0
6 B 44 SD	4.00	4.40	4.75	SD	E1	2	39/16	—	113/16	5/8	9.5
6 B 46 SD	4.20	4.60	4.95	SD	A1	2	9/16	13/16	113/16	23/8	10.0
6 B 48 SD	4.40	4.80	5.15	SD	A1	2	21/4	13/16	113/16	23/8	10.5
6 B 50 SD	4.60	5.00	5.35	SD	A1	2	21/4	13/16	113/16	23/8	11.0
6 B 52 SD	4.80	5.20	5.55	SD	A1	2	21/4	13/16	113/16	23/8	11.5
6 B 54 SK	5.00	5.40	5.75	SK	A1	25/8	5/8	15/16	115/16	23/16	12.0
6 B 56 SK	5.20	5.60	5.95	SK	A1	25/8	5/8	15/16	115/16	23/16	13.0
6 B 58 SK	5.40	5.80	6.15	SK	A1	25/8	5/8	15/16	115/16	23/16	14.0
6 B 60 SK	5.60	6.00	6.35	SK	A1	25/8	5/8	15/16	115/16	23/16	15.0
6 B 62 SK	5.80	6.20	6.55	SK	A1	25/8	5/8	15/16	115/16	23/16	16.0
6 B 64 SK	6.00	6.40	6.75	SK	A1	25/8	5/8	15/16	115/16	23/16	17.0
6 B 66 SK	6.20	6.60	6.95	SK	A1	25/8	5/8	15/16	115/16	23/16	18.0
6 B 68 SK	6.40	6.80	7.15	SK	A1	25/8	5/8	15/16	115/16	23/16	19.0
6 B 70 SF	6.60	7.00	7.35	SF	A1	215/16	1	111/16	21/16	111/16	19.5
6 B 74 SF	7.00	7.40	7.75	SF	A1	215/16	1	111/16	21/16	111/16	22.0
6 B 80 SF	7.60	8.00	8.35	SF	A1	215/16	1	111/16	21/16	111/16	25.0
6 B 86 SF	8.20	8.60	8.95	SF	A2	215/16	1	111/16	21/16	111/16	28.0
6 B 94 SF	9.00	9.40	9.75	SF	A2	215/16	1	111/16	21/16	111/16	29.0
6 B 110 SF	10.60	11.00	11.35	SF	A2	215/16	1	111/16	21/16	111/16	30.0
6 B 124 SF	12.00	12.40	12.75	SF	A3	215/16	1	111/16	21/16	111/16	40.0
6 B 136 SF	13.20	13.60	13.95	SF	A3	215/16	1	111/16	21/16	111/16	45.0
6 B 154 SF	15.00	15.40	15.75	SF	A3	215/16	1	111/16	21/16	111/16	46.0
6 B 160 SF	15.60	16.00	16.35	SF	A3	215/16	1	111/16	21/16	111/16	50.0
6 B 184 SF	18.00	18.40	18.75	SF	A3	215/16	1	111/16	21/16	111/16	60.0
6 B 200 E	19.60	20.00	20.35	E	A3	31/2	1/2	13/8	25/8	15/8	78.0
6 B 250 E	24.60	25.00	25.35	E	A3	31/2	1/2	13/8	25/8	15/8	98.0
6 B 300 E	29.60	30.00	30.35	E	A3	31/2	1/2	13/8	25/8	15/8	109
6 B 380 E	37.60	38.00	38.35	E	A3	31/2	1/2	13/8	25/8	15/8	173

A/B-C-D