

A/B-C-D • CAST IRON SHEAVES



LEESON offers a comprehensive line of A/B-C-D pulleys for "Quick Detachable" (QD) taper bushings.

Also referred to as classical V-Belt sheaves each item is made under ISO quality assurance systems.

Features:

GG25 high performance cast iron

Precision CNC machining

Precision balancing to 06.3

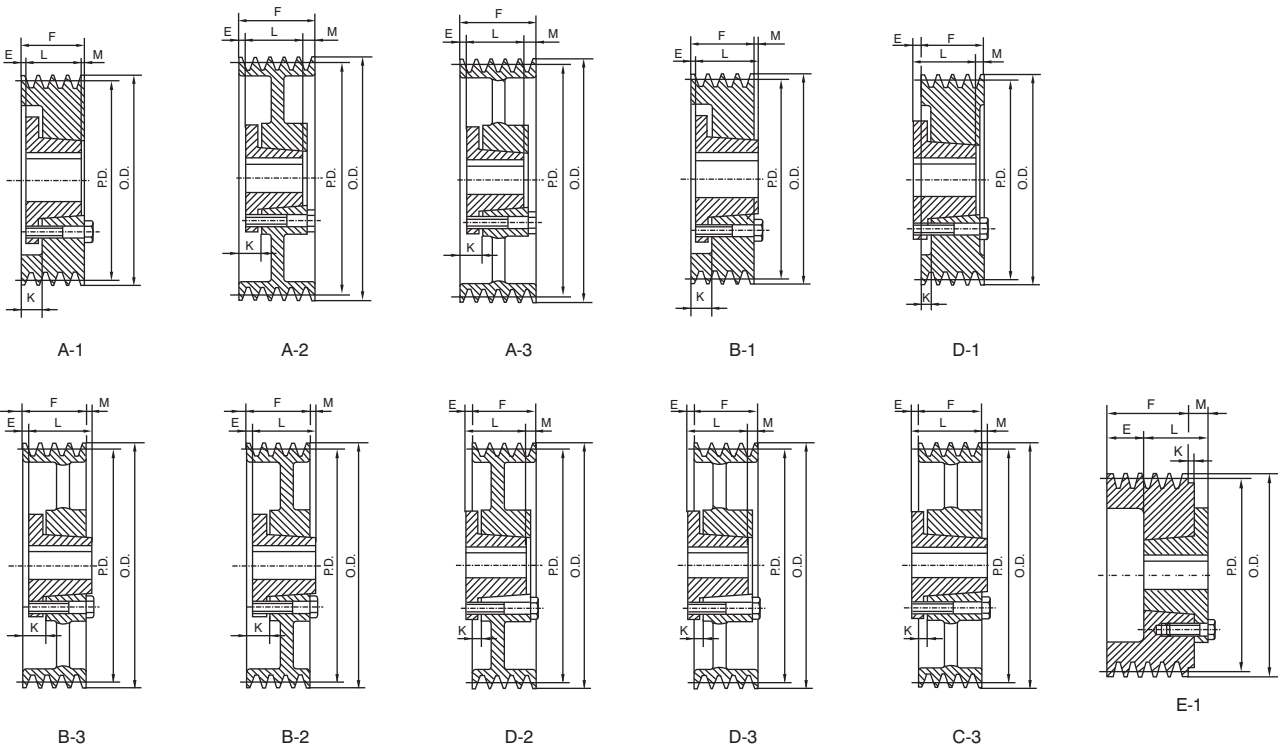

**NOMENCLATURE FOR TAPER-LOCK SHEAVES
FOR STANDARD NARROW V BELT**

2 B 34 SH

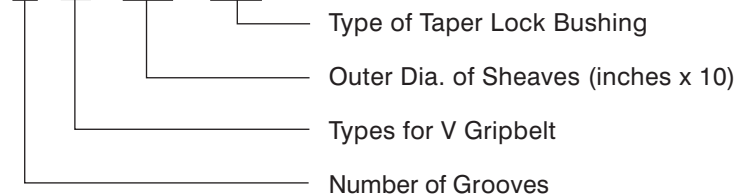

A/B-C-D

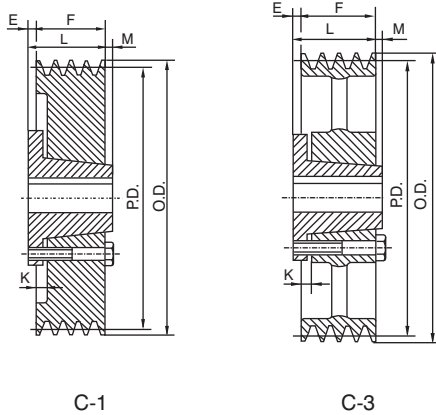

BORE RANGE FOR QTL BUSHING

Bush. Sym.	Min. Bore	Max. Bore with:		
		Full Keyway	Shallow Keyway	No Keyway
SDS	1/2	15/8	1-15/16	2
SD	1/2	15/8	1-15/16	2
SK	1/2	2-1/8	2-1/2	25/8, 29/16
SF	1/2	21/4	27/8	2-15/16
E	7/8	2-7/8	3-1/2	—
F	1	3-1/4	3-15/16	4
J	1-1/2	313/16	4-1/2	—
M	2	411/16	5/1/2	—
N	2-7/16	51/16	5-7/8	—
P	2-15/16	513/16	7	—

C-1

F = 1 3/8" (34.93mm)

Part No.	O.D.	P.D.	Bush Max Bore	Bush	Type	Db	E	K	L	M	Wgt. Less Bush
1 C 60 SK	6.40	6.00	25/8	SK	C1	—	9/16	1/8	115/16	—	9.4
1 C 70 SF	7.40	7.00	215/16	SF	C1	—	9/16	1/8	21/16	1/8	9.8
1 C 75 SF	7.90	7.50	215/16	SF	C1	—	9/16	1/8	21/16	1/8	11.0
1 C 80 SF	8.40	8.00	215/16	SF	C1	—	9/16	1/8	21/16	1/8	13.0
1 C 85 SF	8.90	8.50	215/16	SF	C1	—	9/16	1/8	21/16	1/8	13.2
1 C 90 SF	9.40	9.00	215/16	SF	C2	5	9/16	1/8	21/16	1/8	13.5
1 C 95 SF	9.90	9.50	215/16	SF	C3	5	9/16	1/8	21/16	1/8	13.8
1 C 100 SF	10.40	10.00	215/16	SF	C3	5	9/16	1/8	21/16	1/8	14.0
1 C 105 SF	10.90	10.50	215/16	SF	C3	5	9/16	1/8	21/16	1/8	15.0
1 C 110 SF	11.40	11.00	215/16	SF	C3	5	9/16	1/8	21/16	1/8	15.8
1 C 120 SF	12.40	12.00	215/16	SF	C3	5	9/16	1/8	21/16	1/8	17.0
1 C 130 SF	13.40	13.00	215/16	SF	C3	5	9/16	1/8	21/16	1/8	18.0
1 C 140 SF	14.40	14.00	215/16	SF	C3	5	9/16	1/8	21/16	1/8	20.0
1 C 150 SF	15.40	15.00	215/16	SF	C3	5	9/16	1/8	21/16	1/8	21.0
1 C 160 SF	16.40	16.00	215/16	SF	C3	5	9/16	1/8	21/16	1/8	24.0
1 C 180 SF	18.40	18.00	215/16	SF	C3	5	9/16	1/8	21/16	1/8	27.0
1 C 200 SF	20.40	20.00	215/16	SF	C3	5	9/16	1/8	21/16	1/8	31.0
1 C 240 SF	24.40	24.00	215/16	SF	C3	5	9/16	1/8	21/16	1/8	37.0

* Db = hub diameter

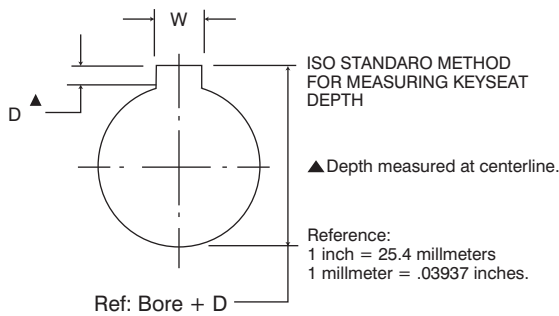

STANDARD KEYWAY & KEY DIMENSION

Bores	Key Seat	Key
1/2-9/16	1/8x1/16	1/8x1/8
5/8-7/8	3/16x3/32	3/16x3/16
15/16-11/4	1/4x1/8	1/4x1/4
15/16-13/8	5/16x5/32	5/16x5/16
17/16-13/4	3/8x3/16	3/8x3/8
113/16-21/4	1/2x1/4	1/2x1/2
25/16-23/4	5/8x5/16	5/8x5/8
213/16-31/4	3/4x3/8	3/4x3/4
35/16-33/4	7/8x7/16	7/8x7/8
313/16-41/2	1x1/2	1x1
49/16-51/2	11/4x5/8	11/4x11/4
59/16-61/2	11/2x3/4	11/2x11/2
69/16-71/2	13/4x7/8	13/4x13/4

Dimensions: inch

A/B-C-D