

A/B-C-D • CAST IRON SHEAVES



LEESON offers a comprehensive line of A/B-C-D pulleys for "Quick Detachable" (QD) taper bushings.

Also referred to as classical V-Belt sheaves each item is made under ISO quality assurance systems.

Features:

GG25 high performance cast iron

Precision CNC machining

Precision balancing to 06.3

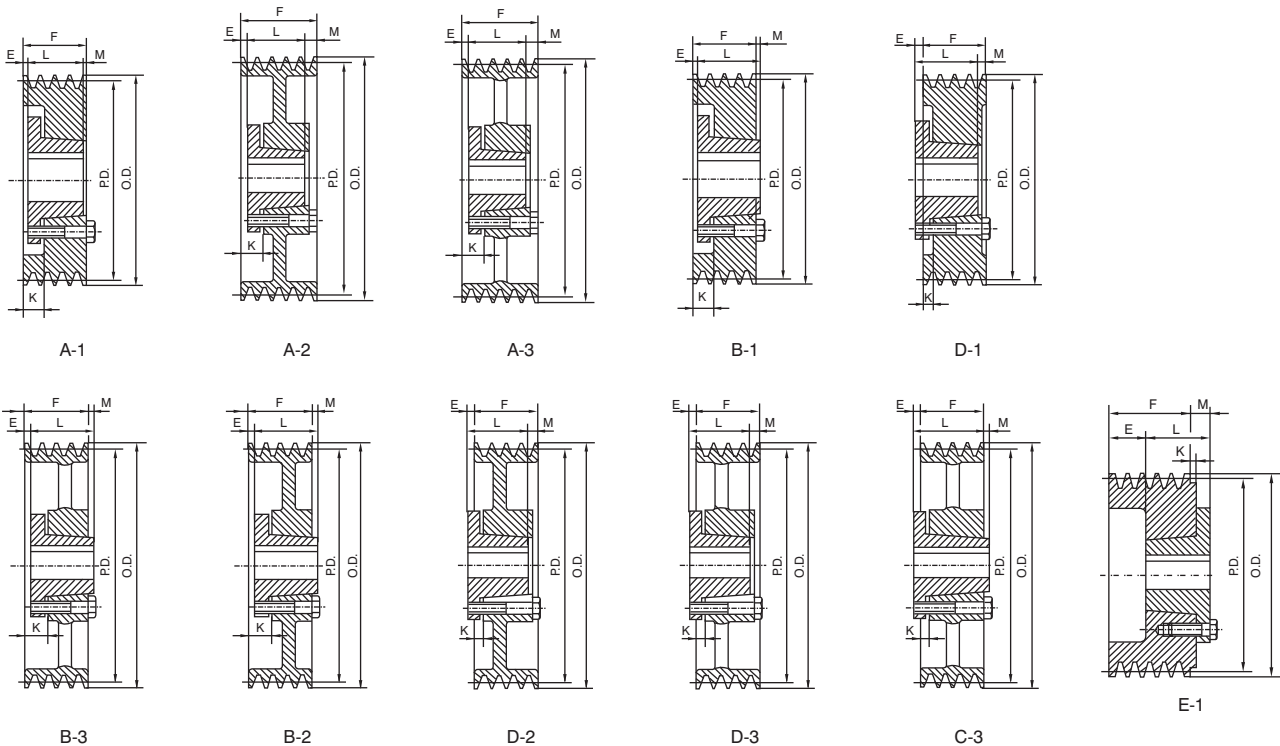

NOMENCLATURE FOR TAPER-LOCK SHEAVES FOR STANDARD NARROW V BELT

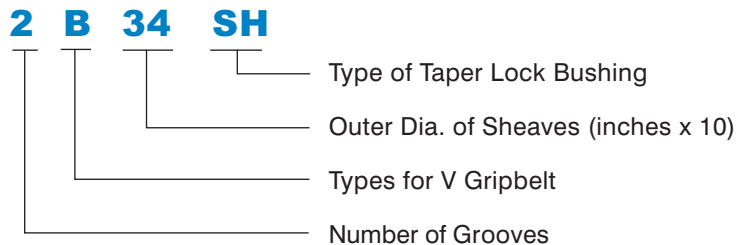

A/B-C-D

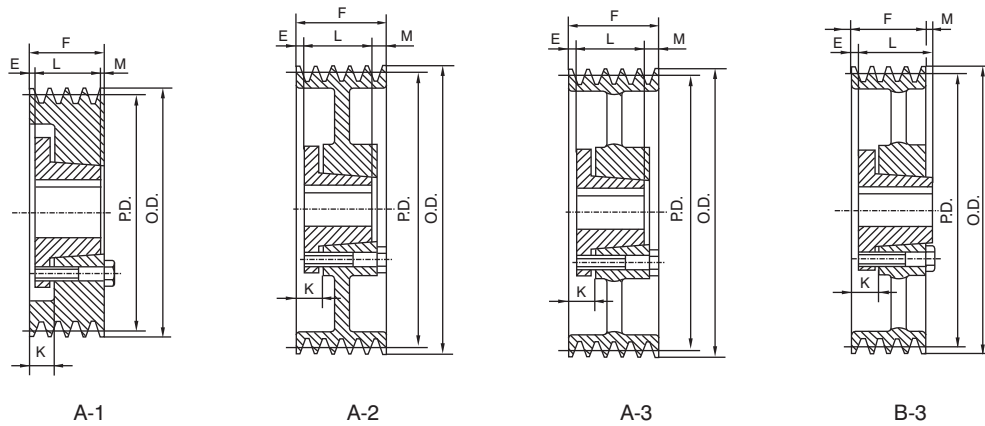

C-4

F=4 3/8"(111.13mm)

Part No.	O.D.	PD.	Bush Max Bore	Bush	Type	Db	E	K	L	M	Wgt. Less Bush
4 C 50 SD	5.40	5.00	2	SD	A1	—	5/8	1 1/4	1 13/16	1 15/16	10.0
4 C 54 SD	5.80	5.40	2	SD	A1	—	11/16	15/16	1 13/16	1 7/8	12.0
4 C 55 SD	5.90	5.50	2	SD	A1	—	11/16	15/16	1 13/16	1 7/8	12.4
4 C 56 SD	6.00	5.60	2	SD	A1	—	11/16	15/16	1 13/16	1 7/8	12.6
4 C 60 SK	6.40	6.00	2 5/8	SK	A1	—	3/16	7/8	1 15/16	2 1/8	12.8
4 C 70 SF	7.40	7.00	2 15/16	SF	A2	5	7/8	1 9/16	2 1/16	1 7/16	13.0
4 C 75 SF	7.90	7.50	2 15/16	SF	A2	5	7/8	1 9/16	2 1/16	1 7/16	19.0
4 C 80 E	8.40	8.00	3 1/2	E	A1	—	1 1/8	2	2 5/8	5/8	24.0
4 C 85 E	8.90	8.50	3 1/2	E	A1	—	1 1/8	2	2 5/8	5/8	27.0
4 C 90 E	9.40	9.00	3 1/2	E	A1	—	1 1/8	2	2 5/8	5/8	30.0
4 C 95 E	9.90	9.50	3 1/2	E	A1	—	1 1/8	2	2 5/8	5/8	33.0
4 C 100 E	10.40	10.00	3 1/2	E	A2	6 1/4	1 1/8	2	2 5/8	5/8	35.0
4 C 105 E	10.90	10.50	3 1/2	E	A2	6 1/4	1 1/8	2	2 5/8	5/8	40.0
4 C 110 E	11.40	11.00	3 1/2	E	A2	6 1/4	1 1/8	2	2 5/8	5/8	45.0
4 C 120 E	12.40	12.00	3 1/2	E	A2	6 1/4	1 1/8	2	2 5/8	5/8	48.0
4 C 130 E	13.40	13.00	3 1/2	E	A3	6 1/4	1 1/8	2	2 5/8	5/8	49.0
4 C 140 E	14.40	14.00	3 1/2	E	A3	6 1/4	1 1/8	2	2 5/8	5/8	56.0
4 C 150 E	15.40	15.00	3 1/2	E	A3	6 1/4	1 1/8	2	2 5/8	5/8	62.0
4 C 160 E	16.40	16.00	3 1/2	E	A3	6 1/4	1 1/8	2	2 5/8	5/8	68.0
4 C 180 E	18.40	18.00	3 1/2	E	A3	6 1/4	1 1/8	2	2 5/8	5/8	74.0
4 C 200 E	20.40	20.00	3 1/2	E	A3	6 1/4	5/8	1 1/2	2 5/8	1 1/8	81.0
4 C 240 F	24.40	24.00	3 15/16	F	A3	7	5/16	15/16	35/8	7/16	120
4 C 270 F	27.40	27.00	3 15/16	F	A3	7	5/16	15/16	35/8	7/16	138
4 C 300 F	30.40	30.00	3 15/16	F	A3	7	5/16	15/16	35/8	7/16	166
4 C 360 F	36.40	36.00	3 15/16	F	A3	7	5/16	15/16	35/8	7/16	176
4 C 440 J	44.40	44.00	4 1/2	J	B3	7 3/4	3/8	1 9/16	4 1/2	1/2	254
4 C 500 J	50.40	50.00	4 1/2	J	B3	7 3/4	3/8	1 9/16	4 1/2	1/2	318

A/B-C-D